

## **BAB VI**

### **KESIMPULAN**

Setelah melakukan analisis dan perancangan struktur gedung kantor di wilayah Yogyakarta yang disesuaikan dengan Tata Cara Perhitungan Struktur Beton untuk Bangunan Gedung (SNI 03-2847-2013) dapat diambil kesimpulan sebagai berikut :

1. Dalam perencanaan gedung ini digunakan pelat 2 arah dengan tebal pelat 150 mm.
2. Dalam perencanaan balok digunakan 4 dimensi balok yaitu sebesar 300 x 450 mm, 400 x 500 mm, 500 x 700 mm, 200 x 300 mm. Balok tersebut direncanakan dengan tulangan lentur dan geser yang berbeda-beda.
3. Dalam perencanaan balok digunakan 4 dimensi kolom yaitu sebesar 500 x 700 mm, 550 x 800 mm, 400 x 600 mm, 400 x 400 mm. Kolom tersebut direncanakan dengan tulangan utama dan geser yang berbeda-beda.
4. Dalam perencanaan pondasi dipakai dimensi 2,3 x 2,3 m dengan tulangan D16-150 dan P12-250. Jumlah tiang yang digunakan 24 buah dengan jenis pondasi telapak.

Pada Praktik Perancangan Bangunan Air luas daerah aliran sungai yang direncanakan adalah 19.81 km<sup>2</sup>, dengan data curah hujan daerah sebanyak 14 tahun terakhir yaitu dari tahun 1999 sampai dengan tahun 2013. Untuk debit andalan didapat 2,274 m<sup>3</sup>/d.

Berdasarkan data hasil survey, analisis, dan perhitungan mengenai ruas Jalan Kebun Raya, Rejowinangun, Kota Gede, diambil beberapa kesimpulan sebagai berikut:

1. Volume jam puncak dan kecepatan tempuh rerata
  - a. Volume jam puncak arah Rejowinangun pada pagi hari yaitu pukul 08.00-09.00 WIB dengan volume 734,7 smp dan arus kendaraan ke arah Jalan Kusumanegara tertinggi terjadi pada siang hari sekitar pukul 13.00-14.00 WIB dengan volume 510,2 smp.
  - b. Kecepatan tempuh rerata kendaraan arah Rejowinangun pada pagi hari untuk mobil penunjang 27,04 km/jam, bus 18,63 km/jam, sepeda motor 28,11

km/jam, truk 22,24 km/jam, becak 5,87 km/jam, sepeda 12,20 km/jam. Pada siang hari untuk mobil penumpang 26,32 km/jam, bus 15,71 km/jam, sepeda motor 29,92 km/jam, truk 20,26 km/jam, becak 5,87 km/jam, sepeda 12,20 km/jam. Pada sore hari untuk mobil penumpang 26,69 km/jam, bus 14,53 km/jam, sepeda motor 29,41 km/jam, truk 24,94 km/jam, becak 5,87 km/jam, sepeda 12,20 km/jam. Kecepatan tempuh rerata arah Kusumanegara pada pagi hari untuk mobil penumpang 27,04 km/jam, bus 18,63 km/jam, sepeda motor 28,11 km/jam, truk 22,24 km/jam, becak 5,87 km/jam, sepeda 12,20 km/jam. Pada siang hari untuk mobil penumpang 27,04 km/jam, bus 18,63 km/jam, sepeda motor 28,11 km/jam, truk 22,24 km/jam, becak 5,87 km/jam, sepeda 12,20 km/jam. Pada sore hari untuk mobil penumpang 27,04 km/jam, bus 18,63 km/jam, sepeda motor 28,11 km/jam, truk 22,24 km/jam, becak 5,87 km/jam, sepeda 12,20 km/jam.

2. Kondisi Perkerasan Jalan, Kondisi Lingkungan, Dan Kelengkapan Jalan
  - a. Jalan Kebun Raya termasuk jalan kelas III B yaitu jalan lokal, karena jalan tersebut terletak di daerah pemukiman yang melayani transportasi lokal yang memerlukan rute jarak pendek, kecepatan rata – rata yang rendah dan mempunyai jalan masuk dalam jumlah yang tidak terbatas.
  - b. Keadaan trotoar di Jalan Kebun Raya cukup baik dan dapat memenuhi kebutuhan pejalan kaki sehingga tidak terdapat masalah, dan berdasarkan pengamatan situasi disana masih sedikit pejalan kaki yang lewat sehingga dengan trotoar ukuran 1,28 m masih cukup untuk menampung pejalan kaki dengan baik.
3. Solusi permasalahan di Jalan Kebun Raya
  - a. Perlu dilakukan penertiban batas lahan parkir dengan menetapkan jarak minimum antara lahan parkir dengan bahu jalan. Selain itu ketersediaan fasilitas dan kelengkapan jalan juga penting diperhatikan demi keselamatan dan kenyamanan para pengguna jalan. Rambu lalu lintas yang terdapat pada Jalan Kebun Raya masih kurang lengkap di mana hanya terdapat satu jenis rambu di ruas jalan arah Rejowinangun yakni rambu parkir.
  - b. Untuk jenis kerusakan yang terjadi pada ruas Jalan Kebun Raya yaitu retak refleksi pada Sta 0+00 – 0+10, retak halus pada Sta 0+00 – 0+20, retak kulit

buaya pada Sta 0+00 – 0+30, retak sambungan pada Sta 0+00 – 0+40, retak tepi pada Sta 0+00 – 0+50, dan retak refleksi pada Sta 0+00 – 0+70 perlu diperbaiki dan ditangani dengan baik dengan cara perbaikan yang umumnya dapat dilakukan penambalan terhadap kerusakan yang terjadi kemudian dilakukan *overlay* secara keseluruhan. Pada Jalan Kebun Raya perlu ditambahkan marka lain seperti *zebra cross* di sebelah sehingga para pejalan kaki yang hendak menyebrang tidak menyebrang di sembarang tempat.

Pada Praktik Perancangan Biaya dan Waktu penulis dapat membuat rancangan anggaran biaya dengan rekapitulasi harga satuan dari Provinsi DKI Jakarta sebesar Rp 5,004,317,090, sedangkan rekapitulasi harga satuan biaya Yogyakarta sebesar Rp 3,097,890,780 biaya tersebut sudah termasuk keuntungan perusahaan dan pajak sebesar 10%. Jika dilihat dari hasil rekapitulasi pembangunan Puskesmas Plumpungan dengan luas bangunan sebesar 592 m<sup>2</sup> harga bangunan di Kota Jakarta lebih mahal dibandingkan dengan harga bangunan di Yogyakarta dengan selisih sebesar Rp 1,817,606. Selisih ini terjadi dikarenakan perbedaan harga bahan dan upah pekerja.

## DAFTAR PUSTAKA

- Badan Standarisasi Nasional (2013) “SNI 1727:2013 Beban minimum untuk perancangan bangunan gedung dan struktur lain”.
- Badan Standarisasi Nasional (2019a) “Persyaratan beton struktural untuk bangunan gedung dan penjelasan (SNI 2847:2019)”, Badan standarisasi Nasional, (8), p.695.
- Badan Standarisasi Nasional (2019b) “SNI 1726-2019”, tata cara perencanaan ketahanan gempa untuk struktur bangunan gedung dan non gedung (8), p.254.
- Badan Standarisasi Nasional (2015) “SNI 1729-2015 spesifikasi untuk baja struktural”.
- Departemen Pekerjaan Umum Direktorat Jendral Bina Marga Direktorat Bina Teknik (1995), “tata cara perencanaan fasilitas pejalan kaki di Kawasan perkotaan”, p.21.
- Direktorat jendral sumber daya air (2013b) “Standar perancangan irigasi. Kriteria perencanaan bagian parameter bangunan KP-06”, p.10.
- Direktorat jendral sumber daya air (2013c) “Standar perancangan irigasi. Kriteria perencanaan bagian parameter bangunan KP-02”, p.240.
- Direktorat jendral sumber daya air (2013a) “Standar perancangan irigasi. Kriteria perencanaan bagian parameter bangunan KP-03, standar perancangan irigasi, p.168.
- Direktorat pembinaan jalan kota (1990) “Petunjuk perencanaan trotoar”.
- MARGA, D.P.U.D.J.B (1997) “TATA CARA PERENCANAAN GEOMETRIK JALAN ANTAR KOTA no.38/btm/1997”, Jakarta, p.54.
- Mawardi, E. dan Memed, M. (2002) “Desain hidraulik bendung tetap untuk irigasi teknis”, Alfabeta, Bandung.

The logo of Universitas Atma Jaya Yogyakarta is a light blue emblem. It features a central sunburst or wheel-like design with multiple spokes radiating from a central point. This central design is enclosed within a circular border. The text "UNIVERSITAS ATMA JAYA YOGYAKARTA" is written in a light blue, sans-serif font along the top inner edge of this circular border. Below the circular part, the emblem tapers into a pointed, leaf-like shape.

UNIVERSITAS ATMA JAYA YOGYAKARTA

# LAMPIRAN

## Lampiran Bab II Praktik Perancangan Bangunan Gedung



Lampiran 2.1 Tampak Depan

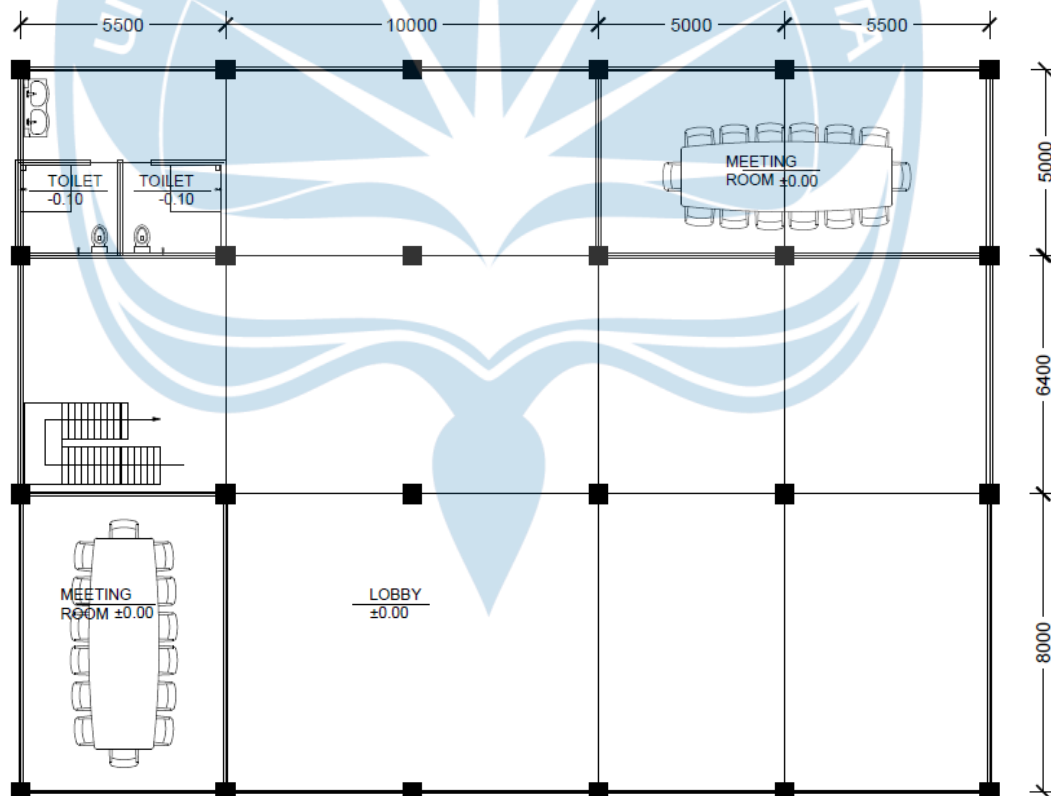

DENAH LANTAI 1

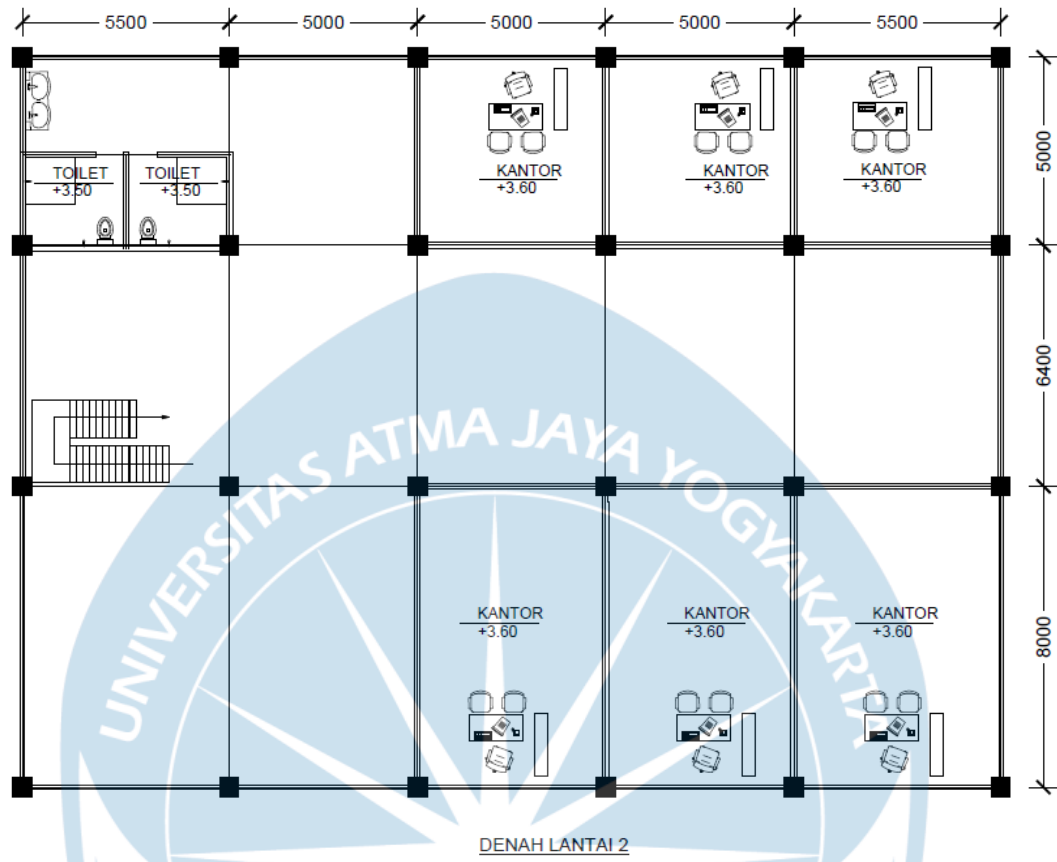

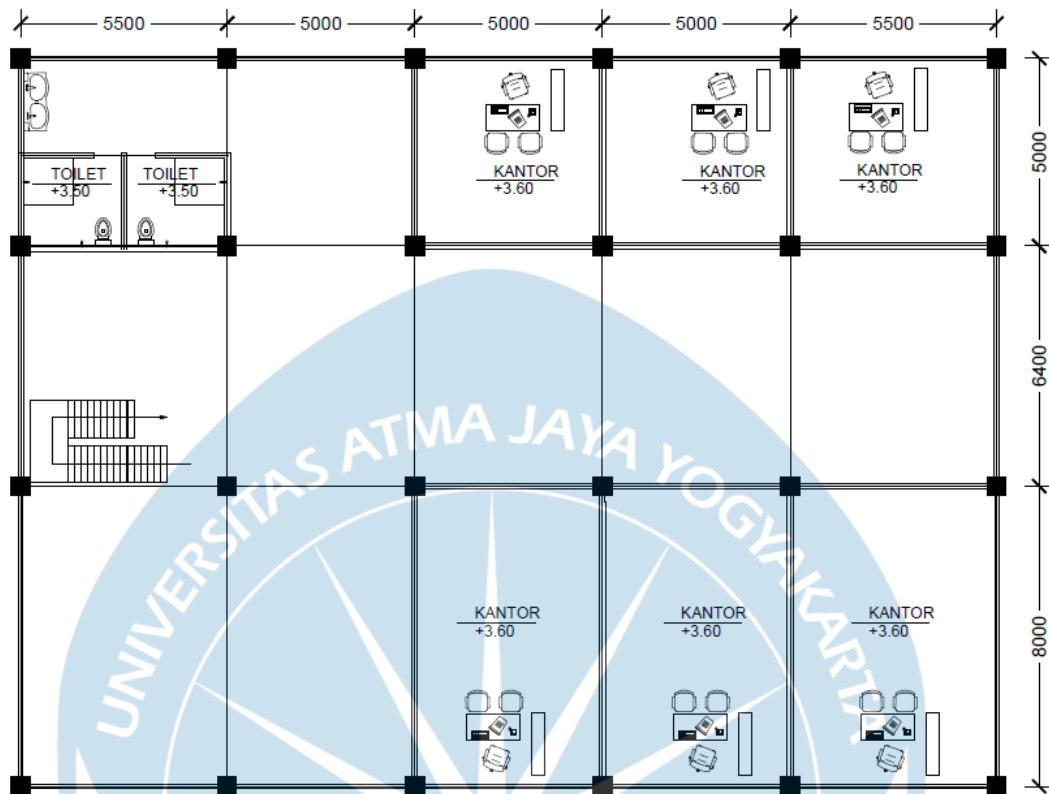

DENAH LANTAI 3

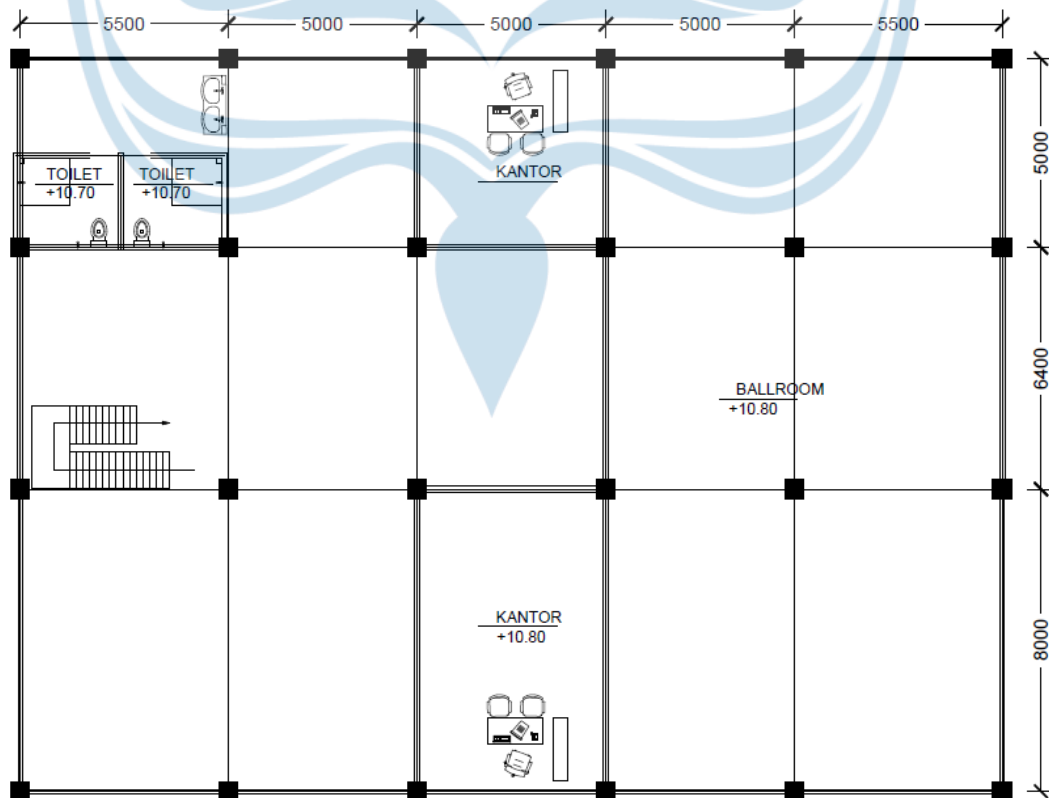

DENAH LANTAI 4



Lampiran 2.2 Denah Lantai 1-4

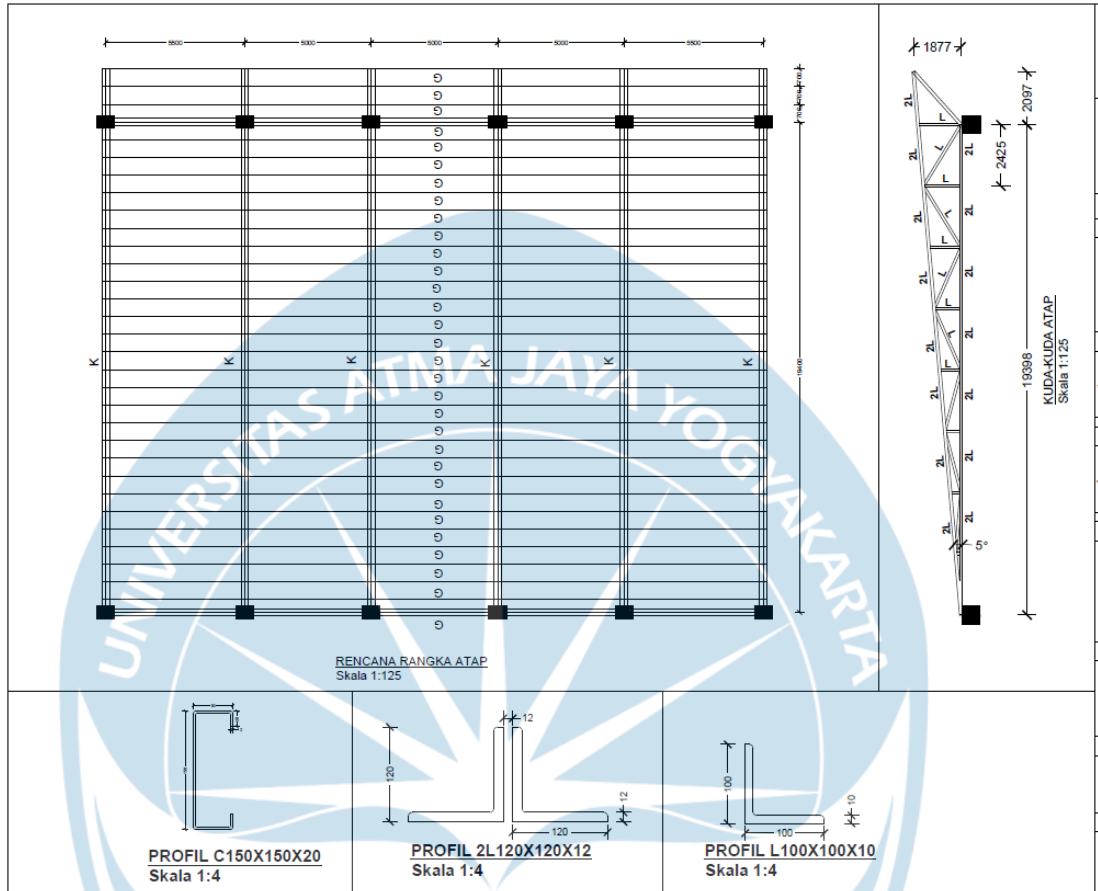

Lampiran 2.3 Gambar Atap

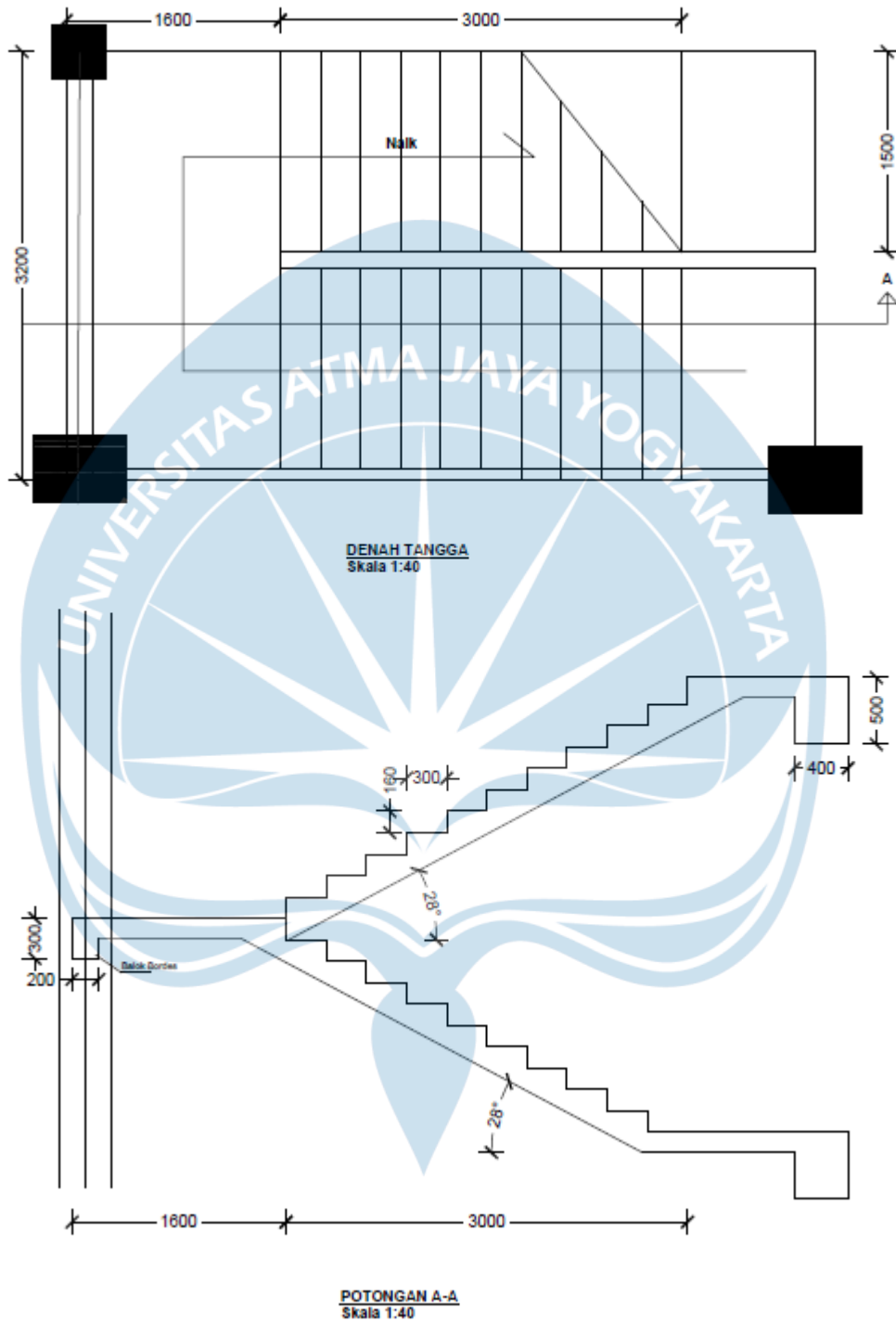

Lampiran 2.4 Denah Tangga

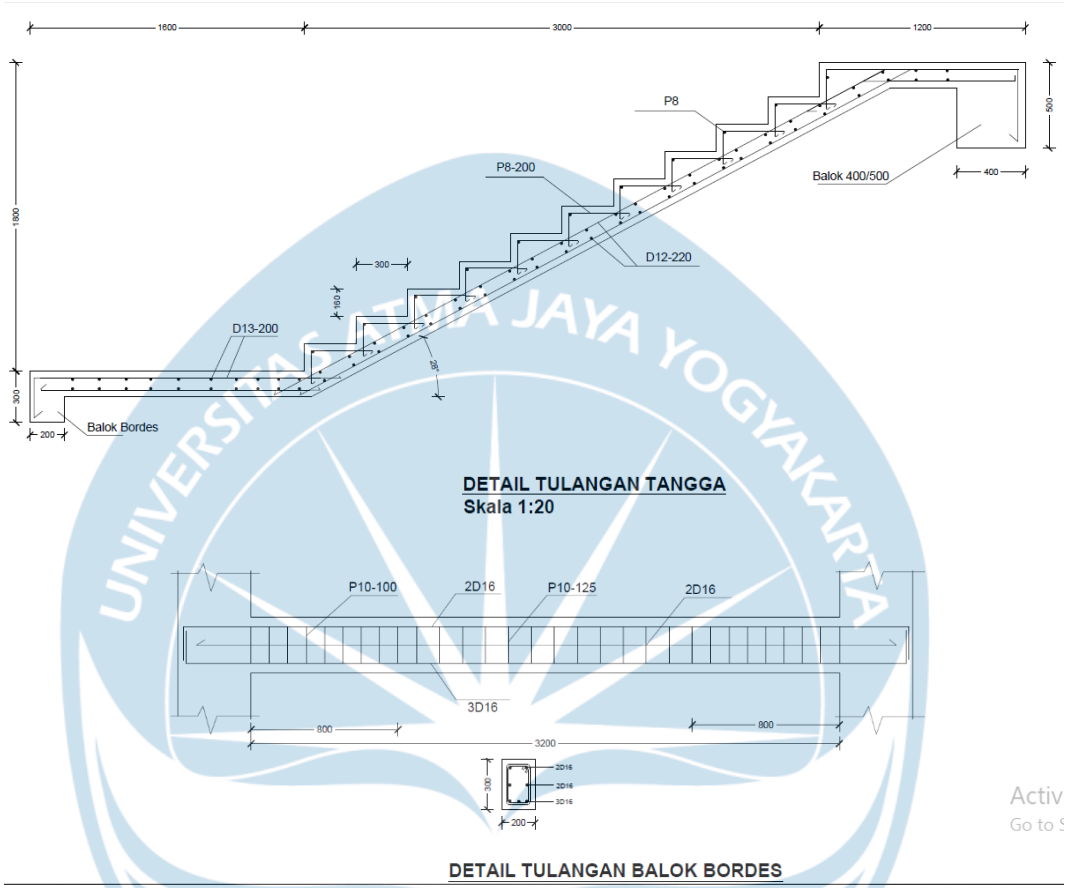

Activ  
Go to 5

Lampiran 2.5 Tulangan Tangga

RENCANA PELAT LANTAI ATAS  
Skala 1:100

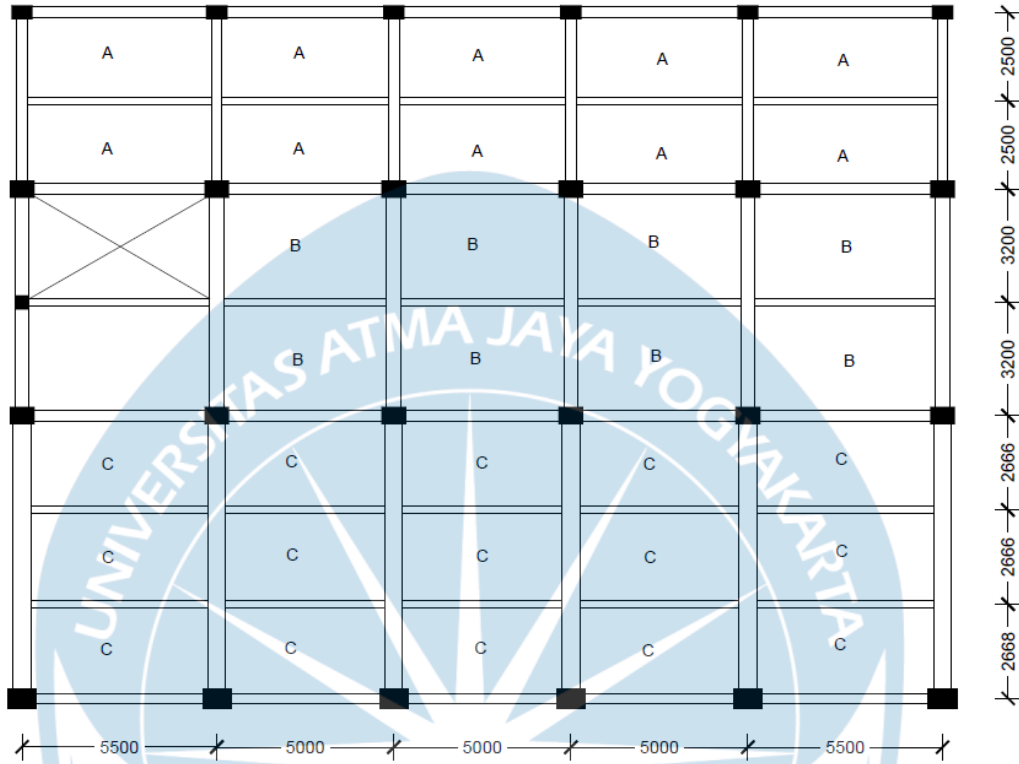

Lampiran 2.6 Denah Pelat Lantai

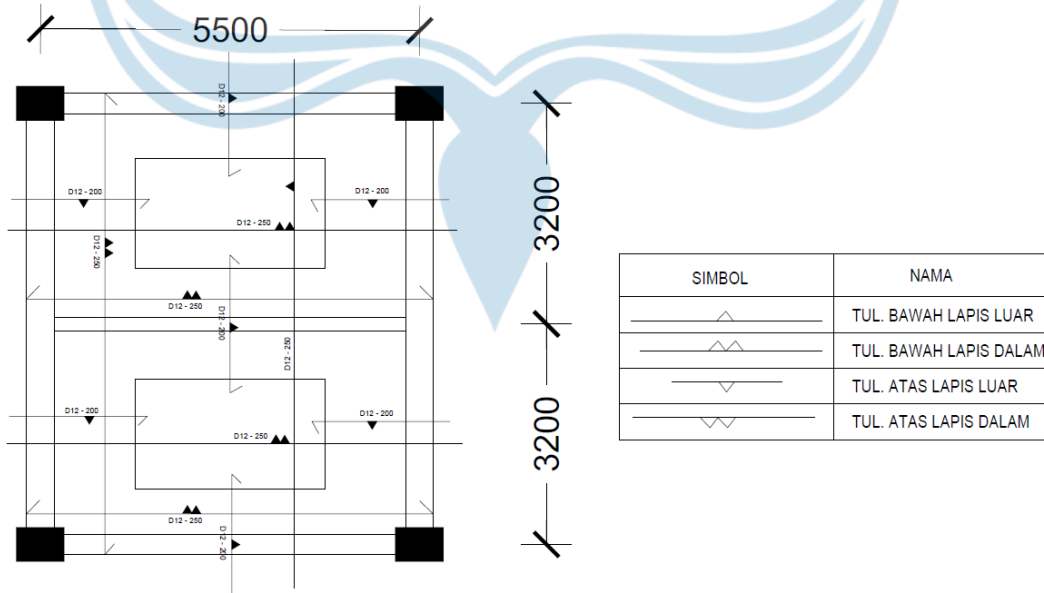

DETAIL TULANGAN PELAT B

### Lampiran 2.7 Penulangan Pelat

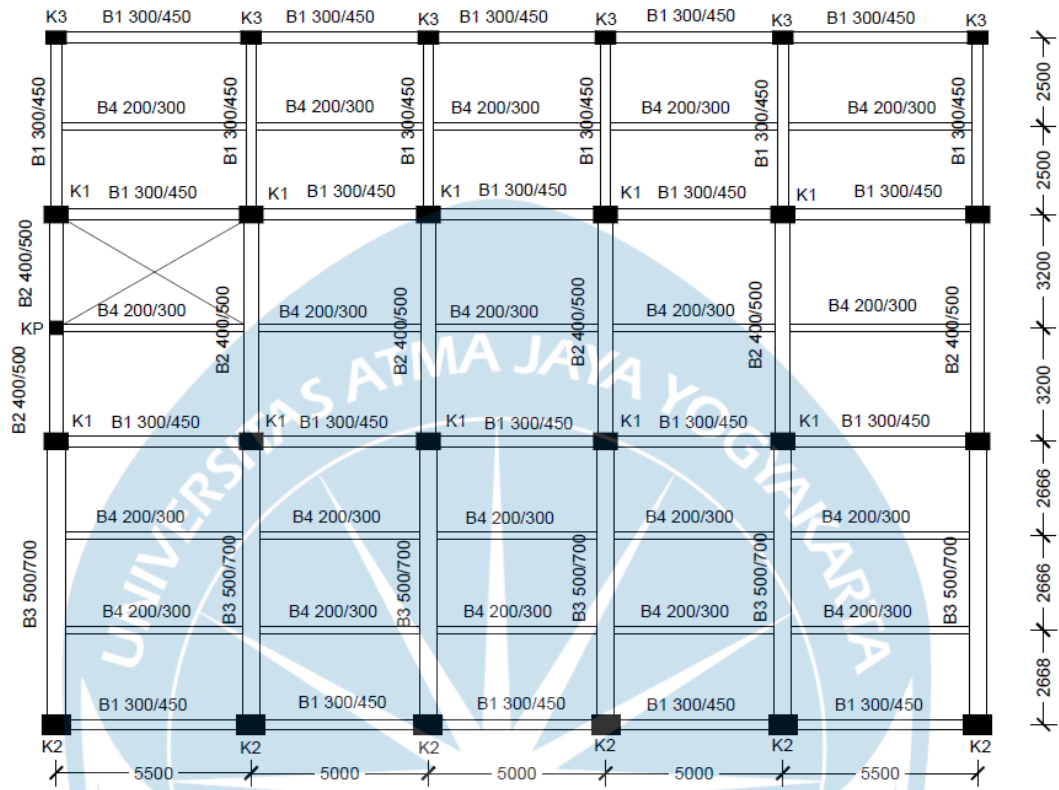

### Lampiran 2.8 Rencana Kolom & Balok

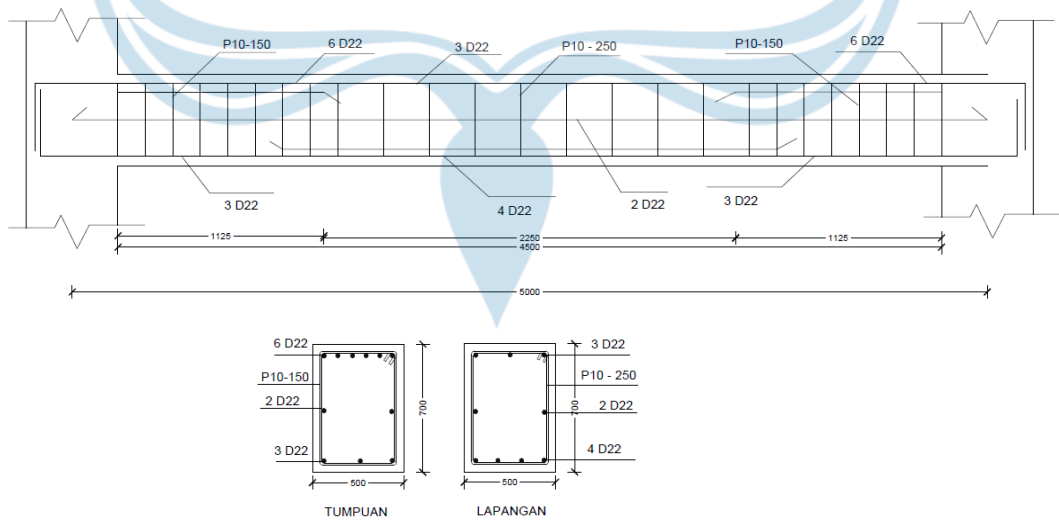

### POTONGAN MEMANJANG BALOK INDUK B3

### Lampiran 2.9 Detail Balok B3 500x700

“ “

**TABEL POTONGAN KOLOM**  
 Skala 1:20

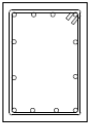
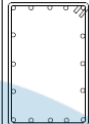
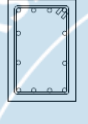
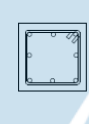
| TYPE<br>LANTAI | KOLOM K1 500 x 700  | TYPE<br>LANTAI | KOLOM K2 550 x 800  |
|----------------|---|----------------|---|
| POTONGAN       |  | POTONGAN       |  |
| TUL. UTAMA     | 12 D25  | TUL. UTAMA     | 16 D22  |
| SENGKANG LAP.  | D10 - 300   | SENGKANG       | D10 - 400   |
| SENGKANG TUMP. | D10 - 150   | SENGKANG TUMP. | D10 - 200   |
| TYPE<br>LANTAI | KOLOM K3 400 x 600  | TYPE<br>LANTAI | KOLOM KP 400 x 400  |
| POTONGAN       |  | POTONGAN       |  |
| TUL. UTAMA     | 12 D22  | TUL. UTAMA     | 8 D22   |
| SENGKANG LAP.  | D10 - 300   | SENGKANG       | D10 - 200   |
| SENGKANG TUMP. | D10 - 150   | SENGKANG TUMP. | D10 - 100   |

**POTONGAN MEMANJANG K1**  
 Skala 1:20

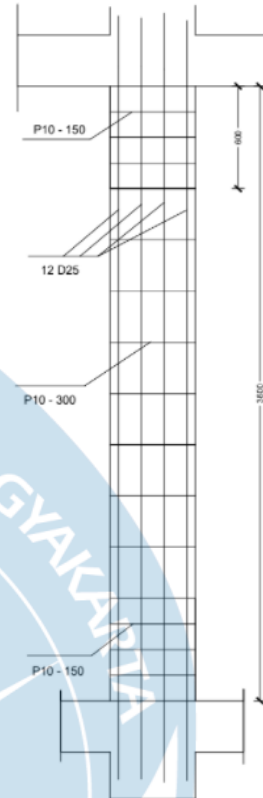

Lampiran 2.10 Detail Kolom

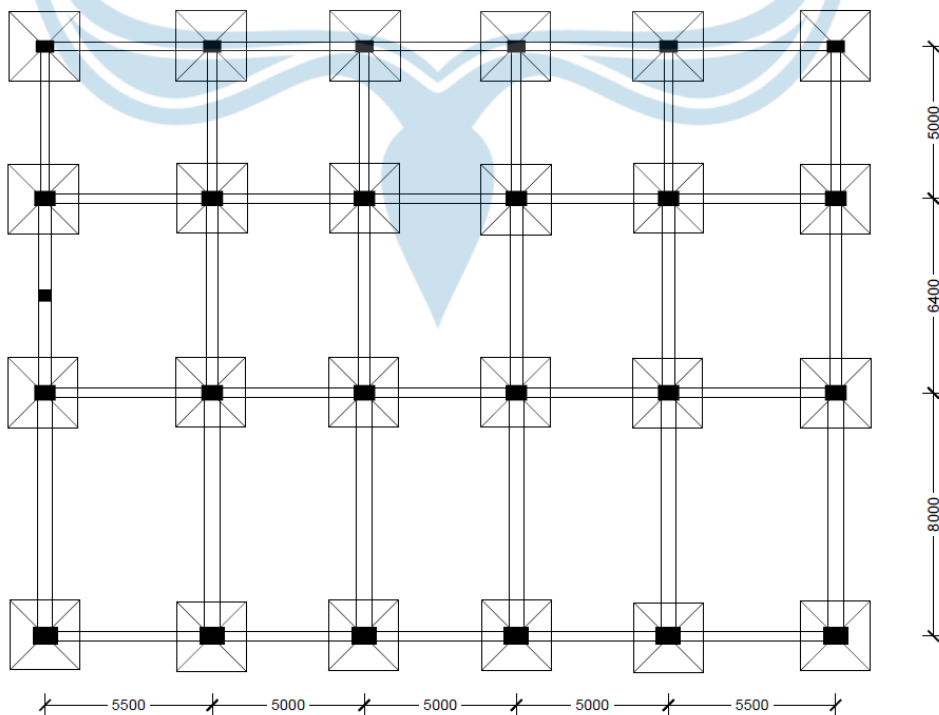

Lampiran 2.11 Denah Pondasi

**POTONGAN MEMANJANG K1**  
**Skala 1:20**

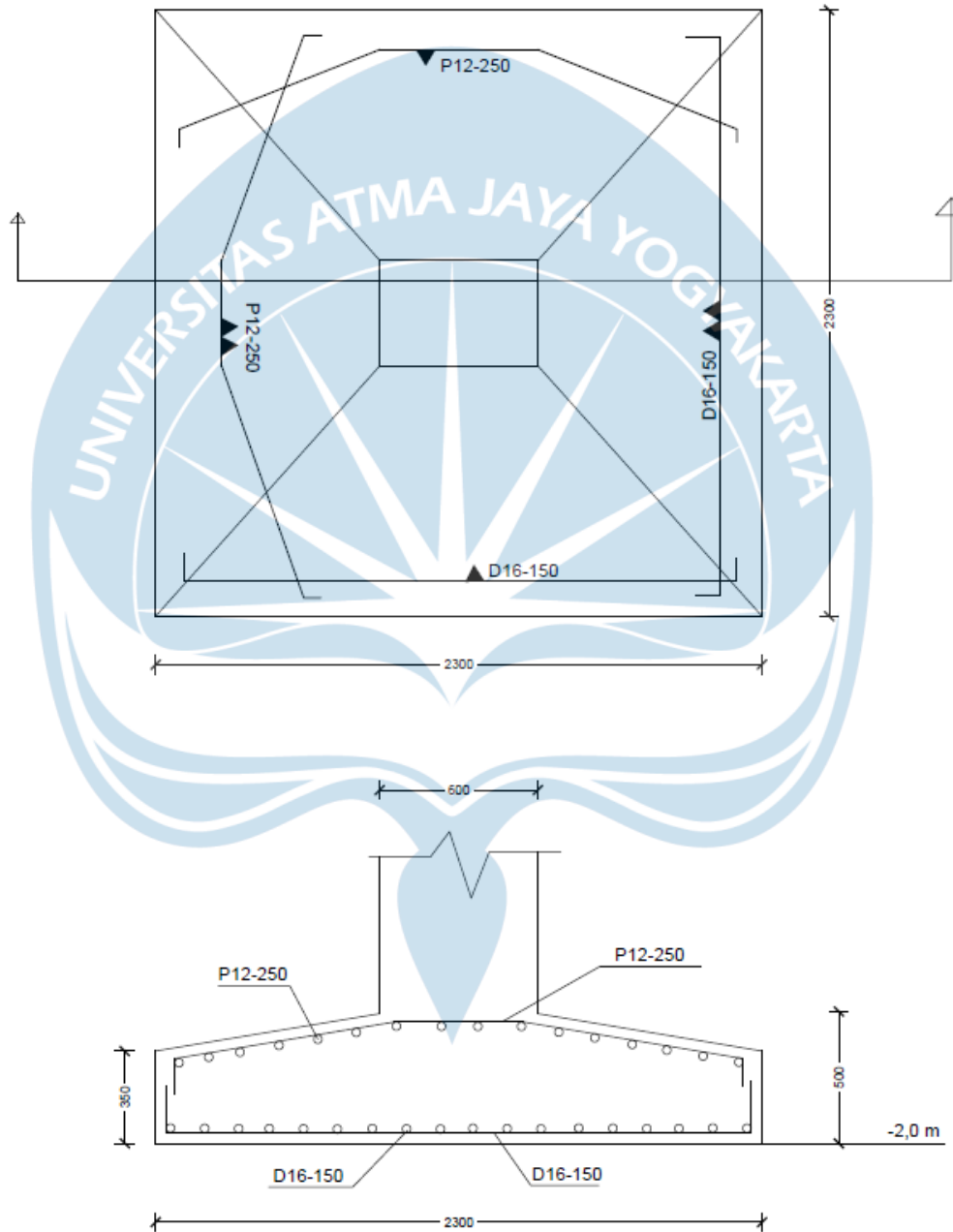

Lampiran 2.12 Detail Penulangan Pondasi

### Lampiran Bab III Praktik Perancangan Bangunan Air

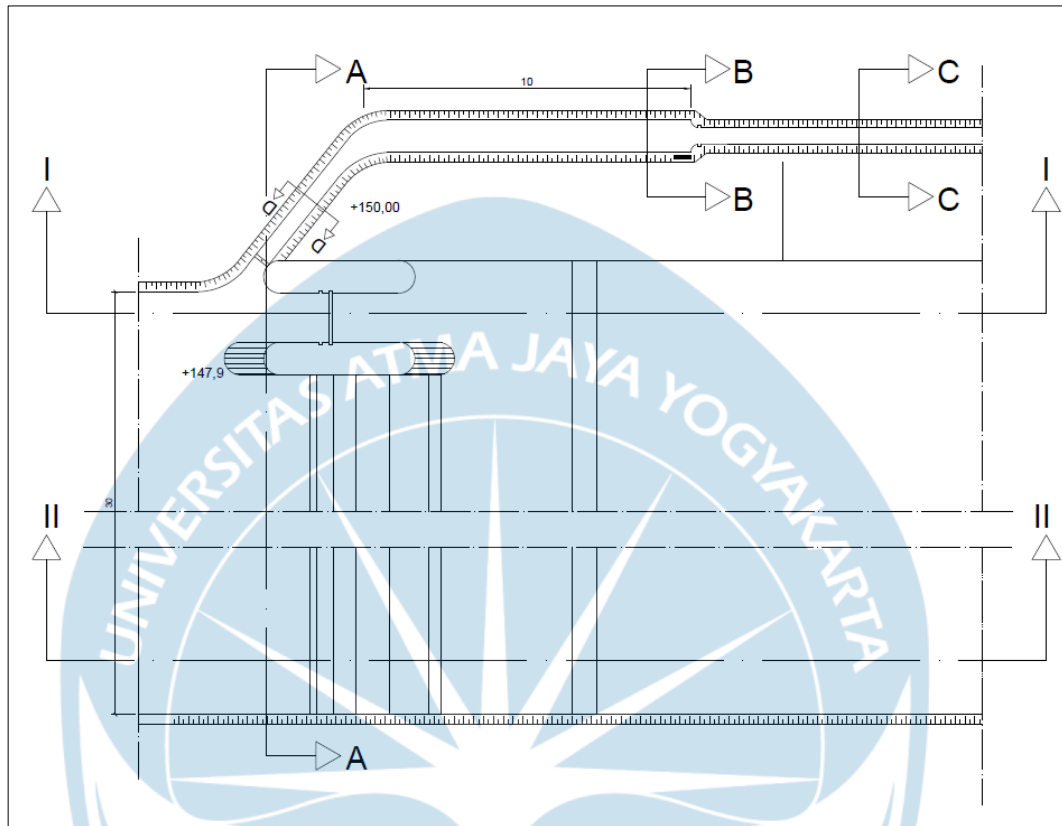

Lampiran 3.1 *Layout Bendung*

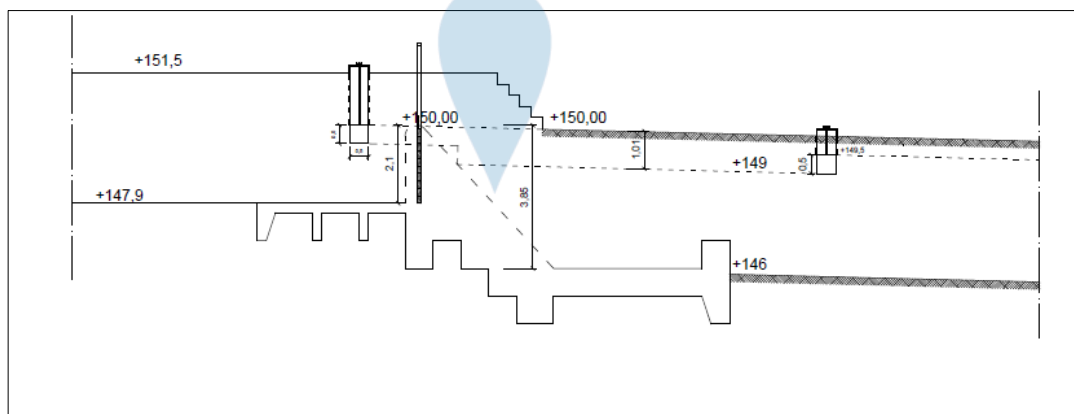

Lampiran 3.2 *Potongan Bendung I-I*



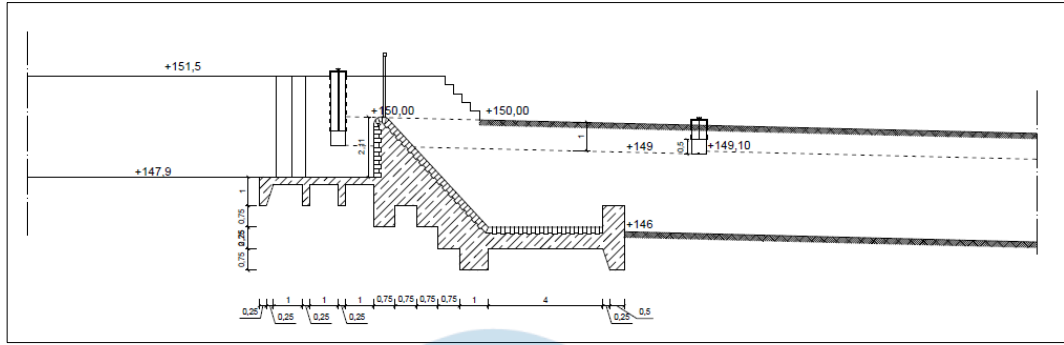

Lampiran 3.3 Potongan Bendung II-II

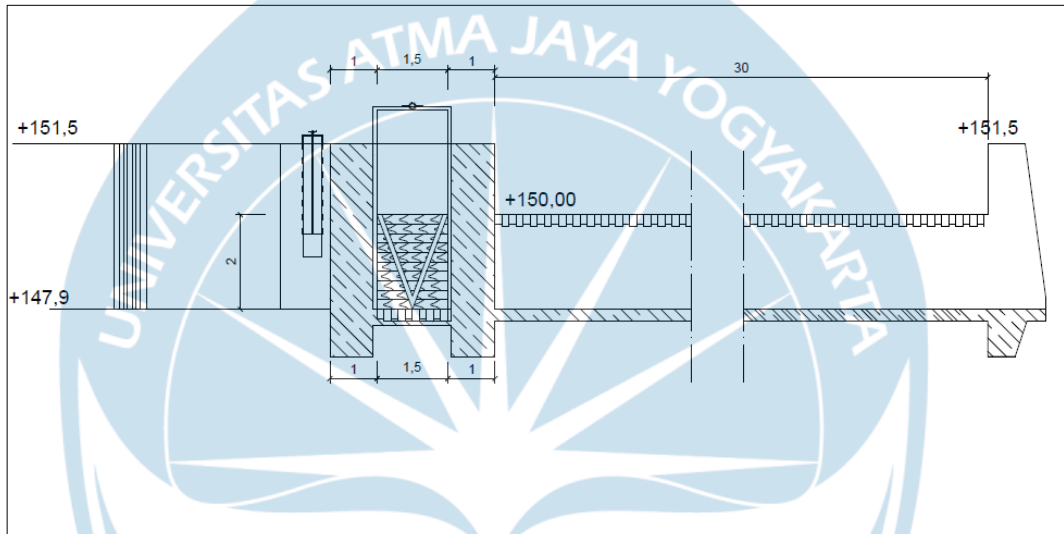

Lampiran 3.4 Potongan Bendung A-A

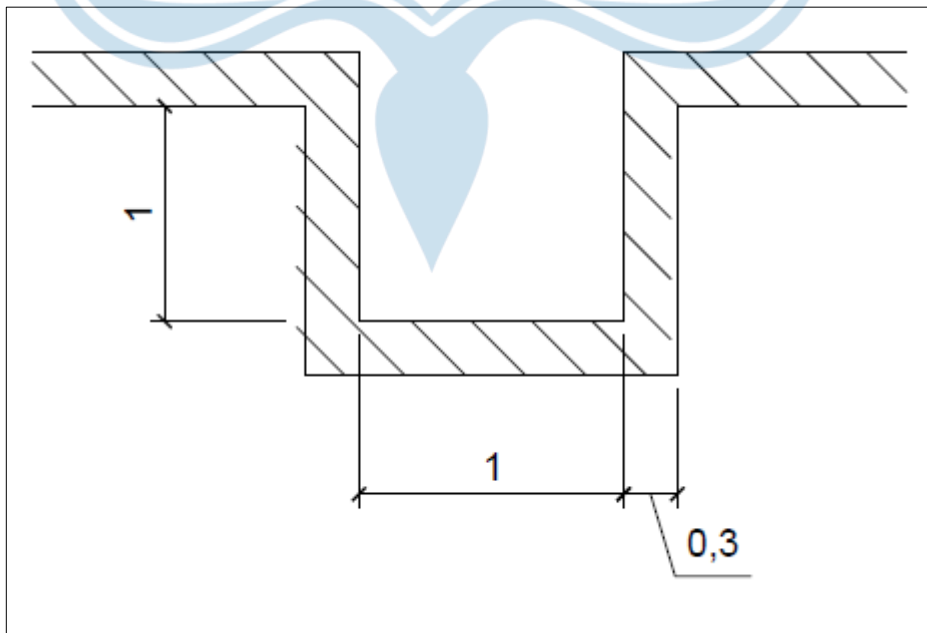

Lampiran 3.5 Potongan Bendung B-B

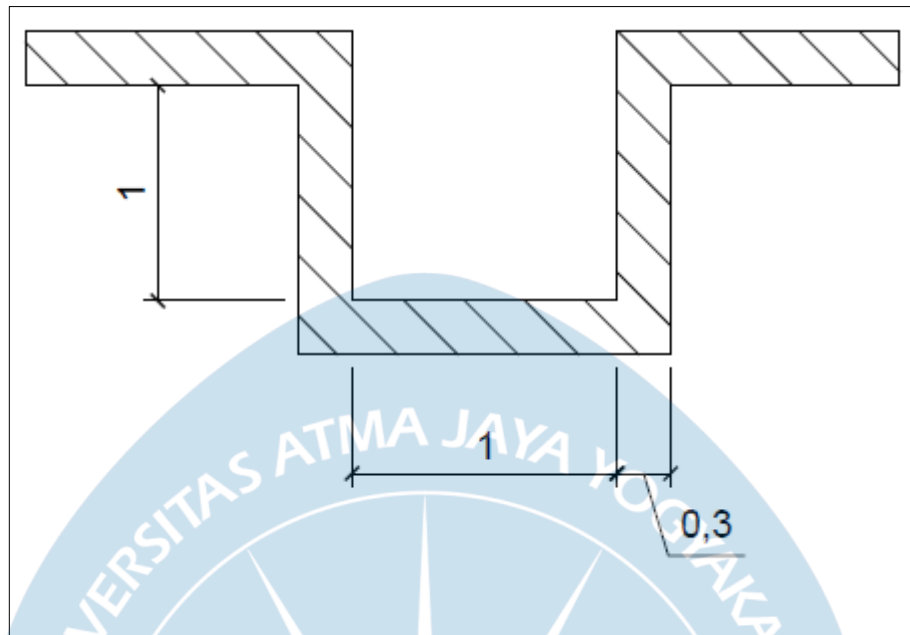

Lampiran 3.6 Potongan Bendung C-C

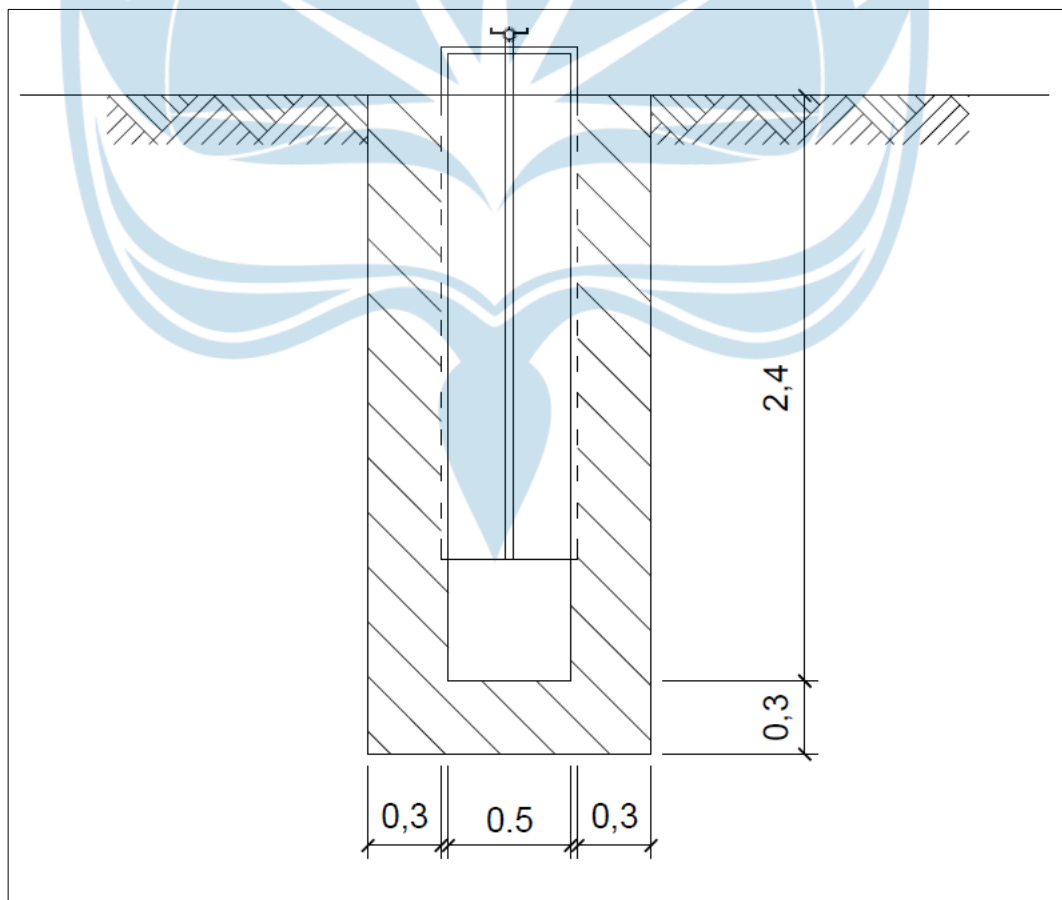



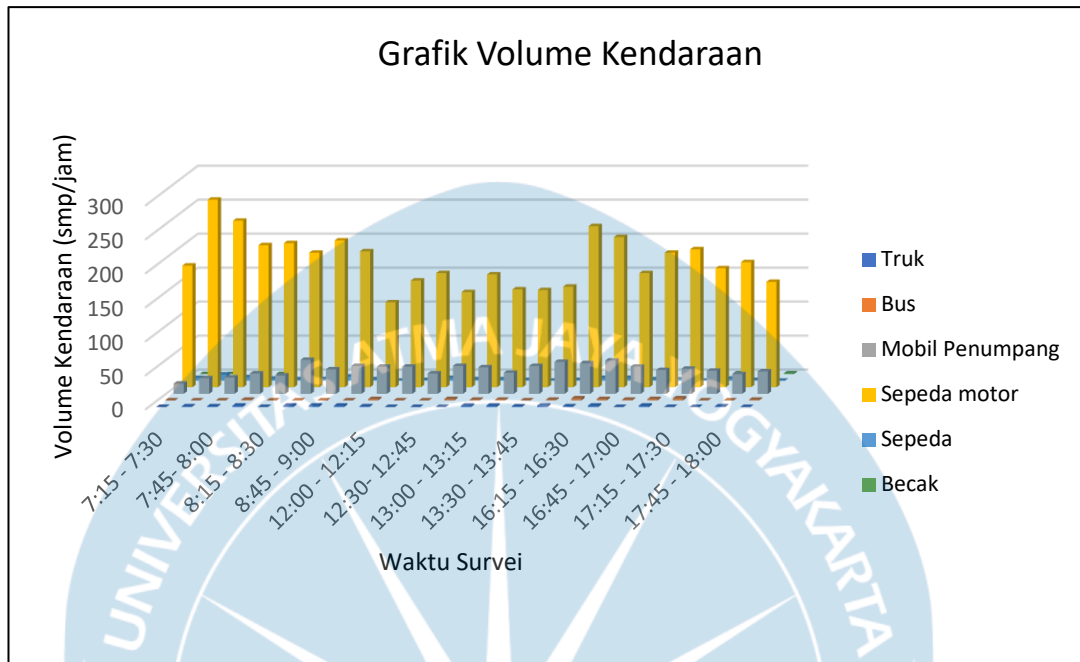

Lampiran 3.7 Potongan Bendung D-D

## Lampiran Bab IV Praktik Perancangan Jalan

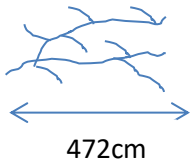

Lampiran 4.1 Grafik Volume Lalu Lintas Kendaraan Arah ke Rejowinangun

| Sta         | Jenis Kerusakan | Foto | Sketsa | Penyebab  | Perbaikan  |
|-------------|-----------------|------|--------|---|--|
| 0+00 – 0+10 | Retak Refleksi  |      |        | <ul style="list-style-type: none"> <li>Perubahan kadar air pada tanah</li> </ul>  | <ul style="list-style-type: none"> <li>Penambalan parsial</li> <li>Dilakukan penutupan menggunakan larutan emulsi aspal</li> </ul> |
| 0+00 – 0+20 | Retak Halus     |      |        | <ul style="list-style-type: none"> <li>Bahan perkerasan yang kurang baik</li> <li>Lapis tanah bawah perkerasan kurang stabil</li> </ul> | <ul style="list-style-type: none"> <li>Yaitu dengan cara laburan aspal setempat</li> </ul>   |

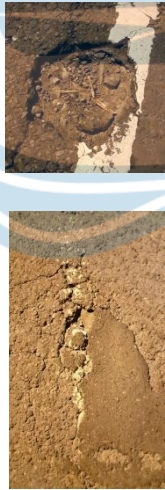
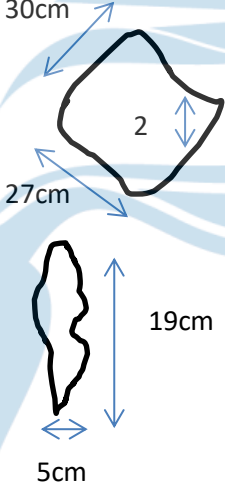
|             |                               |   |  |  |   |
|-------------|-------------------------------|---|--|--|---|
| 0+00 – 0+30 | Retak Kulit Buaya             |    |    | <ul style="list-style-type: none"> <li>• Bahan perkerasan yang kurang baik</li> <li>• Lapis tanah bawah perkerasan kurang stabil</li> </ul>  | <ul style="list-style-type: none"> <li>• Yaitu dengan cara laburan aspal setempat</li> </ul>  |
| 0+00 – 0+40 | Retak Sambungan               |    |     | <ul style="list-style-type: none"> <li>• Karena ikatan sambungan kedua jalur kurang</li> </ul>   | <ul style="list-style-type: none"> <li>• Memasukan campuran aspal cair dan pasir ke dalam celah yang retak.</li> </ul>  |
| 0+00 – 0+50 | Retak Tepi                    |   |    | <ul style="list-style-type: none"> <li>• Akar tanaman yang tumbuh di tepi perkerasan</li> <li>• Drainase yang kurang baik</li> </ul>   | <ul style="list-style-type: none"> <li>• Perbaiki saluran drainase</li> <li>• Dilakukan overlay dengan aspal beton</li> </ul>   |
| 0+00 – 0+70 | 1. Retak Refleksi<br>2. Retak |  |  | <ul style="list-style-type: none"> <li>• Kepadatan perkerasan yang kurang</li> <li>• Akibat air hujan yang jatuh pada area perkerasan</li> <li>• Perkerasan yang tidak merata</li> <li>• Perawatan yang kurang diperhatikan</li> </ul> | <ul style="list-style-type: none"> <li>• Menggali area yang rusak dan diganti dengan lapisan yang lebih bagus</li> <li>• Mengganti lapisan dengan yang baru dan perataan lapisan</li> </ul> |

Lampiran 4.2 Data Kerusakan Jalan

## Lampiran Bab V Praktik Perancangan Biaya dan Waktu

| No                  | Pekerjaan   | Volume   | Volume Hitungan | Satuan | Harga Satuan Yogyakarta | Harga Satuan Jakarta | Harga Total Yogyakarta | Harga Total Jakarta |
|---------------------|---|----------|-----------------|--------|-------------------------|----------------------|------------------------|---------------------|
| Persiapan           |   |          |                 |        |                         |                      |                        |                     |
| 1                   | Pembersihan Lahan   | 265.514  | 276.1975        | m2     | Rp 8,200                | Rp 13,850            | Rp 2,177,215           | Rp 3,825,335.38     |
| 2                   | Pagar sementara dari seng gelombang                                   | 73.04    | 73.04           | m'     | Rp 350,455              | Rp 598,443           | Rp 25,597,197          | Rp 43,710,295.35    |
| 3                   | Pengukuran dan pemasangan bouwplank                                   | 59       | 59              | m'     | Rp 38,134               | Rp 51,779            | Rp 2,249,906           | Rp 3,054,961.00     |
| 4                   | Pembuatan kantor direksi sementara                                    | 21       | 21              | m2     | Rp 1,078,985            | Rp 1,903,717         | Rp 22,658,685          | Rp 39,978,061.20    |
| 5                   | Pembuatan brak bahan/brak kerja                                       | 20       | 20              | m2     | Rp 954,855              | Rp 1,798,758         | Rp 19,097,100          | Rp 35,975,150.60    |
| Subtotal            |   |          |                 |        |                         |                      | Rp 71,780,102          | Rp 126,543,803.52   |
| Pekerjaan Tanah     |   |          |                 |        |                         |                      |                        |                     |
| 1                   | Menggali Tanah Biasa Sedalam 2m                                       | 104.1024 | 104.1024        | m3     | Rp 45,450               | Rp 74,025            | Rp 4,731,454           | Rp 7,706,180.16     |
| 2                   | Urugan Kembali  | 95.6664  | 95.6664         | m3     | Rp 27,000               | Rp 44,250            | Rp 2,582,993           | Rp 4,233,238.20     |
| 3                   | Pemadatan Tanah   | 5.92     | 5.92            | m2     | Rp 27,000               | Rp 44,250            | Rp 159,840             | Rp 261,960.00       |
| 4                   | Urugan pasir  | 5.312    | 5.132           | m3     | Rp 14,800               | Rp 24,050            | Rp 78,618              | Rp 123,424.60       |
| Subtotal            |   |          |                 |        |                         |                      | Rp 7,552,904           | Rp 12,324,802.96    |
| Struktur Bawah      |   |          |                 |        |                         |                      |                        |                     |
| 1                   | Pemasangan Pondasi Batu Belah, 1 SP : 3 KP : 10 PP<br>Pekerjaan Beton | 1.98     | 1.98            | m3     | Rp 530,261              | Rp 571,605           | Rp 1,049,917           | Rp 1,131,778        |
| 2                   | Pondasi footplate F1 K-250  | 2.304    | 2.304           | m3     | Rp 965,091              | Rp 1,459,257         | Rp 2,223,571           | Rp 3,362,128        |
| 3                   | Pondasi footplate F1' K-250   | 1.152    | 1.152           | m3     | Rp 965,091              | Rp 1,459,257         | Rp 1,111,785           | Rp 1,681,064        |
| 4                   | Pondasi footplate F2 K-250  | 1.65     | 1.65            | m3     | Rp 965,091              | Rp 1,459,257         | Rp 1,592,401           | Rp 2,407,774        |
| 5                   | Pondasi footplate F2' K-250   | 1.35     | 1.35            | m3     | Rp 965,091              | Rp 1,459,257         | Rp 1,302,873           | Rp 1,969,997        |
| 6                   | Sloof S1 K-250  | 6.606    | 6.606           | m3     | Rp 965,091              | Rp 1,459,257         | Rp 6,375,394           | Rp 9,639,852        |
| 7                   | Sloof S2 K-225  | 1.083    | 1.083           | m3     | Rp 949,504              | Rp 1,443,303         | Rp 1,028,312           | Rp 1,563,097        |
| Subtotal            |   |          |                 |        |                         |                      | Rp 14,684,254          | Rp 21,755,691       |
| Pekerjaan pembesian |   |          |                 |        |                         |                      |                        |                     |
| 1                   | Pondasi footplate F1 K-250  | 361.4311 | 361.43109       | kg     | Rp 150,290              | Rp 173,475           | Rp 54,319,478          | Rp 62,699,257.73    |
| 2                   | Pondasi footplate F1' K-250   | 140.4755 | 140.47549       | kg     | Rp 150,290              | Rp 173,475           | Rp 21,112,062          | Rp 24,368,986.18    |
| 3                   | Pondasi footplate F2 K-250  | 317.7109 | 317.71093       | kg     | Rp 150,290              | Rp 173,475           | Rp 47,748,775          | Rp 55,114,903.33    |
| 4                   | Pondasi footplate F2' K-250   | 226.9364 | 226.93638       | kg     | Rp 150,290              | Rp 173,475           | Rp 34,106,268          | Rp 39,367,788.10    |
| 5                   | Sloof S1 K-250  | 1900.429 | 1900.4288       | kg     | Rp 150,290              | Rp 173,475           | Rp 285,615,438         | Rp 329,676,879.14   |
| 6                   | Sloof S2 K-225  | 280.2254 | 280.22539       | kg     | Rp 150,290              | Rp 173,475           | Rp 42,115,074          | Rp 48,612,099.61    |
| Subtotal            |   |          |                 |        |                         |                      | Rp 485,017,096         | Rp 559,839,914.10   |
| Pekerjaan bekisting |   |          |                 |        |                         |                      |                        |                     |
| 1                   | Pondasi footplate F1 K-250  | 7.68     | 7.68            | m2     | Rp 124,439              | Rp 204,740           | Rp 955,692             | Rp 1,572,403        |
| 2                   | Pondasi footplate F1' K-250   | 3.72     | 3.72            | m2     | Rp 124,439              | Rp 204,740           | Rp 462,913             | Rp 761,633          |
| 3                   | Pondasi footplate F2 K-250  | 6.6      | 6.6             | m2     | Rp 124,439              | Rp 204,740           | Rp 821,297             | Rp 1,351,284        |
| 4                   | Pondasi footplate F2' K-250   | 6.6      | 6.6             | m2     | Rp 124,439              | Rp 204,740           | Rp 821,297             | Rp 1,351,284        |
| 5                   | Sloof S1 K-250  | 88.08    | 88.08           | m2     | Rp 133,939              | Rp 220,880           | Rp 11,797,347          | Rp 19,455,110       |
| 6                   | Sloof S2 K-225  | 19.855   | 19.855          | m2     | Rp 133,939              | Rp 220,880           | Rp 2,659,359           | Rp 4,385,572        |

| No                  | Pekerjaan                  | Volume   | Volume Hitungan | Satuan | Harga Satuan Yogyakarta | Harga Satuan Jakarta | Harga Total Yogyakarta | Harga Total Jakarta |
|---------------------|----------------------------|----------|-----------------|--------|-------------------------|----------------------|------------------------|---------------------|
|                     |                            |          |                 |        | Subtotal                |                      | Rp 17,517,905          | Rp 28,877,287       |
| Struktur Atas       |                            |          |                 |        |                         |                      |                        |                     |
| Pekerjaan Beton     |                            |          |                 |        |                         |                      |                        |                     |
| Lantai 1            |                            |          |                 |        |                         |                      |                        |                     |
| 1                   | Kolom K1 K-250             | 2.6424   | 2.6424          | m3     | Rp 965,091              | Rp 1,459,257         | Rp 2,550,158           | Rp 3,855,940.70     |
| 2                   | Kolom K2 K-250             | 7.2666   | 7.2666          | m3     | Rp 965,091              | Rp 1,459,257         | Rp 7,012,934           | Rp 10,603,836.92    |
| 3                   | Kolom K3 K-250             | 0.4404   | 0.4404          | m3     | Rp 965,091              | Rp 1,459,257         | Rp 425,026             | Rp 642,656.78       |
| 4                   | Kolom K4 K-250             | 0.2202   | 0.2202          | m3     | Rp 965,091              | Rp 1,459,257         | Rp 212,513             | Rp 321,328.39       |
| 5                   | Kolom K5 K-250             | 0.59454  | 0.59454         | m3     | Rp 965,091              | Rp 1,459,257         | Rp 573,785             | Rp 867,586.66       |
| 6                   | Kolom praktis K-225        | 1.3212   | 1.3212          | m3     | Rp 949,504              | Rp 1,443,303         | Rp 1,254,484           | Rp 1,906,891.92     |
| 7                   | Balok B1 K-250             | 1.925    | 1.925           | m3     | Rp 965,091              | Rp 1,459,257         | Rp 1,857,801           | Rp 2,809,069.73     |
| 8                   | Balok B2 K-250             | 4.67775  | 4.67775         | m3     | Rp 965,091              | Rp 1,459,257         | Rp 4,514,457           | Rp 6,826,039.43     |
| 9                   | Balok B3 K-250             | 4.437    | 4.437           | m3     | Rp 965,091              | Rp 1,459,257         | Rp 4,282,111           | Rp 6,474,723.31     |
| 10                  | Balok B4 K-250             | 0.56925  | 0.56925         | m3     | Rp 965,091              | Rp 1,459,257         | Rp 549,378             | Rp 830,682.05       |
| 11                  | Balok B5 K-250             | 0.495    | 0.495           | m3     | Rp 965,091              | Rp 1,459,257         | Rp 477,720             | Rp 722,332.22       |
| 12                  | Balok B6 K-250             | 0.24     | 0.24            | m3     | Rp 965,091              | Rp 1,459,257         | Rp 231,622             | Rp 350,221.68       |
| 13                  | Plat Luifel lantai 1 K-225 | 2.098866 | 2.098866        | m3     | Rp 949,504              | Rp 1,443,303         | Rp 1,992,881           | Rp 3,029,299.59     |
|                     |                            |          |                 |        | Subtotal                |                      | Rp 23,941,989          | Rp 39,240,609.37    |
| Lantai 2            |                            |          |                 |        |                         |                      |                        |                     |
| 1                   | kolom K1 pada F1 K250      | 1.2888   | 1.2888          | m3     | Rp 965,091              | Rp 1,459,257         | Rp 1,243,810           | Rp 1,880,690.42     |
| 2                   | kolom K1 pada F1' K250     | 1.2888   | 1.2888          | m3     | Rp 965,091              | Rp 1,459,257         | Rp 1,243,810           | Rp 1,880,690.42     |
| 3                   | kolom K2 pada F2 K250      | 5.8176   | 5.8176          | m3     | Rp 965,091              | Rp 1,459,257         | Rp 5,614,516           | Rp 8,489,373.52     |
| 4                   | kolom K2 pada F2' K250     | 1.9332   | 1.9332          | m3     | Rp 965,091              | Rp 1,459,257         | Rp 1,865,715           | Rp 2,821,035.63     |
| 5                   | Kolom K3 K-250             | 0.4848   | 0.4848          | m3     | Rp 965,091              | Rp 1,459,257         | Rp 467,876             | Rp 707,447.79       |
| 6                   | Kolom K5 K-250             | 0.51678  | 0.51678         | m3     | Rp 965,091              | Rp 1,459,257         | Rp 498,740             | Rp 754,114.83       |
| 7                   | Kolom praktis K-225        | 1.570752 | 1.570752        | m3     | Rp 949,504              | Rp 1,443,303         | Rp 1,491,435           | Rp 2,267,071.07     |
| 8                   | Balok RB1 K-250            | 2.432438 | 2.4324375       | m3     | Rp 965,091              | Rp 1,459,257         | Rp 2,347,525           | Rp 3,549,551.45     |
| 9                   | Balok RB2 K-250            | 0.909    | 0.909           | m3     | Rp 965,091              | Rp 1,459,257         | Rp 877,268             | Rp 1,326,464.61     |
| 10                  | Balok RB3 K-250            | 0.328    | 0.328           | m3     | Rp 965,091              | Rp 1,459,257         | Rp 316,550             | Rp 478,636.30       |
| 11                  | Balok RB3' K-250           | 1.04     | 1.04            | m3     | Rp 965,091              | Rp 1,459,257         | Rp 1,003,695           | Rp 1,517,627.28     |
| 12                  | Balok RB4 K-250            | 1.659    | 1.659           | m3     | Rp 965,091              | Rp 1,459,257         | Rp 1,601,087           | Rp 2,420,907.36     |
| 13                  | Balok RB5 K-250            | 0.832572 | 0.832572        | m3     | Rp 965,091              | Rp 1,459,257         | Rp 803,508             | Rp 1,214,936.52     |
| 14                  | Balok LB K-225             | 1.1494   | 1.1494          | m3     | Rp 949,504              | Rp 1,443,303         | Rp 1,091,359           | Rp 1,658,932.47     |
| 15                  | Plat Lantai K250           | 12.08268 | 12.08268        | m3     | Rp 965,091              | Rp 1,459,257         | Rp 11,660,891          | Rp 17,631,735.37    |
| 16                  | Plat Luifel lantai 2 K-225 | 0.121352 | 0.121352        | m3     | Rp 949,504              | Rp 1,443,303         | Rp 115,224             | Rp 175,147.71       |
| 17                  | Dag atap K-225             | 5.0764   | 5.0764          | m3     | Rp 949,504              | Rp 1,443,303         | Rp 4,820,060           | Rp 7,326,783.35     |
|                     |                            |          |                 |        | Subtotal                |                      | Rp 32,127,785          | Rp 56,101,146.11    |
| Pekerjaan Pembesian |                            |          |                 |        |                         |                      |                        |                     |
| Lantai 1            |                            |          |                 |        |                         |                      |                        |                     |
| 1                   | Kolom K1 K-250             | 714.1995 | 714.19945       | kg     | Rp 103,420              | Rp 173,475           | Rp 73,862,507          | Rp 123,895,750      |
| 2                   | Kolom K2 K-250             | 1994.899 | 1994.8986       | kg     | Rp 103,420              | Rp 173,475           | Rp 206,312,410         | Rp 346,065,029      |
| 3                   | Kolom K3 K-250             | 83.42537 | 83.425374       | kg     | Rp 103,420              | Rp 173,475           | Rp 8,627,852           | Rp 14,472,217       |
| 4                   | Kolom K4 K-250             | 41.06988 | 41.069885       | kg     | Rp 103,420              | Rp 173,475           | Rp 4,247,448           | Rp 7,124,598        |
| 5                   | Kolom K5 K-250             | 128.3266 | 128.32657       | kg     | Rp 103,420              | Rp 173,475           | Rp 13,271,534          | Rp 22,261,452       |
| 6                   | Kolom praktis K-225        | 254.8992 | 254.89919       | kg     | Rp 103,420              | Rp 173,475           | Rp 26,361,674          | Rp 44,218,637       |

| No | Pekerjaan                  | Volume   | Volume Hitungan | Satuan | Harga Satuan Yogyakarta | Harga Satuan Jakarta | Harga Total Yogyakarta | Harga Total Jakarta |
|----|----------------------------|----------|-----------------|--------|-------------------------|----------------------|------------------------|---------------------|
| 7  | Balok B1 K-250             | 335.1947 | 335.19474       | kg     | Rp 103,420              | Rp 173,475           | Rp 34,665,840          | Rp 58,147,908       |
| 8  | Balok B2 K-250             | 701.5914 | 701.59138       | kg     | Rp 103,420              | Rp 173,475           | Rp 72,558,580          | Rp 121,708,564      |
| 9  | Balok B3 K-250             | 728.6112 | 728.61118       | kg     | Rp 103,420              | Rp 173,475           | Rp 75,352,968          | Rp 126,395,824      |
| 10 | Balok B4 K-250             | 131.5455 | 131.54554       | kg     | Rp 103,420              | Rp 173,475           | Rp 13,604,440          | Rp 22,819,863       |
| 11 | Balok B5 K-250             | 90.25728 | 90.25728        | kg     | Rp 103,420              | Rp 173,475           | Rp 9,334,408           | Rp 15,657,382       |
| 12 | Balok B6 K-250             | 68.34    | 68.34           | kg     | Rp 103,420              | Rp 173,475           | Rp 7,067,723           | Rp 11,855,282       |
| 13 | Plat Luifel lantai 1 K-225 | 340.174  | 340.174         | kg     | Rp 103,420              | Rp 173,475           | Rp 35,180,795          | Rp 59,011,685       |
|    |                            |          |                 |        | Subtotal                |                      | Rp 545,267,384         | Rp 973,634,190      |
|    | Lantai 2                   |          |                 |        |                         |                      |                        |                     |
| 1  | kolom K1 pada F1 K250      | 204.5118 | 204.51182       | kg     | Rp 103,420              | Rp 173,475           | Rp 21,150,613          | Rp 35,477,688       |
| 2  | kolom K1 pada F1' K250     | 174.0073 | 174.00727       | kg     | Rp 103,420              | Rp 173,475           | Rp 17,995,832          | Rp 30,185,911       |
| 3  | kolom K2 pada F2 K250      | 766.341  | 766.34099       | kg     | Rp 103,420              | Rp 173,475           | Rp 79,254,986          | Rp 132,941,004      |
| 4  | kolom K2 pada F2' K250     | 346.4046 | 346.40464       | kg     | Rp 103,420              | Rp 173,475           | Rp 35,825,167          | Rp 60,092,544       |
| 5  | Kolom K3 K-250             | 77.30301 | 77.303008       | kg     | Rp 103,420              | Rp 173,475           | Rp 7,994,677           | Rp 13,410,139       |
| 6  | Kolom K5 K-250             | 94.27269 | 94.272686       | kg     | Rp 103,420              | Rp 173,475           | Rp 9,749,681           | Rp 16,353,954       |
| 7  | Kolom praktis K-225        | 254.8992 | 254.89919       | kg     | Rp 103,420              | Rp 173,475           | Rp 26,361,674          | Rp 44,218,637       |
| 8  | Balok RB1 K-250            | 375.7327 | 375.73267       | kg     | Rp 103,420              | Rp 173,475           | Rp 38,858,273          | Rp 65,180,226       |
| 9  | Balok RB2 K-250            | 336.1952 | 336.1952        | kg     | Rp 103,420              | Rp 173,475           | Rp 34,769,308          | Rp 58,321,462       |
| 10 | Balok RB3 K-250            | 87.80489 | 87.80489        | kg     | Rp 103,420              | Rp 173,475           | Rp 9,080,782           | Rp 15,231,953       |
| 11 | Balok RB3' K-250           | 61.5156  | 61.5156         | kg     | Rp 103,420              | Rp 173,475           | Rp 6,361,943           | Rp 10,671,419       |
| 12 | Balok RB4 K-250            | 337.4216 | 337.42159       | kg     | Rp 103,420              | Rp 173,475           | Rp 34,896,141          | Rp 58,534,210       |
| 13 | Balok RB5 K-250            | 242.4786 | 242.47856       | kg     | Rp 103,420              | Rp 173,475           | Rp 25,077,133          | Rp 42,063,969       |
| 14 | Balok LB K-225             | 184.6912 | 184.6912        | kg     | Rp 103,420              | Rp 173,475           | Rp 19,100,764          | Rp 32,039,306       |
| 15 | Plat Lantai K250           | 2021.972 | 2021.9717       | kg     | Rp 103,420              | Rp 173,475           | Rp 209,112,310         | Rp 350,761,535      |
| 16 | Plat Luifel lantai 2 K-225 | 14.144   | 14.144          | kg     | Rp 103,420              | Rp 173,475           | Rp 1,462,772           | Rp 2,453,630        |
| 17 | Dag atap K-225             | 820.5638 | 820.5638        | kg     | Rp 103,420              | Rp 173,475           | Rp 84,862,708          | Rp 142,347,305      |
|    |                            |          |                 |        | Subtotal                |                      | Rp 575,589,284         | Rp 1,110,284,894    |
|    | Pekerjaan Bekisting        |          |                 |        |                         |                      |                        |                     |
|    | Lantai 1                   |          |                 |        |                         |                      |                        |                     |
| 1  | Kolom K1 K-250             | 27.048   | 27.048          | m2     | Rp 295,370              | Rp 405,725           | Rp 7,989,154           | Rp 10,974,049.80    |
| 2  | Kolom K2 K-250             | 85.008   | 85.008          | m2     | Rp 295,370              | Rp 405,725           | Rp 25,108,770          | Rp 34,489,870.80    |
| 3  | Kolom K3 K-250             | 7.728    | 7.728           | m2     | Rp 295,370              | Rp 405,725           | Rp 2,282,615           | Rp 3,135,442.80     |
| 4  | Kolom K4 K-250             | 4.508    | 4.508           | m2     | Rp 295,370              | Rp 405,725           | Rp 1,331,526           | Rp 1,829,008.30     |
| 5  | Kolom K5 K-250             | 11.0124  | 11.0124         | m2     | Rp 295,370              | Rp 405,725           | Rp 3,252,727           | Rp 4,468,005.99     |
| 6  | Kolom praktis K-225        | 38.64    | 38.64           | m2     | Rp 295,370              | Rp 405,725           | Rp 11,413,077          | Rp 15,677,214.00    |
| 7  | Balok B1 K-250             | 17.402   | 17.402          | m2     | Rp 311,570              | Rp 447,922           | Rp 5,421,932           | Rp 7,794,738.64     |
| 8  | Balok B2 K-250             | 42.8274  | 42.8274         | m2     | Rp 311,570              | Rp 447,922           | Rp 13,343,712          | Rp 19,183,334.66    |
| 9  | Balok B3 K-250             | 50.286   | 50.286          | m2     | Rp 311,570              | Rp 447,922           | Rp 15,667,584          | Rp 22,524,205.69    |
| 10 | Balok B4 K-250             | 5.88225  | 5.88225         | m2     | Rp 311,570              | Rp 447,922           | Rp 1,832,730           | Rp 2,634,789.18     |
| 11 | Balok B5 K-250             | 3.99     | 3.99            | m2     | Rp 311,570              | Rp 447,922           | Rp 1,243,162           | Rp 1,787,208.78     |
| 12 | Balok B6 K-250             | 3        | 3               | m2     | Rp 311,570              | Rp 447,922           | Rp 934,709             | Rp 1,343,766.00     |
| 13 | Plat Luifel lantai 1 K-225 | 29.9838  | 29.9838         | m2     | Rp 377,370              | Rp 556,725           | Rp 11,314,972          | Rp 16,692,731.06    |
|    |                            |          |                 |        | Subtotal                |                      | Rp 89,821,699          | Rp 142,534,365.71   |
|    | Lantai 2                   |          |                 |        |                         |                      |                        |                     |
| 1  | kolom K1 pada F1 K250      | 16.833   | 16.833          | m2     | Rp 295,370              | Rp 405,725           | Rp 4,971,955           | Rp 6,829,568.93     |

| No | Pekerjaan   | Volume   | Volume Hitungan | Satuan | Harga Satuan Yogyakarta | Harga Satuan Jakarta | Harga Total Yogyakarta | Harga Total Jakarta |
|----|---|----------|-----------------|--------|-------------------------|----------------------|------------------------|---------------------|
| 2  | kolom K1 pada F1' K250  | 16.888   | 16.888          | m2     | Rp 295,370              | Rp 405,725           | Rp 4,988,200           | Rp 6,851,883.80     |
| 3  | kolom K2 pada F2 K250   | 74.688   | 74.688          | m2     | Rp 295,370              | Rp 405,725           | Rp 22,060,557          | Rp 30,302,788.80    |
| 4  | kolom K2 pada F2' K250  | 25.696   | 25.696          | m2     | Rp 295,370              | Rp 405,725           | Rp 7,589,815           | Rp 10,425,509.60    |
| 5  | Kolom K3 K-250  | 9.336    | 9.336           | m2     | Rp 295,370              | Rp 405,725           | Rp 2,757,570           | Rp 3,787,848.60     |
| 6  | Kolom K4 K-250  | 0        | 5.446           | m3     | Rp 295,370              | Rp 405,725           | Rp -                   | Rp 2,209,578.35     |
| 7  | Kolom K5 K-250  | 10.8498  | 10.8498         | m2     | Rp 295,370              | Rp 405,725           | Rp 3,204,700           | Rp 4,402,035.11     |
| 8  | Kolom praktis K-225   | 50.4144  | 46.68           | m2     | Rp 311,570              | Rp 447,922           | Rp 15,707,589          | Rp 20,908,998.96    |
| 9  | Balok RB1 K-250   | 42.16225 | 42.16225        | m2     | Rp 311,570              | Rp 447,922           | Rp 13,136,471          | Rp 18,885,399.34    |
| 10 | Balok RB2 K-250   | 12.12    | 12.12           | m2     | Rp 311,570              | Rp 447,922           | Rp 3,776,222           | Rp 5,428,814.64     |
| 11 | Balok RB3 K-250   | 4.1      | 4.1             | m2     | Rp 311,570              | Rp 447,922           | Rp 1,277,435           | Rp 1,836,480.20     |
| 12 | Balok RB3' K-250  | 13       | 13              | m2     | Rp 311,570              | Rp 447,922           | Rp 4,050,404           | Rp 5,822,986.00     |
| 13 | Balok RB4 K-250   | 30.415   | 30.415          | m2     | Rp 311,570              | Rp 447,922           | Rp 9,476,386           | Rp 13,623,547.63    |
| 14 | Balok RB5 K-250   | 18.5016  | 18.5016         | m2     | Rp 311,570              | Rp 447,922           | Rp 5,764,534           | Rp 8,287,273.68     |
| 15 | Balok LB K-225  | 33.661   | 33.661          | m2     | Rp 377,370              | Rp 556,725           | Rp 12,702,635          | Rp 18,739,920.23    |
| 16 | Plat Lantai K250  | 100.689  | 100.689         | m2     | Rp 377,370              | Rp 556,725           | Rp 37,996,958          | Rp 56,056,083.53    |
| 17 | Plat Luifel lantai 2 K-225  | 1.7336   | 1.7336          | m2     | Rp 377,370              | Rp 556,725           | Rp 654,208             | Rp 965,138.46       |
| 18 | Dag atap K-225  | 75.2     | 75.2            | m2     | Rp 362,370              | Rp 556,725           | Rp 27,250,186          | Rp 41,865,720.00    |
|    |   |          |                 |        | Subtotal                |                      | Rp 149,461,431         | Rp 257,229,575.84   |
| 1  | Lain-Lain   |          |                 |        |                         |                      |                        |                     |
| 1  | Beton Balok Latei BL1 lantai 1 K-225                                  | 1.735258 | 1.7352576       | m3     | Rp 825,269              | Rp 1,443,303         | Rp 1,432,054           | Rp 2,504,502        |
| 2  | Beton Balok Latei BL2 K-225   | 0.09     | 0.09            | m3     | Rp 825,269              | Rp 1,443,303         | Rp 74,274              | Rp 129,897          |
| 3  | Beton Balok Latei BLF1 K-225  | 0.044496 | 0.044496        | m3     | Rp 825,269              | Rp 1,443,303         | Rp 36,721              | Rp 64,221           |
| 4  | Beton Balok Latei BL1 lantai 2 K-225                                  | 1.408752 | 1.408752        | m3     | Rp 825,269              | Rp 1,443,303         | Rp 1,162,599           | Rp 2,033,256        |
| 5  | Pembesian Balok Latei BL1 lantai 1 K-225                              | 472.4932 | 472.49321       | kg     | Rp 103,420              | Rp 173,475           | Rp 48,865,248          | Rp 81,965,759       |
| 6  | Pembesian Balok Latei BL2 K-225                                       | 22.743   | 22.743          | kg     | Rp 103,420              | Rp 173,475           | Rp 2,352,081           | Rp 3,945,342        |
| 7  | Pembesian Balok Latei BLF1 K-225                                      | 15.2998  | 15.2998         | kg     | Rp 103,420              | Rp 173,475           | Rp 1,582,305           | Rp 2,654,133        |
| 8  | Pembesian Latei BL1 lantai 2 K-225                                    | 418.5638 | 418.56384       | kg     | Rp 103,420              | Rp 173,475           | Rp 43,287,873          | Rp 72,610,363       |
| 9  | Bekisting Balok Latei BL1 lantai 1 K-225                              | 1.735258 | 1.7352576       | m2     | Rp 268,755              | Rp 447,922           | Rp 466,359             | Rp 777,260          |
| 10 | Bekisting Balok Latei BL2 K-225                                       | 0.09     | 0.09            | m2     | Rp 268,755              | Rp 447,922           | Rp 24,188              | Rp 40,313           |
| 11 | Bekisting Balok Latei BLF1 K-225                                      | 0.044496 | 0.044496        | m2     | Rp 268,755              | Rp 447,922           | Rp 11,959              | Rp 19,931           |
| 12 | Bekisting Latei BL1 lantai 2 K-225                                    | 31.3056  | 31.3056         | m2     | Rp 268,755              | Rp 447,922           | Rp 8,413,537           | Rp 14,022,467       |
|    |   |          |                 |        | Subtotal                |                      | Rp 107,709,197         | Rp 180,767,445      |
|    | Arsitektur  |          |                 |        |                         |                      |                        |                     |
| 1  | Dinding<br>Memasang 1 m2 dinding 1/2 bata merah 1PC : 6PP<br>Lantai 1 |          |                 |        |                         |                      |                        |                     |
|    | C,1-C2,1  | 6.9425   | 6.9425          | m2     | Rp 107,578              | Rp 166,815           | Rp 746,857             | Rp 1,158,116.51     |
|    | C,1-D,1,1   | 5.8325   | 5.8325          | m2     | Rp 107,578              | Rp 166,815           | Rp 627,446             | Rp 972,951.32       |
|    | D1,1-D1,2,1   | 5.201    | 5.201           | m2     | Rp 107,578              | Rp 166,815           | Rp 559,511             | Rp 867,607.34       |
|    | D1,2,1 - C,2,1  | 5.31     | 5.31            | m2     | Rp 107,578              | Rp 166,815           | Rp 571,237             | Rp 885,790.23       |
|    | D1,1-D1,F   | 3.51     | 3.51            | m2     | Rp 107,578              | Rp 166,815           | Rp 377,597             | Rp 585,522.36       |



| No | Pekerjaan     | Volume  | Volume Hitungan | Satuan | Harga Satuan Yogyakarta | Harga Satuan Jakarta | Harga Total Yogyakarta | Harga Total Jakarta     |
|----|---------------|---------|-----------------|--------|-------------------------|----------------------|------------------------|-------------------------|
|    | F,1-F,3       | 13.65   | 13.65           | m2     | Rp 107,578              | Rp 166,815           | Rp 1,468,433           | Rp 2,277,031.38         |
|    | D,3-F,3       | 10.14   | 10.14           | m2     | Rp 107,578              | Rp 166,815           | Rp 1,090,836           | Rp 1,691,509.03         |
|    | D,3-D,4       | 3.624   | 3.624           | m2     | Rp 107,578              | Rp 166,815           | Rp 389,861             | Rp 604,539.32           |
|    | D,4-F,4       | 9.75    | 9.75            | m2     | Rp 107,578              | Rp 166,815           | Rp 1,048,881           | Rp 1,626,450.99         |
|    | F,3-F,4       | 6.825   | 6.825           | m2     | Rp 107,578              | Rp 166,815           | Rp 734,216             | Rp 1,138,515.69         |
|    | C,2.1-C,6     | 8.5575  | 8.5575          | m2     | Rp 107,578              | Rp 166,815           | Rp 920,594             | Rp 1,427,523.52         |
|    | D,4-D,5       | 6.5975  | 6.5975          | m2     | Rp 107,578              | Rp 166,815           | Rp 709,743             | Rp 1,100,565.17         |
|    | F,4-F,5       | 6.435   | 6.435           | m2     | Rp 107,578              | Rp 166,815           | Rp 692,261             | Rp 1,073,457.65         |
|    | D5,F5         | 6.305   | 6.305           | m2     | Rp 107,578              | Rp 166,815           | Rp 678,276             | Rp 1,051,771.64         |
|    | D,4.1-D.1,4.1 | 4.36    | 4.36            | m2     | Rp 107,578              | Rp 166,815           | Rp 469,038             | Rp 727,315.52           |
|    | E,4-E,4.1     | 4.03    | 4.03            | m2     | Rp 107,578              | Rp 166,815           | Rp 433,537             | Rp 672,266.41           |
|    | F,4.1-E,4.1   | 3.7425  | 3.7425          | m2     | Rp 107,578              | Rp 166,815           | Rp 402,609             | Rp 624,306.96           |
|    | E,5-F,5       | 4.16    | 4.16            | m2     | Rp 107,578              | Rp 166,815           | Rp 447,522             | Rp 693,952.42           |
|    | E,5-E,6       | 5.4975  | 5.4975          | m2     | Rp 107,578              | Rp 166,815           | Rp 591,407             | Rp 917,068.13           |
|    | F,5-F,6       | 6.825   | 6.825           | m2     | Rp 107,578              | Rp 166,815           | Rp 734,216             | Rp 1,138,515.69         |
|    | D,6-F,6       | 9.9125  | 9.9125          | m2     | Rp 107,578              | Rp 166,815           | Rp 1,066,362           | Rp 1,653,558.50         |
|    | F,6-F,7.1     | 11.0175 | 11.0175         | m2     | Rp 107,578              | Rp 166,815           | Rp 1,185,235           | Rp 1,837,889.62         |
|    | D,6-D,7.1     | 6.5715  | 6.5715          | m2     | Rp 107,578              | Rp 166,815           | Rp 706,946             | Rp 1,096,227.97         |
|    | D,7.1-F,7.1   | 9.55    | 9.55            | m2     | Rp 107,578              | Rp 166,815           | Rp 1,027,365           | Rp 1,593,087.89         |
|    | F,7-E,7       | 2.834   | 2.834           | m2     | Rp 107,578              | Rp 166,815           | Rp 304,875             | Rp 472,755.09           |
|    | E,7-E,7.1     | 3.51    | 3.51            | m2     | Rp 107,578              | Rp 166,815           | Rp 377,597             | Rp 585,522.36           |
|    | F,7.1-F,9     | 11.0175 | 11.0175         | m2     | Rp 107,578              | Rp 166,815           | Rp 1,185,235           | Rp 1,837,889.62         |
|    | F,9-D,9       | 7.4825  | 7.4825          | m2     | Rp 107,578              | Rp 166,815           | Rp 804,949             | Rp 1,248,196.87         |
|    | C1,6-A,6      | 6.40625 | 6.40625         | m2     | Rp 107,578              | Rp 166,815           | Rp 689,168             | Rp 1,068,661.71         |
|    | A,6-A,8       | 7.745   | 7.745           | m2     | Rp 107,578              | Rp 166,815           | Rp 833,188             | Rp 1,291,985.94         |
|    | C1,6-C1,8     | 13.959  | 13.959          | m2     | Rp 107,578              | Rp 166,815           | Rp 1,501,674           | Rp 2,328,577.37         |
|    | A,8-C1,8      | 9.6175  | 9.6175          | m2     | Rp 107,578              | Rp 166,815           | Rp 1,034,627           | Rp 1,604,347.94         |
|    | A,7-B,7       | 7.8     | 7.8             | m2     | Rp 107,578              | Rp 166,815           | Rp 839,105             | Rp 1,301,160.79         |
|    | A1,8-A1,9.1   | 7.605   | 7.605           | m2     | Rp 107,578              | Rp 166,815           | Rp 818,127             | Rp 1,268,631.77         |
|    | A1,9.1-B,9.1  | 7.605   | 7.605           | m2     | Rp 107,578              | Rp 166,815           | Rp 818,127             | Rp 1,268,631.77         |
|    |               |         |                 |        | <b>Subtotal</b>         |                      | <b>Rp 26,886,656</b>   | <b>Rp 41,691,902.49</b> |
|    | Lantai 2      |         |                 |        |                         |                      |                        |                         |
|    | C,1-C,4       | 15.018  | 15.018          | m2     | Rp 107,578              | Rp 166,815           | Rp 1,615,599           | Rp 2,505,234.97         |
|    | C,1-F,1       | 15.073  | 15.073          | m2     | Rp 107,578              | Rp 166,815           | Rp 1,621,516           | Rp 2,514,409.82         |
|    | F,1-F,4       | 24.318  | 24.318          | m2     | Rp 107,578              | Rp 166,815           | Rp 2,616,070           | Rp 4,056,618.99         |
|    | F,4-C,4       | 15.396  | 15.396          | m2     | Rp 107,578              | Rp 166,815           | Rp 1,656,263           | Rp 2,568,291.22         |
|    | C,1-C,4       | 15.018  | 15.018          | m2     | Rp 107,578              | Rp 166,815           | Rp 1,615,599           | Rp 2,505,234.97         |
|    | C,1-F,1       | 15.073  | 15.073          | m2     | Rp 107,578              | Rp 166,815           | Rp 1,621,516           | Rp 2,514,409.82         |
|    | F,1-F,4       | 24.318  | 24.318          | m2     | Rp 107,578              | Rp 166,815           | Rp 2,616,070           | Rp 4,056,618.99         |
|    | F,4-C,4       | 15.396  | 15.396          | m2     | Rp 107,578              | Rp 166,815           | Rp 1,656,263           | Rp 2,568,291.22         |
|    | D,4-D,5       | 6.679   | 6.679           | m2     | Rp 107,578              | Rp 166,815           | Rp 718,510             | Rp 1,114,160.63         |
|    | F,4-F,5       | 7.6428  | 7.6428          | m2     | Rp 107,578              | Rp 166,815           | Rp 822,193             | Rp 1,274,937.40         |
|    | D5,F5         | 11.3098 | 11.3098         | m2     | Rp 107,578              | Rp 166,815           | Rp 1,216,680           | Rp 1,886,649.78         |
|    | E,4-E,4.1     | 4.7864  | 4.7864          | m2     | Rp 107,578              | Rp 166,815           | Rp 514,909             | Rp 798,445.64           |
|    | F,4.1-E,4.1   | 4.749   | 4.749           | m2     | Rp 107,578              | Rp 166,815           | Rp 510,886             | Rp 792,206.74           |

| No | Pekerjaan   | Volume   | Volume Hitungan | Satuan | Harga Satuan Yogyakarta | Harga Satuan Jakarta | Harga Total Yogyakarta | Harga Total Jakarta |
|----|---|----------|-----------------|--------|-------------------------|----------------------|------------------------|---------------------|
|    | C,4-C,6   | 12.7336  | 12.7336         | m2     | Rp 107,578              | Rp 166,815           | Rp 1,369,849           | Rp 2,124,161.67     |
|    | C,9-D,9   | 4.6452   | 4.6452          | m2     | Rp 107,578              | Rp 166,815           | Rp 499,719             | Rp 774,891.30       |
|    | F,6-D2,6  | 7.1796   | 7.1796          | m2     | Rp 107,578              | Rp 166,815           | Rp 772,363             | Rp 1,197,668.46     |
|    | F,6-F,7.1   | 13.0854  | 13.0854         | m2     | Rp 107,578              | Rp 166,815           | Rp 1,407,695           | Rp 2,182,847.36     |
|    | F,7.1-D2,7.1  | 7.606    | 7.606           | m2     | Rp 107,578              | Rp 166,815           | Rp 818,234             | Rp 1,268,798.59     |
|    | D2,7.1-D2,6   | 11.2416  | 11.2416         | m2     | Rp 107,578              | Rp 166,815           | Rp 1,209,343           | Rp 1,875,272.97     |
|    | D,2.6-D,6   | 4.9794   | 4.9794          | m2     | Rp 107,578              | Rp 166,815           | Rp 535,671             | Rp 830,641.03       |
|    | D,6-D,7   | 6.9689   | 6.9689          | m2     | Rp 107,578              | Rp 166,815           | Rp 749,697             | Rp 1,162,520.44     |
|    | D2,7.1-D,7  | 2.4408   | 2.4408          | m2     | Rp 107,578              | Rp 166,815           | Rp 262,575             | Rp 407,163.24       |
|    | D2,7.1  | 4.1688   | 4.1688          | m2     | Rp 107,578              | Rp 166,815           | Rp 448,469             | Rp 695,420.40       |
|    | D2,8-D,8  | 5.3268   | 5.3268          | m2     | Rp 107,578              | Rp 166,815           | Rp 573,044             | Rp 888,592.73       |
|    | D,7.1-D,8   | 4.1688   | 4.1688          | m2     | Rp 107,578              | Rp 166,815           | Rp 448,469             | Rp 695,420.40       |
|    | C1,6-A,6  | 8.1905   | 8.1905          | m2     | Rp 107,578              | Rp 166,815           | Rp 881,114             | Rp 1,366,302.24     |
|    | A,6-A,8   | 10.49    | 10.49           | m2     | Rp 107,578              | Rp 166,815           | Rp 1,128,488           | Rp 1,749,894.45     |
|    | C1,6-C1,8   | 16.0596  | 16.0596         | m2     | Rp 107,578              | Rp 166,815           | Rp 1,727,652           | Rp 2,678,989.98     |
|    | A,8-C1,8  | 14.6294  | 14.6294         | m2     | Rp 107,578              | Rp 166,815           | Rp 1,573,794           | Rp 2,440,410.47     |
|    | A1,8-A1,9.1   | 7.605    | 7.605           | m2     | Rp 107,578              | Rp 166,815           | Rp 818,127             | Rp 1,268,631.77     |
|    | A1,9-C,9  | 10.2175  | 10.2175         | m2     | Rp 107,578              | Rp 166,815           | Rp 1,099,173           | Rp 1,704,437.23     |
|    | C,8-C,9   | 3.66     | 3.66            | m2     | Rp 107,578              | Rp 166,815           | Rp 393,734             | Rp 610,544.68       |
|    | F,9-D,9   | 7.4825   | 7.4825          | m2     | Rp 107,578              | Rp 166,815           | Rp 804,949             | Rp 1,248,196.87     |
|    | F,7.1-F,9   | 11.0175  | 11.0175         | m2     | Rp 107,578              | Rp 166,815           | Rp 1,185,235           | Rp 1,837,889.62     |
|    | D,8-D,9   | 3.66     | 3.66            | m2     | Rp 107,578              | Rp 166,815           | Rp 393,734             | Rp 610,544.68       |
|    |   |          |                 |        | Subtotal                |                      | Rp 37,903,200          | Rp 58,774,750.76    |
| 2  | Membuat 1 m2 plesteran beton 1PC : 3PP tebal 15mm                                 | 567.1728 | 567.1728        | m2     | Rp 37,383               | Rp 52,319            | Rp 21,202,564.07       | Rp 29,673,869.48    |
| 3  | Membuat 1 m2 acian  | 567.1728 | 567.1728        | m2     | Rp 20,750               | Rp 31,975            | Rp 11,768,836          | Rp 18,135,350.28    |
| 4  | Pekerjaan Pengecatan Tembok Dalam (1 Ip Plamir, 1 Ip Cat Dasar, 2 Ip Cat Penutup) | 352.2448 | 352.2448        | m2     | Rp 22,477               | Rp 34,905            | Rp 7,917,230           | Rp 12,294,928.62    |
| 5  | Pekerjaan Pengecatan Tembok Luar (1 Ip Plamir, 1 Ip Cat Dasar, 2 Ip Cat Penutup)  | 214.928  | 214.928         | m2     | Rp 26,377               | Rp 38,805            | Rp 5,669,048           | Rp 8,340,173.58     |
| 6  | Dinding keramik   | 184.984  | 184.984         | m2     | Rp 110,184              | Rp 150,042           | Rp 20,382,277          | Rp 27,755,406.32    |
| 7  | Pekerjaan Pemasangan Batu Candi Hitam   | 44.2552  | 44.2552         | m2     | Rp 264,883              | Rp 298,277           | Rp 11,722,428          | Rp 13,200,329.98    |
|    |   |          |                 |        | Subtotal                |                      | Rp 78,662,383          | Rp 109,400,058.26   |
|    | Pekerjaan Plafon Lantai 1   |          |                 |        |                         |                      |                        |                     |
| 1  | Memasang 1 m2 plafond gypsum ukuran 120x240 (tebal 9mm)                           | 157.416  | 157.416         | m2     | Rp 17,843               | Rp 46,415            | Rp 2,808,695           | Rp 7,306,463.64     |
| 2  | Lyst Gypsum plafon  | 123.27   | 123.27          | m'     | Rp 32,245               | Rp 57,055            | Rp 3,974,841           | Rp 7,033,169.85     |
| 3  | Rangka Plafon   | 157.416  | 157.416         | m2     | Rp 85,000               | Rp 165,140           | Rp 13,380,360          | Rp 25,995,678.24    |
|    |   |          |                 |        | Subtotal                |                      | Rp 20,163,896          | Rp 40,335,311.73    |
|    | Pekerjaan Plafon Lantai 2   |          |                 |        |                         |                      |                        |                     |
| 1  | Memasang 1 m2 plafond gypsum ukuran 120x240 (tebal 9mm)                           | 139.041  | 139.041         | m2     | Rp 17,843               | Rp 46,415            | Rp 2,480,839           | Rp 6,453,588.02     |
| 2  | Lyst Gypsum plafon  | 108.855  | 108.855         | m'     | Rp 32,245               | Rp 57,055            | Rp 3,510,029           | Rp 6,210,722.03     |
| 3  | Rangka Plafon   | 139.041  | 139.041         | m2     | Rp 85,000               | Rp 165,140           | Rp 11,818,485          | Rp 22,961,230.74    |

| No | Pekerjaan  | Volume   | Volume Hitungan | Satuan | Harga Satuan Yogyakarta | Harga Satuan Jakarta | Harga Total Yogyakarta | Harga Total Jakarta |
|----|--|----------|-----------------|--------|-------------------------|----------------------|------------------------|---------------------|
|    |  |          |                 |        | Subtotal                |                      | Rp 17,809,354          | Rp 35,625,540.78    |
| 1  | Pekerjaan Keramik Lantai Lantai 1<br>Keramik Lantai 30x30                                    | 152.376  | 152.376         | m2     | Rp 95,973               | Rp 133,965           | Rp 14,623,906          | Rp 20,412,989.89    |
| 2  | Keramik Lantai KM 20x20  | 5.04     | 8.952           | m2     | Rp 94,313               | Rp 129,251           | Rp 475,335             | Rp 1,157,051.37     |
|    |  |          |                 |        | Subtotal                |                      | Rp 15,099,241          | Rp 21,570,041.26    |
| 1  | Lantai 2<br>Keramik Lantai 30x30   | 130.089  | 130.089         | m2     | Rp 95,973               | Rp 133,965           | Rp 12,484,967          | Rp 17,427,320.85    |
| 2  | Keramik Lantai KM 20x20  | 8.952    | 8.952           | m2     | Rp 94,313               | Rp 129,251           | Rp 844,286             | Rp 1,157,051.37     |
|    |  |          |                 |        | Subtotal                |                      | Rp 13,329,252          | Rp 18,584,372.22    |
| 1  | Pekerjaan Pintu Jendela<br>Pekerjaan Pemasangan Pintu/Jendela Kaca Rangka Aluminium warna 4" | 77.3045  | 80.92           | m2     | Rp 241,405              | Rp 433,395           | Rp 18,661,693          | Rp 35,070,323.40    |
| 2  | Pekerjaan Pemasangan Kusen Pintu/Jendela Aluminium warna 4"                                  | 535.1324 | 535.1324        | m'     | Rp 57,808               | Rp 106,810           | Rp 30,934,666          | Rp 57,157,491.64    |
| 3  | Pekerjaan Pemasangan Kunci Kamar Mandi   | 4        | 4               | bh     | Rp 125,243              | Rp 143,768           | Rp 500,970             | Rp 575,070.00       |
| 4  | Pekerjaan Pemasangan Kunci Tanam Biasa   | 17       | 17              | bh     | Rp 185,985              | Rp 205,035           | Rp 3,161,745           | Rp 3,485,595.00     |
| 5  | Pekerjaan Pemasangan Engsel Pintu  | 181      | 181             | bh     | Rp 20,078               | Rp 43,053            | Rp 3,634,028           | Rp 7,792,502.50     |
|    |  |          |                 |        | Subtotal                |                      | Rp 56,893,102          | Rp 104,080,982.54   |
| 1  | Pekerjaan Tangga<br>Pekerjaan beton tangga K-250   | 1.84152  | 1.84152         | m3     | Rp 965,091              | Rp 1,459,257         | Rp 1,777,235           | Rp 2,687,250.95     |
| 2  | Pekerjaan Pembesian tangga K-250   | 194.8172 | 194.81724       | kg     | Rp 150,290              | Rp 173,475           | Rp 29,279,083          | Rp 33,795,920.17    |
| 3  | Keramik tangga   | 11.16    | 11.16           | m2     | Rp 95,973               | Rp 133,965           | Rp 1,071,053           | Rp 1,495,044.94     |
| 4  | Bekisting Tangga   | 42.14    | 42.14           | m2     | Rp 276,370              | Rp 396,445           | Rp 11,646,211          | Rp 16,706,192.30    |
| 5  | Keramik Stepnozing   | 0.27     | 0.27            | m2     | Rp 119,337              | Rp 121,336           | Rp 32,221              | Rp 32,760.62        |
|    |  |          |                 |        | subtotal                |                      | Rp 43,805,803          | Rp 54,717,168.98    |
| 1  | Pekerjaan rangka atap dan penutup atap<br>Pekerjaan profil baja                              | 2684.473 | 2684.4734       | kg     | Rp 25,195               | Rp 29,500            | Rp 67,635,307          | Rp 79,191,964.42    |
| 2  | Pekerjaan Pemasangan Konstruksi Gording, Kayu Klas II  | 0.88172  | 0.88172         | m3     | Rp 6,820,980            | Rp 11,798,200        | Rp 6,014,194           | Rp 10,402,708.90    |
| 3  | Pekerjaan Pemasangan Listplank ukuran 3x20cm, Kayu Klas I/II                                 | 78.6     | 78.6            | m'     | Rp 349,825              | Rp 283,430           | Rp 27,496,229          | Rp 22,277,613.72    |
| 4  | Pekerjaan Pemasangan Nok/Jurai Kayu Bengkirai 8/12cm   | 0.0576   | 0.0576          | m3     | Rp 6,348,100            | Rp 11,918,600        | Rp 365,651             | Rp 686,511.36       |
| 5  | Pekerjaan Pemasangan Ruitter Kayu Bengirai 2/20cm  | 0.0452   | 0.0452          | m3     | Rp 70,923               | Rp 74,583            | Rp 3,206               | Rp 3,371.15         |
| 6  | Pekerjaan Pemasangan Genteng Kaca  | 4.2      | 4.2             | m2     | Rp 253,405              | Rp 264,140           | Rp 1,064,301           | Rp 1,109,388.00     |
| 7  | Pekerjaan Pemasangan Genteng Keramik   | 146.84   | 146.84          | m2     | Rp 181,405              | Rp 192,140           | Rp 26,637,510          | Rp 28,213,837.60    |
|    |  |          |                 |        | Subtotal                |                      | Rp 129,216,398         | Rp 141,885,395.15   |
|    |  |          |                 |        | Total                   |                      | Rp 2,560,240,314       | Rp 4,135,799,248.10 |

Lampiran 5.1 Analisis Harga Satuan

