

BAB VI

KESIMPULAN

6.1. Kesimpulan

Hasil akhir yang didapatkan oleh peneliti pada penelitian perancangan dan pembuatan mesin penyaring bubur kedelai dengan prinsip ayun adalah mendapatkan sebuah unit mesin penyaring dengan dimensi 1950 mm x 1000 mm x 3026 mm, sehingga dapat berguna untuk meningkatkan kualitas dan kuantitas dari proses penyaringan bubur kedelai. Mesin dapat memproduksi sari kedelai dua kali lipat dari hasil penggunaan alat tradisional. Hasil ini menunjukkan kapasitas output mesin dapat meningkatkan hasil produksi dan membuat efektif waktu produksi. Hasil pengulangan proses produksi menunjukkan keseragaman output dari segi kuantitas dan kualitas.

Pengoperasian mesin yang mudah, kemudahan dalam loading bahan baku dan unloading produk, tidak ada pengaruh faktor waktu dan beban kerja, sehingga menjadikan hal ini sebagai beberapa fitur dari mesin ini. Sifat mesin yang semi permanen membuat mesin bisa dipindah untuk penataan layout. Perawatan yang mudah menjadi salah satu fitur dari mesin ini, hanya perlu mengecek belt saja untuk *maintenance preventif* dan *maintenance* berkala untuk pengecekan motor serta elemen lainnya.

Konstruksi mesin diperhitungkan dengan baik sehingga dapat dipakai hingga jangka waktu 5 tahun ke depan atau bahkan bisa lebih dari 5 tahun.

Rancangan mesin yang dihasilkan dari penelitian ini memiliki spesifikasi sebagai berikut :



Gambar 6.1. Gambar Akhir Mesin Penyaring Bubur Kedelai
(Sumber : *Software SolidWorks 2010*)

Tabel 6.1. Spesifikasi Mesin

Spesifikasi Mesin	
Dimensi Mesin	1950 x 1000 x 3026
Frames	Profil C dengan tebal 10 mm (kanal)
Transimisi	<i>Pulley dan belt</i>
Konversi gerakan	Sistem engkol eksentris
Harga Mesin	Rp 10.548.300,00

6.2. Saran

Mesin penyaring bubur kedelai ini sudah mampu memenuhi tuntutan dan permintaan dari *home industry* Kembang Tahu, namun mesin ini masih dapat

disempurnakan lagi dengan menambahkan scrub pengaduk atau *roller* pengaduk agar lebih maksimal dalam proses penyaringannya karena scrub atau *roller* akan menyapu pori-pori penyaring dan menekan ampas bubuk sehingga sari akan lebih cepat tersaring dan mengalir ke bak penampung. Mesin ini juga masih dapat dipasang panel *box* dan timer sebagai pengontrol.



DAFTAR PUSTAKA

- Cross, Nigel. 1994, *Engineering Design Methods, Second Edition*, John Willey & Sons.
- Giancoli, D.C. 1996, Fisika Dasar (terjemahan Imawan, M.S.), ed. 4, Erlangga : Jakarta
- Mulyana, Jaka.Ig. Santosa, Hadi. M.L., dan Prasetya, Wahyu. (2013). Perancangan alat penyaringan dalam proses pembuatan tahu. (jurnal). Universitas Katolik Widya Mandala, Surabaya.
- Niemann, G. 1986, Elemen Mesin, (terjemahan Budiman, Anton., dan Priambodo, Bambang.). Erlangga : Jakarta.
- Nikus, Andro. (2012). Perancangan alat penyaring tahu berdasarkan prinsip ergonomi. (skripsi). Program Studi Teknik Industri, Fakultas Teknik Industri, Sekolah Tinggi Teknologi Dumai, Dumai.
- Radi, N. (2004). Perancangan alat penyaring tahu sentrifugal. (skripsi). Program Studi Teknik Industri, Fakultas Teknik Industri, Universitas Gajah Mada, Yogyakarta.
- Raditya, Felix. Dan Yuniarto, Tonny. (2015). "Perancangan mesin penyaring bubur kedelai dengan prinsip ayun di *home industry* tahu kembang", *Prosiding Seminar Nasional Perkembangan Riset dan Teknologi di Bidang Industri ke 21 UGM*, ISBN: 978-602-70455-1-4, pg 13-18.
- Stolk, Jac. dan Kros, C. (1994). Elemen mesin elemen konstruksi bangunan mesin. (Ed. 21). Erlangga : Jakarta.
- Sularso ; Suga, Kiyokatsu. 2002, Dasar Perencanaan Dan Pemilihan Elemen Mesin, Pradnya Paramita : Jakarta.

Induction Motors

60 W

Frame Size: □90 mm



Specifications – Continuous Rating

Model		Output Power	Voltage	Frequency	Current	Starting Torque	Rated Torque	Rated Speed	Capacitor
Upper Model Name: Pinion Shaft Type	Lower Model Name(): Round Shaft Type	W	VAC	Hz	A	mN · m gfcm	mN · m gfcm	r/min	μF
(TP) 5IK60GU-AWU (5IK60A-AWU)	5IK60GU-AWTU (5IK60A-AWTU)	60	Single-Phase 110	60	1.09	320	405	1450	18
			Single-Phase 115		1.10	3200	4050		
(TP) 5IK60GU-CWE (5IK60A-CWE)	5IK60GU-CWTE (5IK60A-CWTE)	60	Single-Phase 220	50	0.55	490	490	1200	4
				60	0.54	405	4050	1450	
			Single-Phase 230	50	0.57	490	4900	1200	
				60	0.54	405	4050	1450	



Lampiran 2. Tabel Reducer Oriental Motor

◇ 50 Hz

Unit=Upper values: N · m/Lower values: kgfcm

Model Motor/ Gearhead	Speed r/min	Unit=Upper values: N · m/Lower values: kgfcm																			
		500	416	300	250	200	166	120	100	83	60	50	41	30	25	20	16	15	12.5	10	8.3
	Gear Ratio	3	3.6	5	6	7.5	9	12.5	15	18	25	30	36	50	60	75	90	100	120	150	180
5IK60GU-CWE / 5GU□KB	1.2	1.4	2.0	2.4	3.0	3.6	4.5	5.4	6.4	8.1	9.7	11.6	16.2	19.4	20	20	20	20	20	20	20
5IK60GU-CWTE / 5GU□K	12	14	20	24	30	36	45	54	64	81	97	116	162	194	200	200	200	200	200	200	200
5IK60GU-SW / 5GU□KB	1.1	1.3	1.8	2.2	2.7	3.3	4.1	4.9	5.9	7.4	8.9	10.7	14.9	17.8	19.9	20	20	20	20	20	20
5IK60GU-SWT / 5GU□K	11	13	18	22	27	33	41	49	59	74	89	107	149	178	199	200	200	200	200	200	200

Det. B
Sc. 1:5

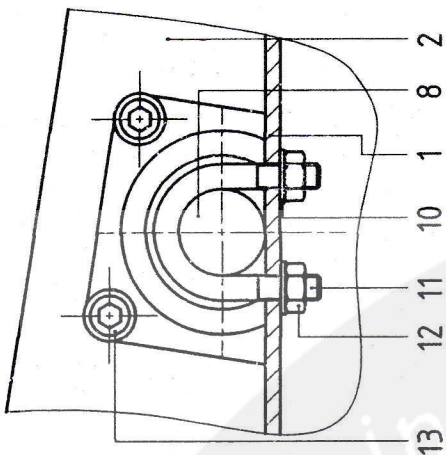

Det. A
Sc. 1:2

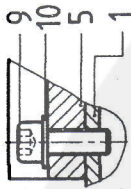

Sec. C-C
Sc. 1:2

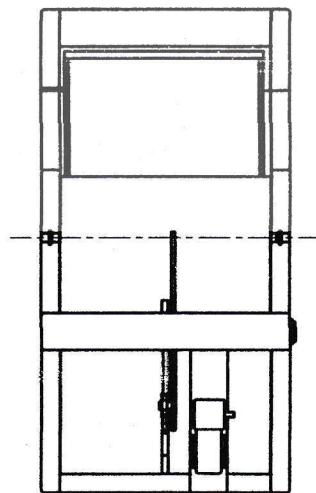
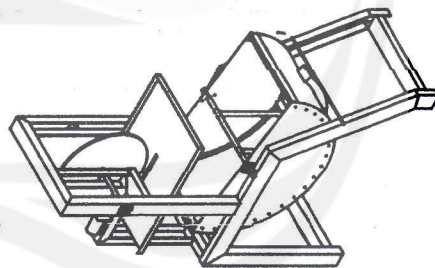
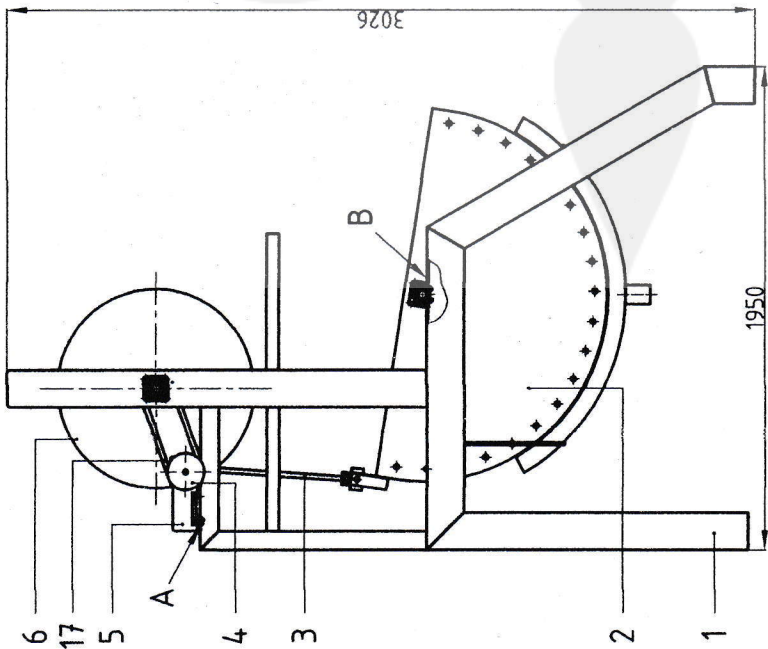
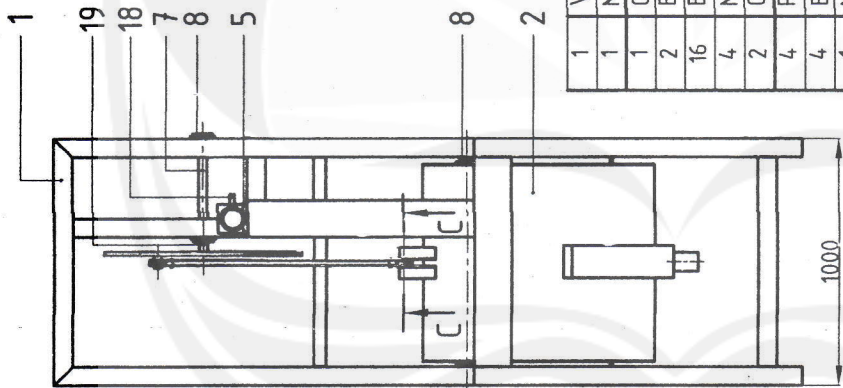
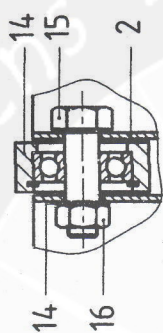

Qty	Description	Item	Material
1	V-Belt type B	17	-
1	Nut M12	16	Purchased
1	Conector	15	Purchased
2	Bearing for Stick	14	Purchased
16	Bolt + nut + ring M10	13	Purchased
4	Nut M10	12	Purchased
2	Clamping Shaft	11	Purchased
4	Ring M10	10	Purchased
4	Bolt M10x20	9	Purchased
1	Main Shaft	8	MS
1	Shaft for Disc	7	MS
1	Disc	6	MS
1	Motor + Reducer	5	-
2	Wheel Pulley	4	Purchased
1	Stick	3	St. 60
1	Bowl	2	-
1	Frame	1	-

Down.	19.05.15	Felix	Scale	Hard. HRc	Item
			1:20		
Title					
Mesin Penyaring Bubur Kedelai					
Detail of:					

6	Seegering $\phi 35$	19	-	Purchased
1	Seegering $\phi 30$	18	-	Purchased

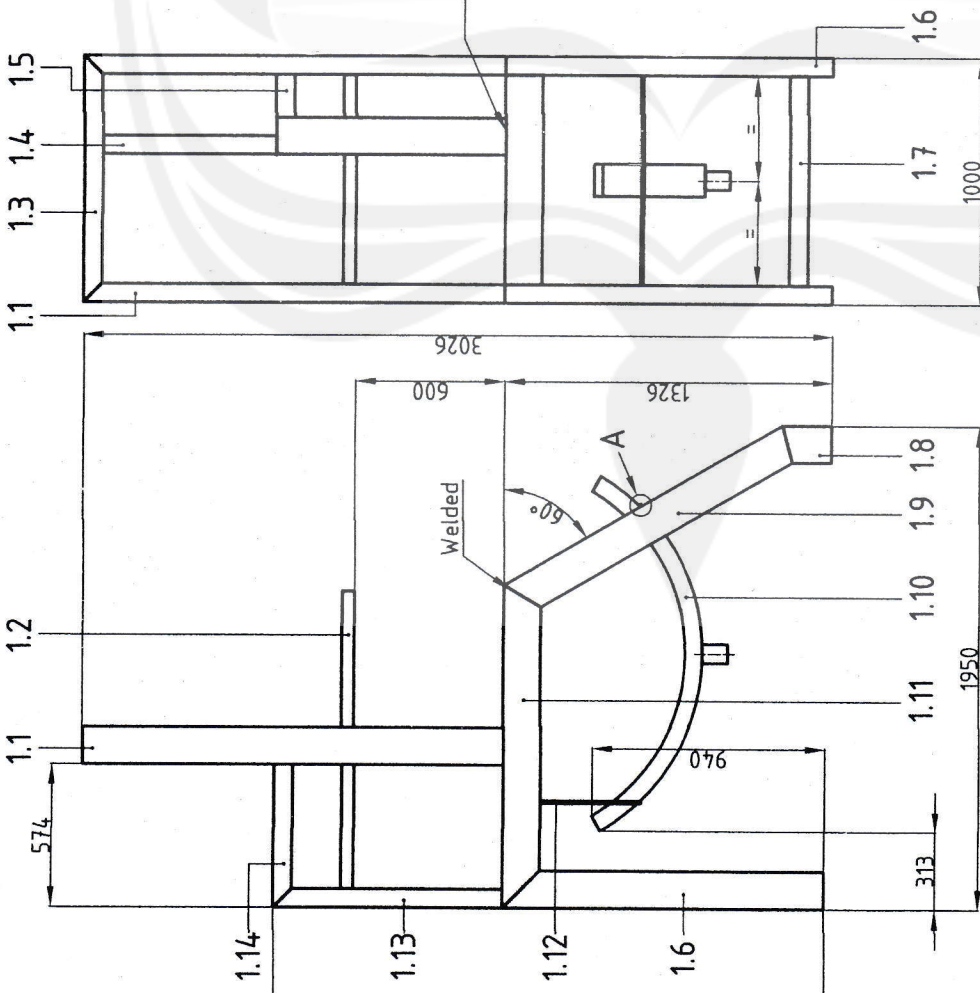

Det. A
Sc. 1:1

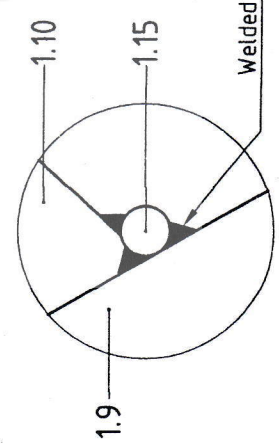

All join should be welded

Qty	Description	Description				Dwn.	22.05.15	Item	Material	Scale	Hard. HRC	Item
Num	6	+30	+100	+400	+1000				1:20			
Tol. ±	0.1	0.2	0.3	0.5	0.8	1.2						
Num	+10	+50	+100	+200	+400							
Qty ±	1°	30'	20'	0'	0.3							
	1.7	0.5	0.6	0.3								
1	Guide Outlet 2	1.15	St.St	Ø10	-							
1	Base Motor 2	1.14	C profile	150x75	-							
1	Stand Motor	1.13	C profile	150x75	-							
1	Guide Outlet 1	1.12	St.St	Ø10	-							
1L/1R	Horizontal	1.11	C profile	150x75	-							
1	Outlet	1.10	-	-	-							
1L/1R	Front Stand 2	1.9	C profile	150x75	-							
1L/1R	Front Stand 1	1.8	C profile	150x75	-							
3	Base Hub	1.7	C profile	150x75	-							
1L/1R	Stand	1.6	C profile	150x75	-							
1	Base Motor 1	1.5	C profile	150x75	-							
1	Stand Wheel	1.4	C profile	150x75	-							
1	Upper Hub	1.3	C profile	150x75	-							
1	Cover	1.2	St.St.	Sheet 1.0	-							
1L/1R	Upper Stand	1.1	C profile	150x75	-							

Title
Frame

Detail of: Mesin Penyaring Bubur Kedelai

Univ. ATMA JAYA YOGYAKARTA

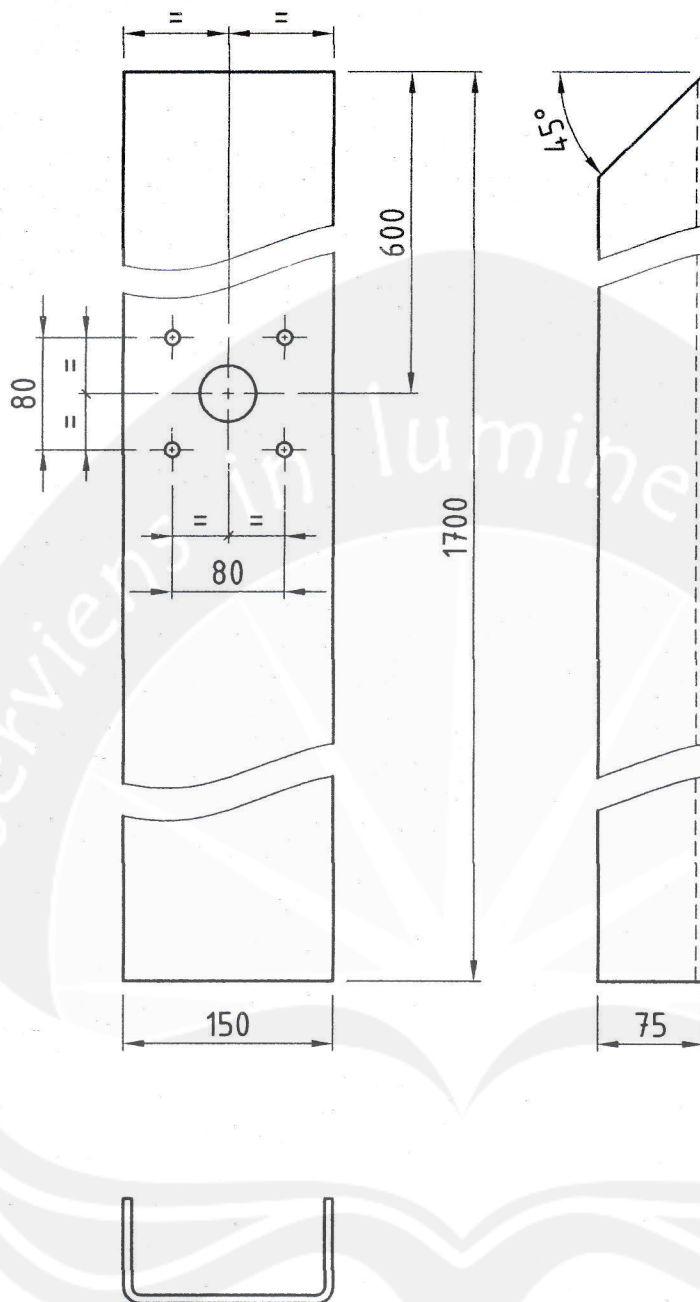

1L/1R		Upper Stand					1.1	C profile 150x75		-	
Qty		Description					Item	Material			
Nom.	0.5 6	>6 30	>30 120	>120 400	>400 1000	>1000 2000	Dwn. 22.05.15	Felix	Scale	Hard. HRC	Item
Tol. ±	0.1	0.2	0.3	0.5	0.8	1.2		1:5		1	
Nom.	<10	>10 50	>50 120	>120 400			Title		Upper Stand		
Deg. ±	1°	30'	20'	10'			Detail of: Mesin Penyaring Bubur Kedelai				
1000 ±	1.7	0.9	0.6	0.3			Univ. ATMA JAYA YOGYAKARTA				

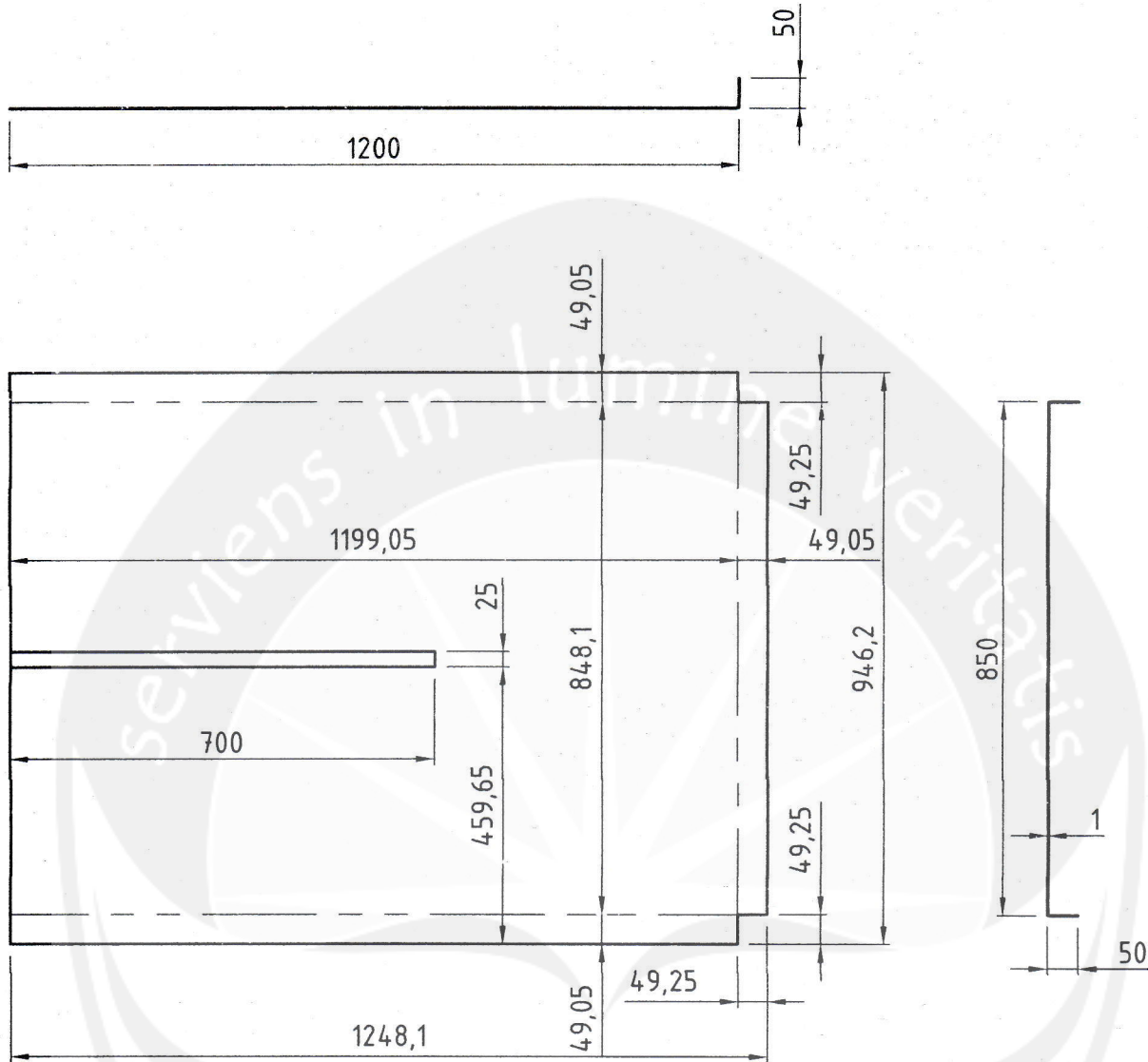

1		Cover					1.2	St.St. sheet 1,0	-			
Qty		Description					Item	Material				
Nom.	0.5 6	>6 30	>30 120	>120 400	>400 1000	>1000 2000	Dwn. 27.05.15	Felix	Scale	Hard. HRC	Item	
Tol. ±	0.1	0.2	0.3	0.5	0.8	1.2		1:10		1		
Nom.	>10	>10 50	>50 120	>120 400			Title					
Deg. ±	1°	30'	20'	10'	Cover							
1/100 ±	1.7	0.9	0.6	0.3	Detail of: Mesin Penyaring Bubur Kedelai							
Univ. ATMA JAYA YOGYAKARTA												

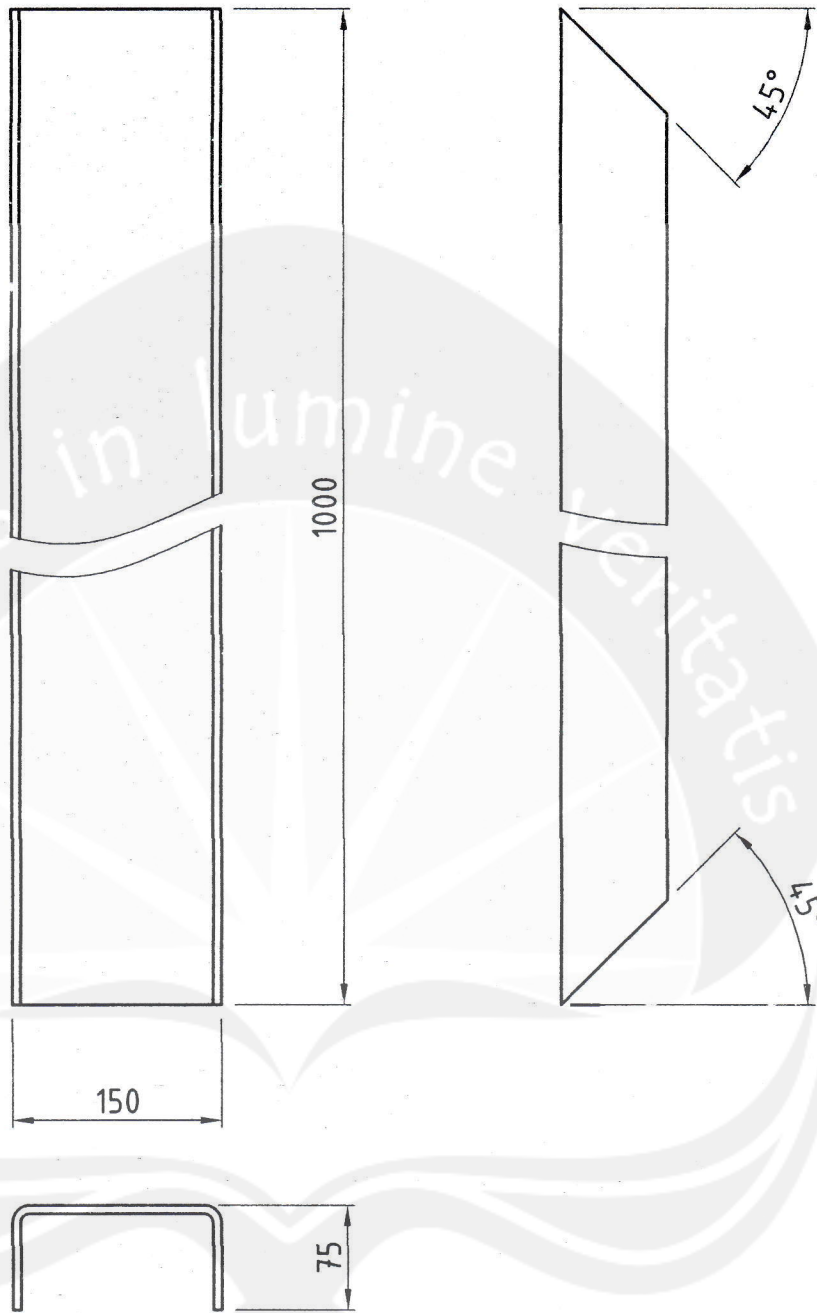

1		Upper Hub					1.3	C profile 150x75		-	
Qty		Description					Item	Material			
Nom.	0.5 6	>6 30	>30 120	>120 400	>400 1000	>1000 2000	Dwn. 27.05.15	Felix	Scale	Hard. HRC	Item
Tol. ±	0.1	0.2	0.3	0.5	0.8	1.2		1:5		1	
Nom.	<-10	>10 50	>50 120	>120 400			Title				
Deg. ±	1°	30'	20'	10'	Upper Hub						
100 ±	1.7	0.9	0.6	0.3	Detail of: Mesin Penyaring Bubur Kedelai						
Univ. ATMA JAYA YOGYAKARTA											

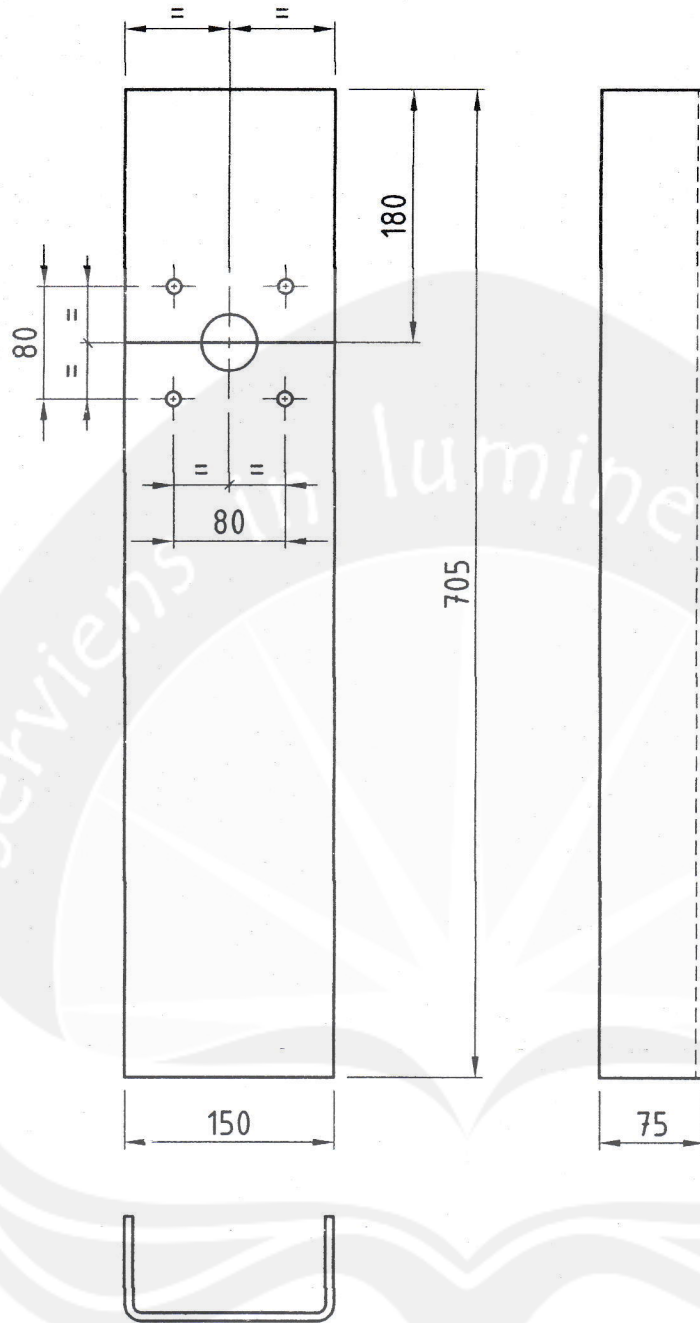

1		Stand Wheel					1.4	C profile 150x75		-	
Qty		Description					Item	Material			
Nom.	0.5 6	>6 30	>30 120	>120 400	>400 1000	>1000 2000	Dwn. 27.05.15	Felix	Scale	Hard. HRc	Item
Tol. ±	0.1	0.2	0.3	0.5	0.8	1.2		1:5			1
Nom.	-10	>10 50	>50 120	>120 400							
Deg. ±	1°	30'	20'	10'							
1/100 ±	1.7	0.9	0.6	0.3							
							Title				
							Stand Wheel				
							Detail of: Mesin Penyaring Bubur Kedelai				
							Univ. ATMA JAYA YOGYAKARTA				

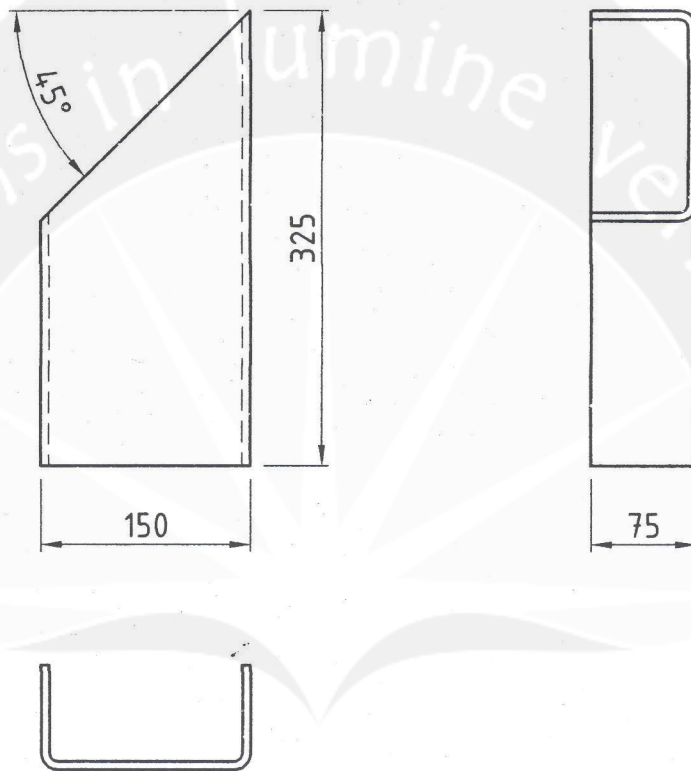

1	Base Motor 1						1.5	C profile 150x75	-		
Qty	Description						Item	Material			
Nom.	0.5 6	>6 30	>30 120	>120 400	>400 1000	>1000 2000	Dwn. 27.05.15	Felix	Scale	Hard. HRC	Item
Tol. ±	0.1	0.2	0.3	0.5	0.8	1.2		1:5			1
Nom.	<-10	>10 50	>50 120	>120 400			Title Base Motor 1				
Deg. ±	1°	30'	20'	10'							
1/100 ±	1.7	0.9	0.6	0.3	Detail of: Mesin Penyaring Bubur Kedelai						
Univ. ATMA JAYA YOGYAKARTA											

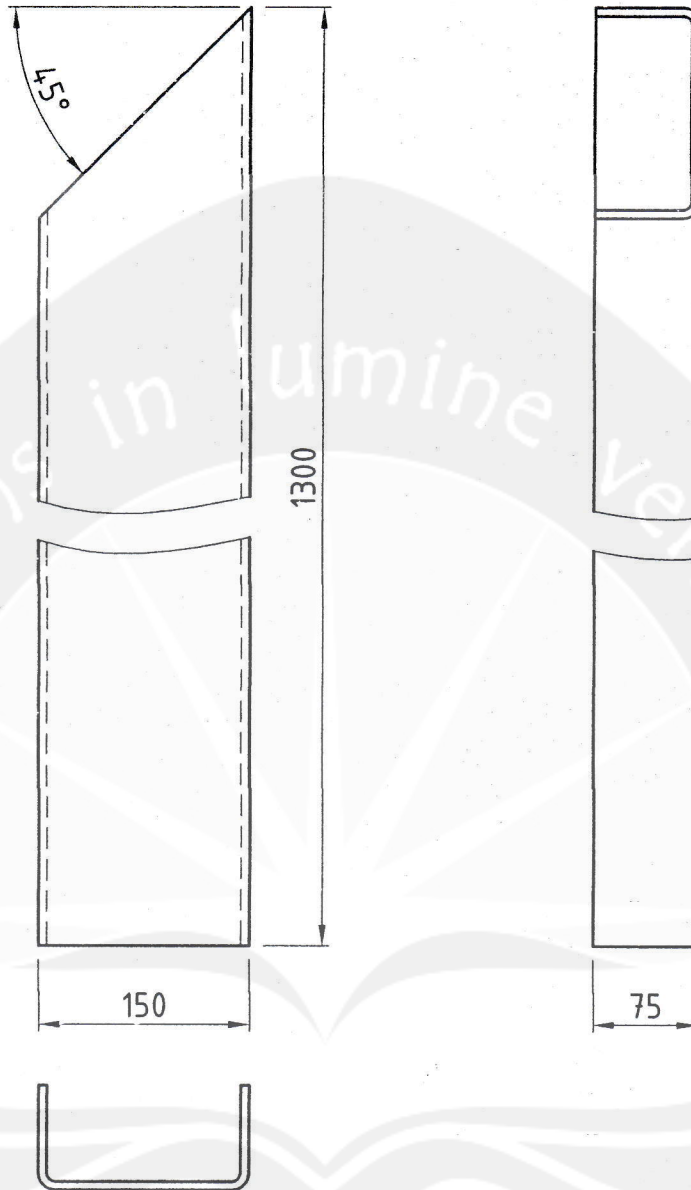

1L/1R	Stand	1.6	C profile 150x75	-							
Qty	Description	Item	Material								
Nom.	0.5 6	>6 30	>30 120	>120 400	>400 1000	>1000 2000	Dwn. 27.05.15	Felix	Scale	Hard. HRc	Item
Tol. ±	0.1	0.2	0.3	0.5	0.8	1.2		1:5		1	
Nom.	<10	>10 50	>50 120	>120 400			Title				
Deg. ±	1°	30'	20'	10'	Stand						
100 ±	1.7	0.9	0.6	0.3	Detail of: Mesin Penyaring Bubur Kedelai						
Univ. ATMA JAYA YOGYAKARTA											

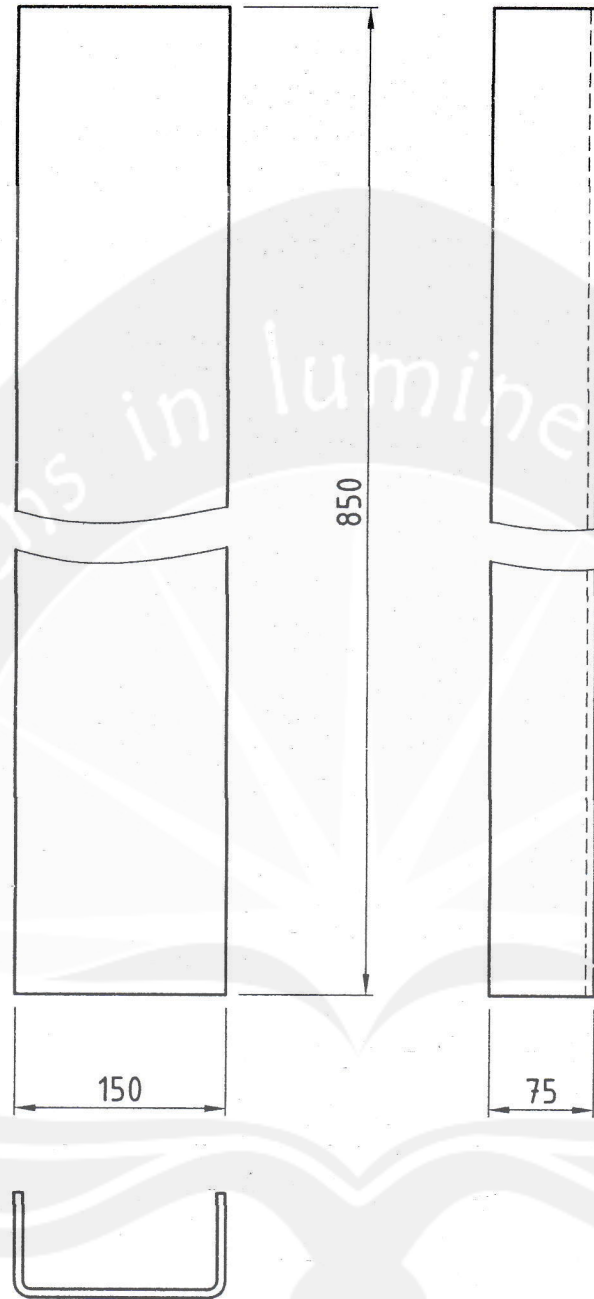

3		Base Hub					1.7	C profile 150x75		-	
Qty		Description					Item	Material			
Nom.	0.5 6	>6 30	>30 120	>120 400	>400 1000	>1000 2000	Dwn. 27.05.15	Felix	Scale	Hard. HRc	Item
Tol. ±	0.1	0.2	0.3	0.5	0.8	1.2		1:5			1
Nom.	<10	>10 50	>50 120	>120 400							
Deg. ±	1°	30'	20'	10'							
100 ±	1.7	0.9	0.6	0.3							
							Title				
							Base Hub				
							Detail of: Mesin Penyaring Bubur Kedelai				
							Univ. ATMA JAYA YOGYAKARTA				

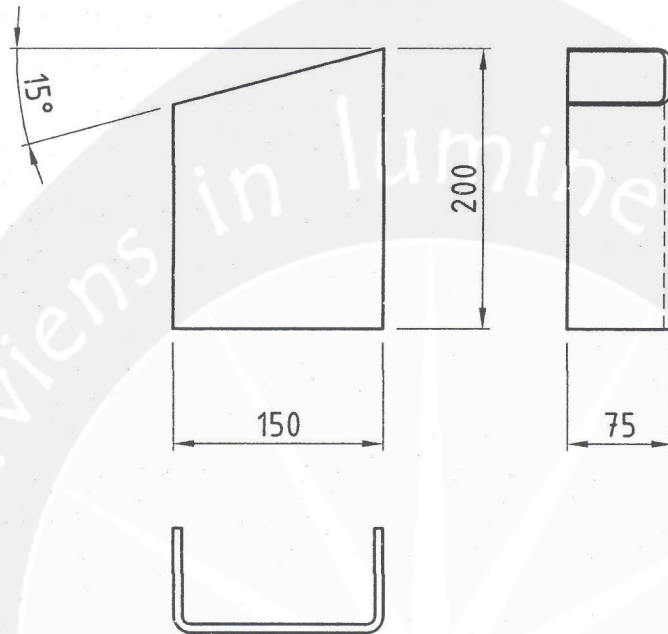

1L/1R	Front Stand 1						1.8	C profile 150x75		-	
Qty		Description					Item	Material			
Nom.	0.5 6	>6 30	>30 120	>120 400	>400 1000	>1000 2000	Dwn. 27.05.15	Felix	Scale	Hard. HRC	Item
Tol. ±	0.1	0.2	0.3	0.5	0.8	1.2		1:5			1
Nom.	<-10	>10 50	>50 120	>120 400							
Deg. ±	1°	30'	20'	10'							
1/100 ±	1.7	0.9	0.6	0.3							
							Title				
							Front Stand 1				
							Detail of: Mesin Penyaring Bubur Kedelai				
							Univ. ATMA JAYA YOGYAKARTA				

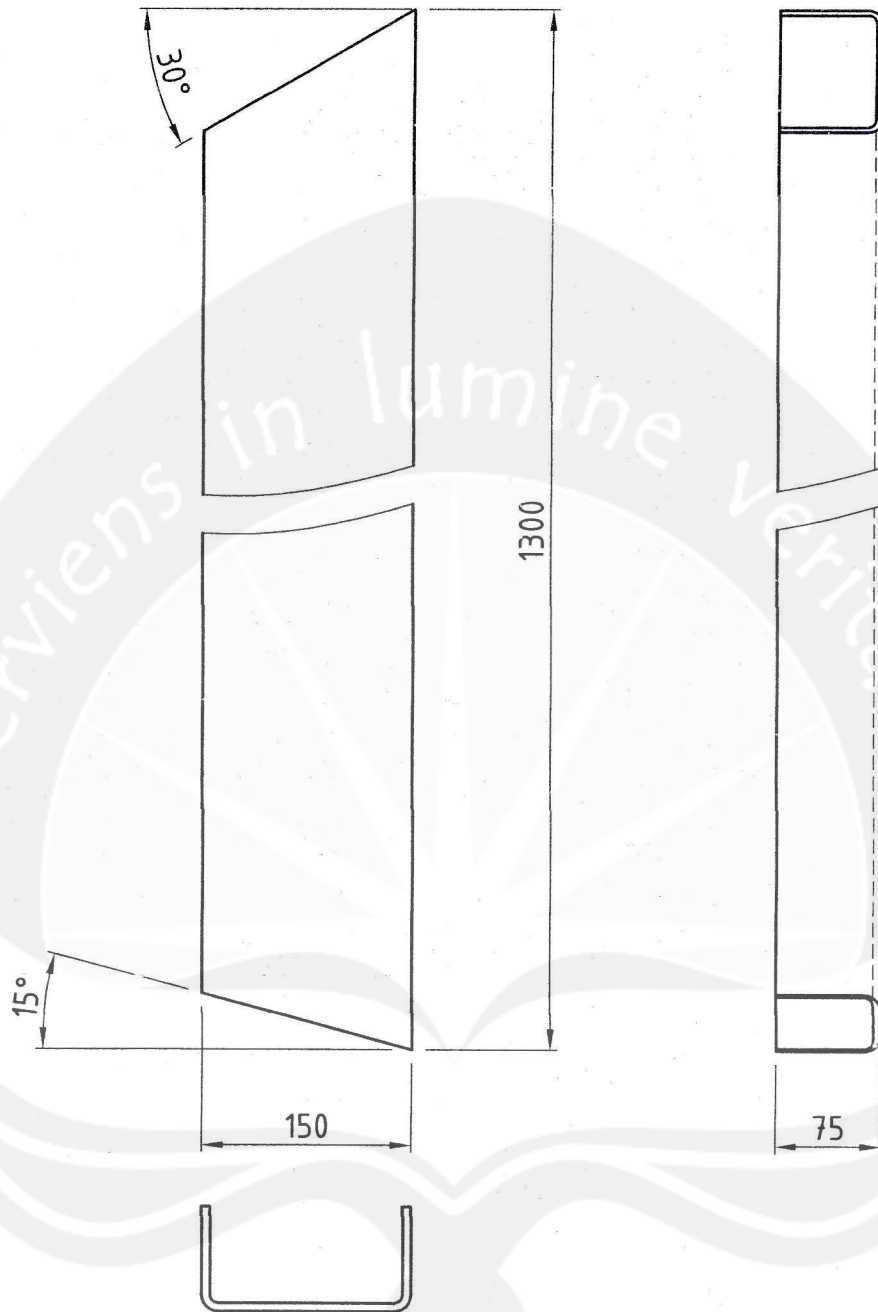

1L/1R	Front Stand 2						1.9	C profile 150x75	-
Qty	Description						Item	Material	
Nom.	0.5 6	>6 30	>30 120	>120 400	>400 1000	>1000 2000	Dwn. 27.05.15 Felix	Scale 1:5	Hard. HRC 1
Tol. ±	0.1	0.2	0.3	0.5	0.8	1.2			
Nom.	<-10	>10 50	>50 120	>120 400			Title Front Stand 2		
Deg. ±	1°	30'	20'	10'					
±	1.7	0.9	0.6	0.3	Detail of: Mesin Penyaring Bubur Kedelai				
Univ. ATMA JAYA YOGYAKARTA									

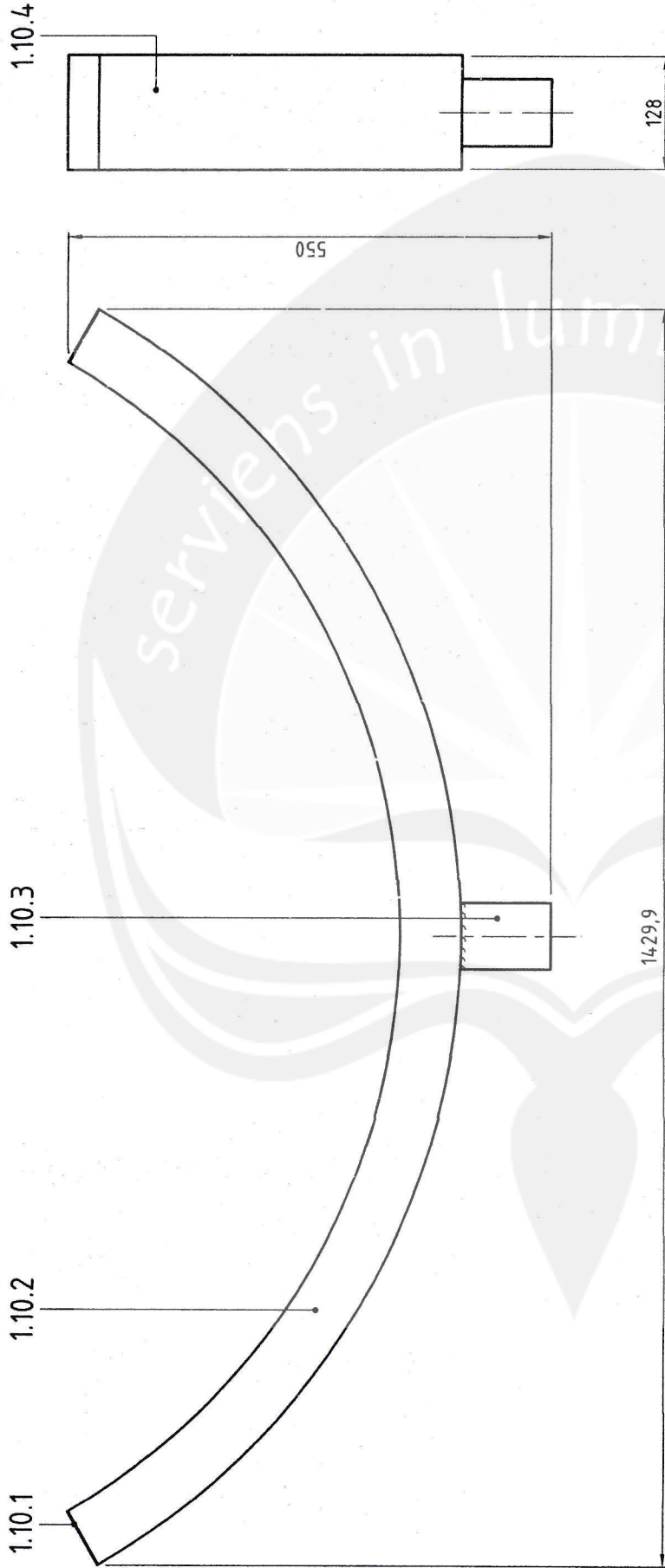

Qty	Description	Item	Material
1	Base	1.10.4	St.St. sheet 1,0
1	Pipe	1.10.3	St.St. sheet 1,0
2	Wall	1.10.2	St.St. sheet 1,0
2	Side Plate	1.10.1	St.St. sheet 1,0

Num.	0,5	+6	+30	+100	+400	+1000
Tol. ±	0,1	0,2	0,3	0,5	0,8	1,2

Num.	+10	+50	+100	+400
Dim. ±	1°	30'	20'	30'
0,05 ±	1,7	0,9	7,6	0,3

Dwn.	27.05.15	Felix	Scale	Hard. Hrc	Item
			1:5		1

Title: Outlet

Detail of: Mesin Penyaring Bubur Kedelai

Univ. ATMA JAYA YOGYAKARTA

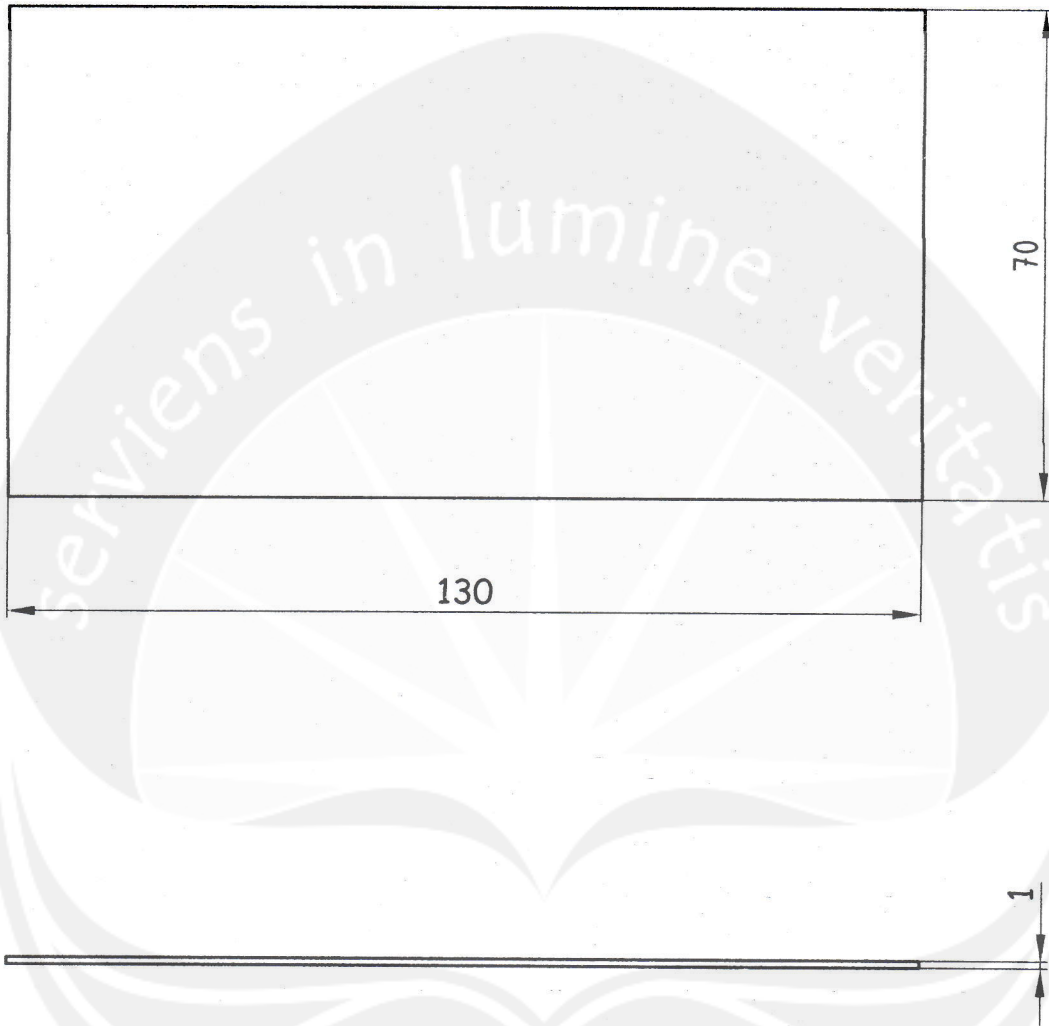

2		Side Plate					1.10.1	St.St. sheet 1,0	-		
Qty		Description					Item	Material			
Nom.	0.5 6	>6 30	>30 120	>120 400	>400 1000	>1000 2000	Dwn. 27.05.15	Felix	Scale	Hard. HRc	Item
Tol. ±	0.1	0.2	0.3	0.5	0.8	1.2		1:1		1	
Nom.	<10	>10 50	>50 120	>120 400			Title				
Deg. ±	1°	30'	20'	10'	Side Plate						
100 ±	1.7	0.9	0.6	0.3	Detail of: Mesin Penyaring Bubur Kedelai						
							Univ. ATMA JAYA YOGYAKARTA				

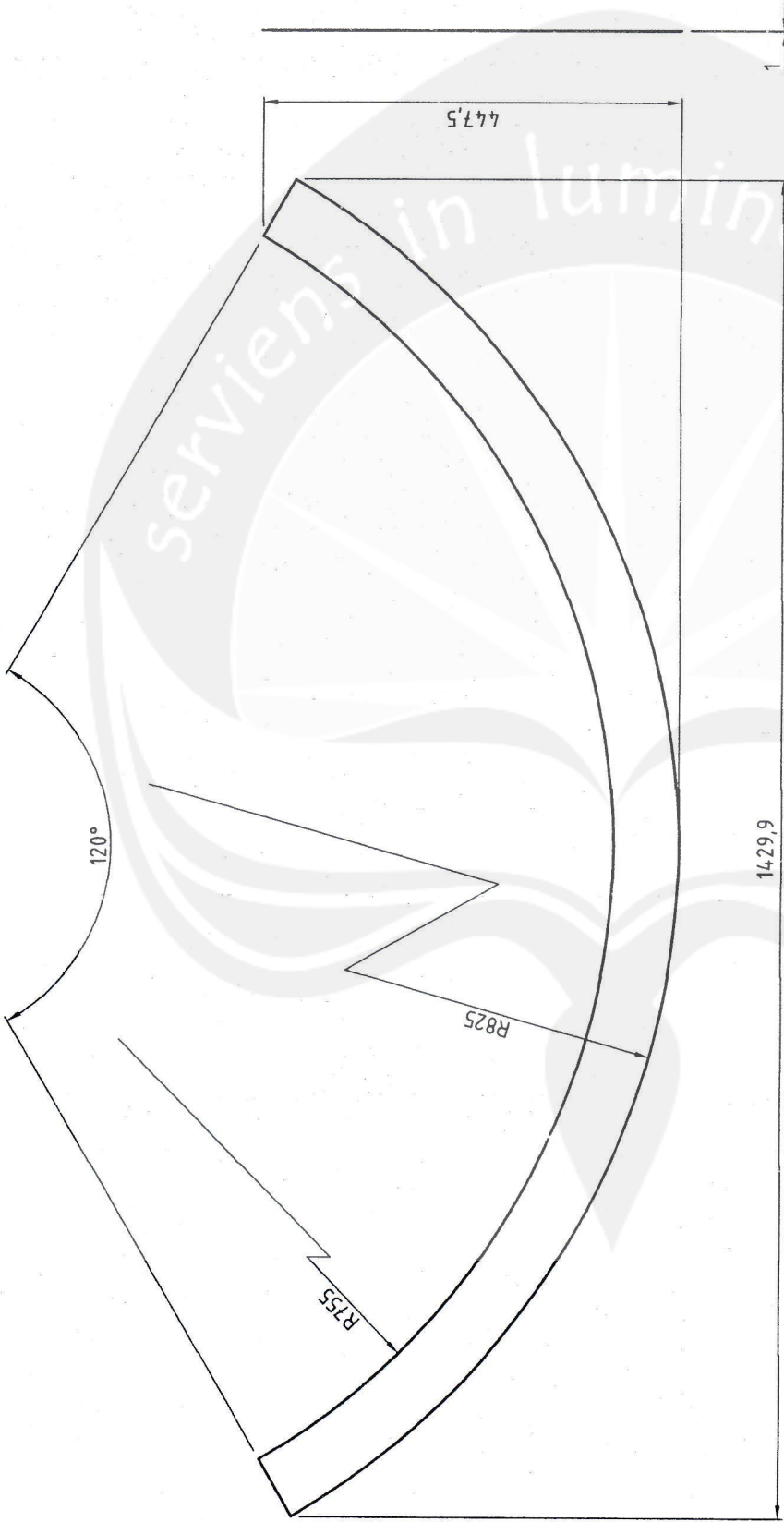

2	Wall	1.10.2	St.St. sheet 1,0	-
Qty		Item	Material	
		Dwn. 27.05.15	Felix	Scale 1:5
				Hard. HRc
				Item 1
Title Wall				
Detail of: Mesin Penyaring Bubur Kedelai				
Univ. ATMA JAYA YOGYAKARTA				

Qty	Nom.	Tol. ±	Description					
			+30	+10	+400	+1000	0	12
0,5	6	0,1	0,2	0,3	0,5	0,8	1,2	
8	26							
			+10	+50	+120	+400	+1200	
			1"	30"	70"	120"	200"	
			0,9	0,6	0,3			

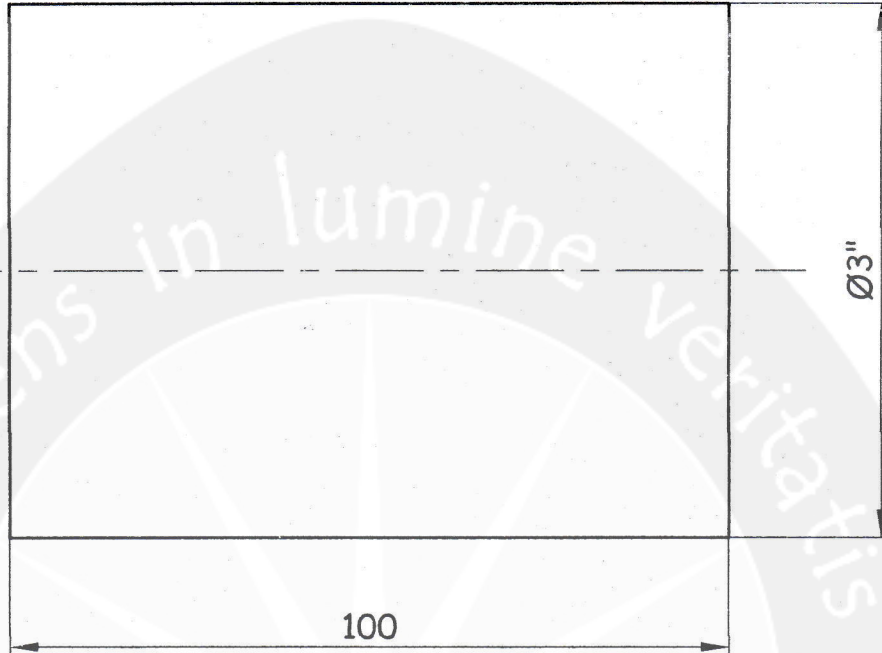

1		Pipe					1.10.3	St.St. pipe $\varnothing 3''$	-		
Qty		Description					Item	Material			
Nom.	0.5 6	>6 30	>30 120	>120 400	>400 1000	>1000 2000	Dwn. 27.05.15	Felix	Scale	Hard. HRc	Item
Tol. \pm	0.1	0.2	0.3	0.5	0.8	1.2		1:1		1	
Nom.	<10	>10 50	>50 120	>120 400			Title		Pipe		
Deg. \pm	1'	30'	20'	10'			Detail of:		Mesin Penyaring Bubur Kedelai		
$\frac{1}{100} \pm$	1.7	0.9	0.6	0.3					Univ. ATMA JAYA YOGYAKARTA		

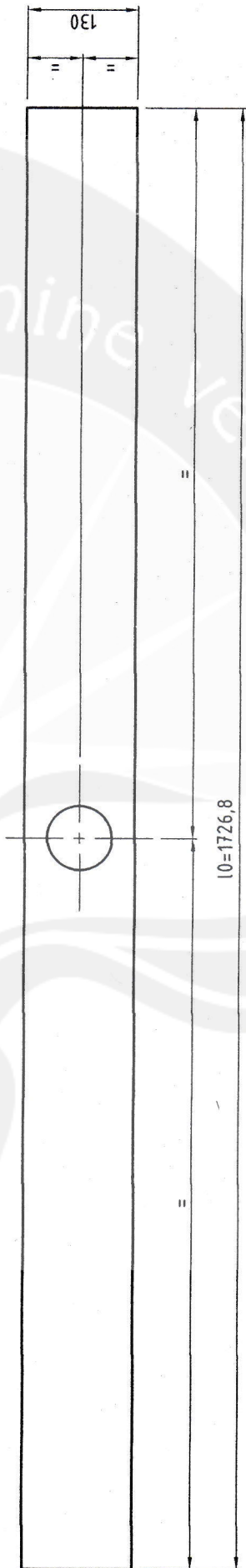
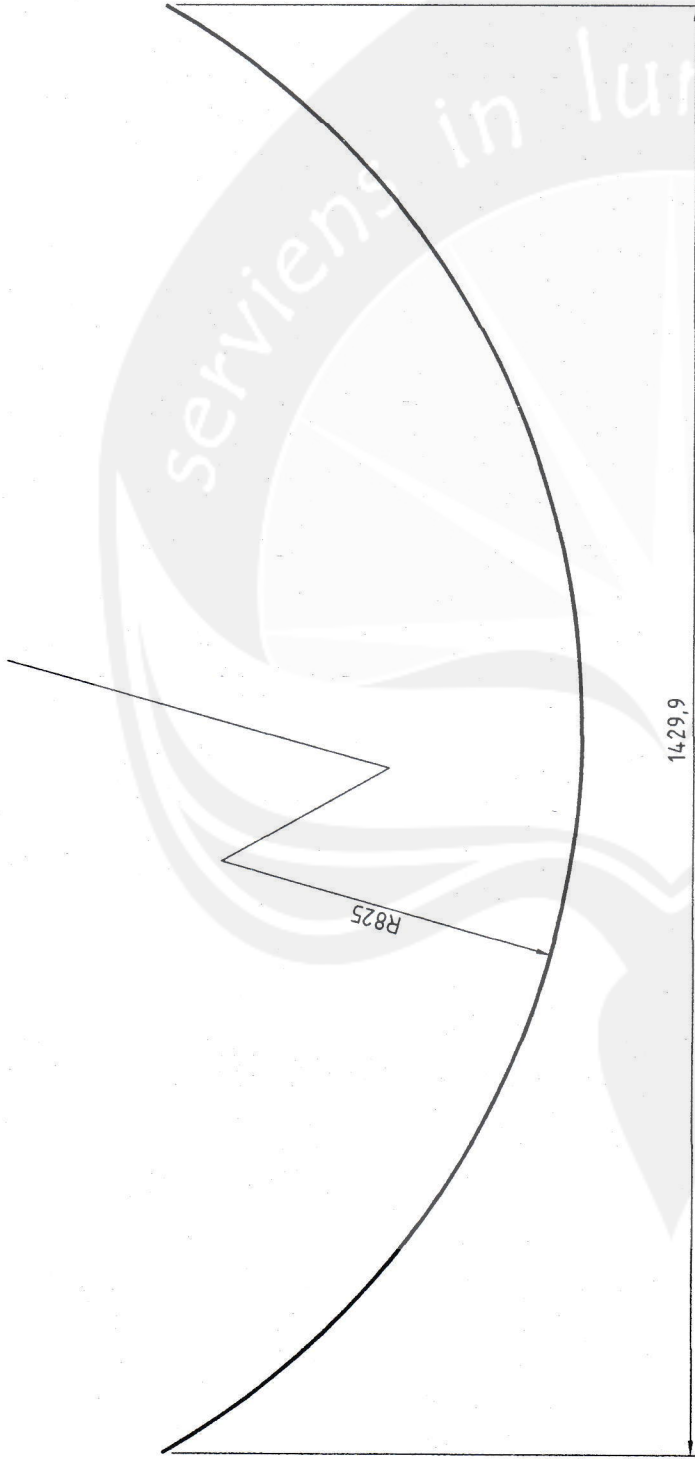

1	Base	1.10.4	St.St. sheet 1,0	-
Qty	Description	Item	Material	
0,5	+6			
6	+30			
	100			
	400			
	1000			
	2000			
Tol. ±	0,1	0,2	0,3	0,5
	0,8	1,2		
0,5	+120			
6	+400			
	1000			
	2000			
0,1	+50			
1*	+120			
30*	400			
10*	100			
17	20*			
	0,6			
	0,3			
Title Base				
Detail of: Mesin Penyaring Bubur Kedelai				
Univ. ATMA JAYA YOGYAKARTA				

Dwn. 27.05.15 Felix Scale 1:5 Hard. HRC Item 1

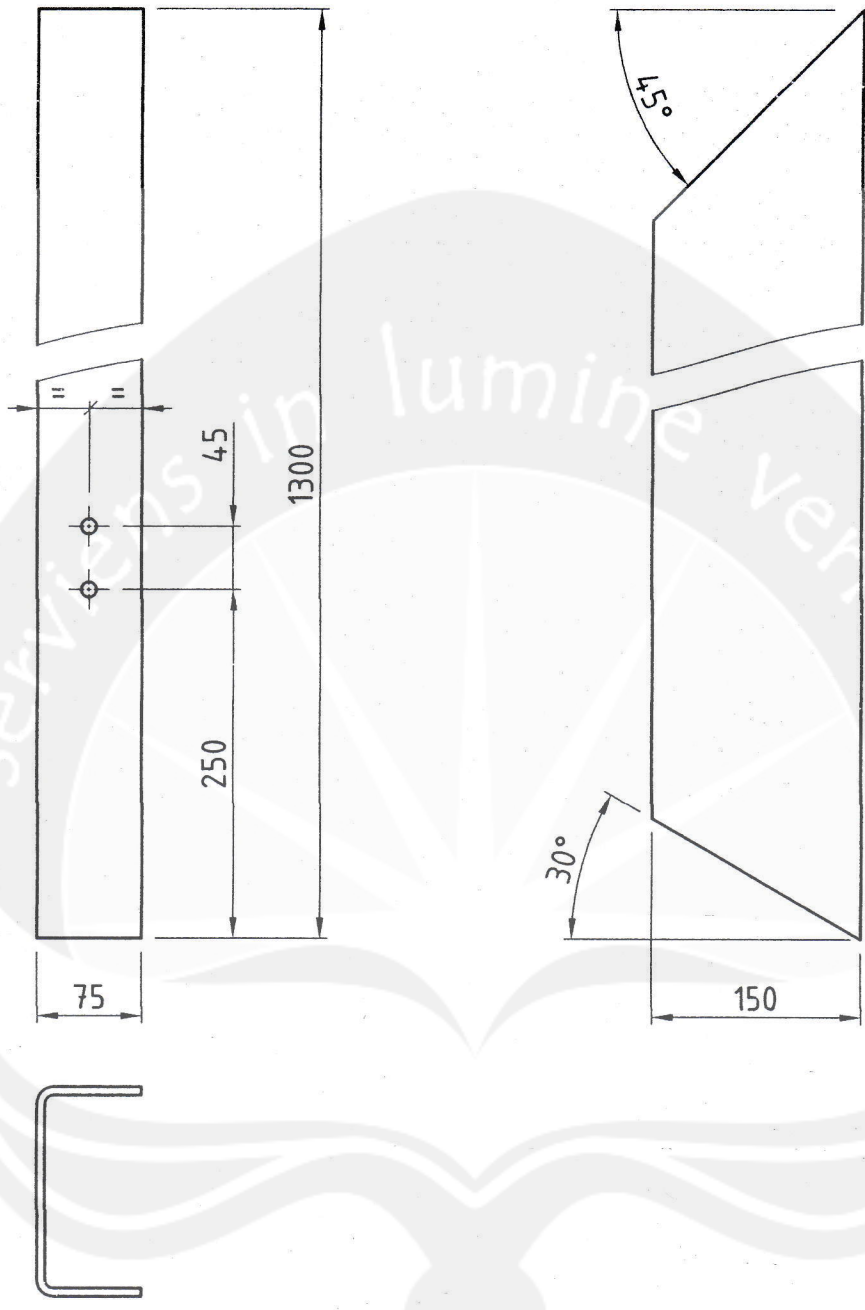

1L/1R		Horizontal					1.11	C profile 150x75		-	
Qty		Description					Item	Material			
Nom.	0.5 6	>6 30	>30 120	>120 400	>400 1000	>1000 2000	Dwn. 28.05.15	Felix	Scale	Hard. HRC	Item
Tol. ±	0.1	0.2	0.3	0.5	0.8	1.2			1:5		1
Nom.	-10	>10 50	>50 120	>120 400							
Deg. ±	1°	30'	20'	10'							
1/100 ±	1.7	0.9	0.6	0.3							
							Title				
							Horizontal				
							Detail of: Mesin Penyaring Bubur Kedelai				
							Univ. ATMA JAYA YOGYAKARTA				

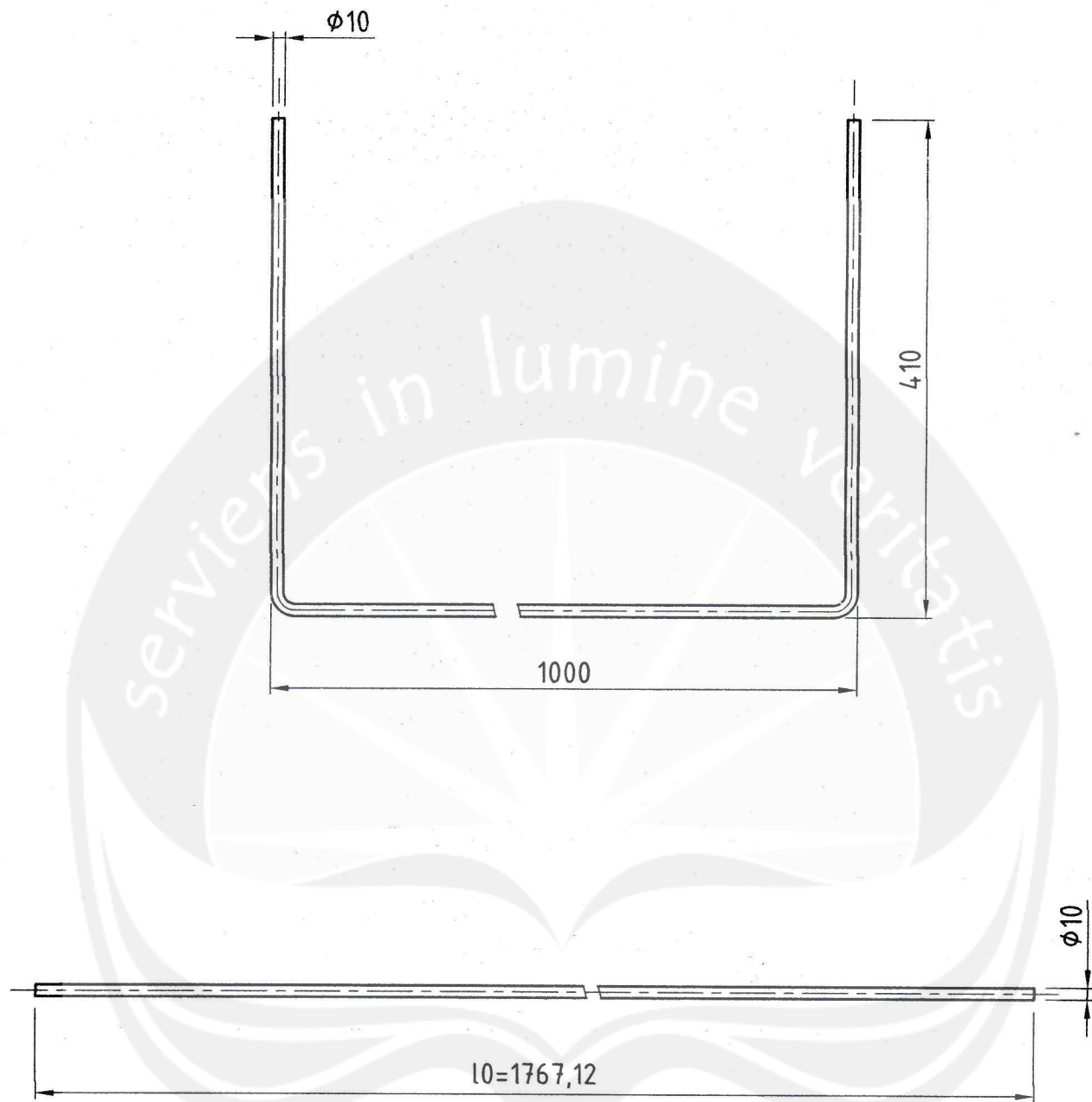

1		Guide Outlet 1					1.12	St.St. Ø10		-	
Qty		Description					Item	Material			
Nom.	0.5 6	>6 30	>30 120	>120 400	>400 1000	>1000 2000	Dwn. 22.05.15	Felix	Scale	Hard. HRC	Item
Tol. ±	0.1	0.2	0.3	0.5	0.8	1.2		1:5			1
Nom.	<10	>10 50	>50 120	>120 400							
Deg. ±	1°	30'	20'	10'							
1/100 ±	1.7	0.9	0.6	0.3							
							Title				
							Guide Outlet 1				
							Detail of: Mesin Penyaring Bubur Kedelai				
							Univ. ATMA JAYA YOGYAKARTA				

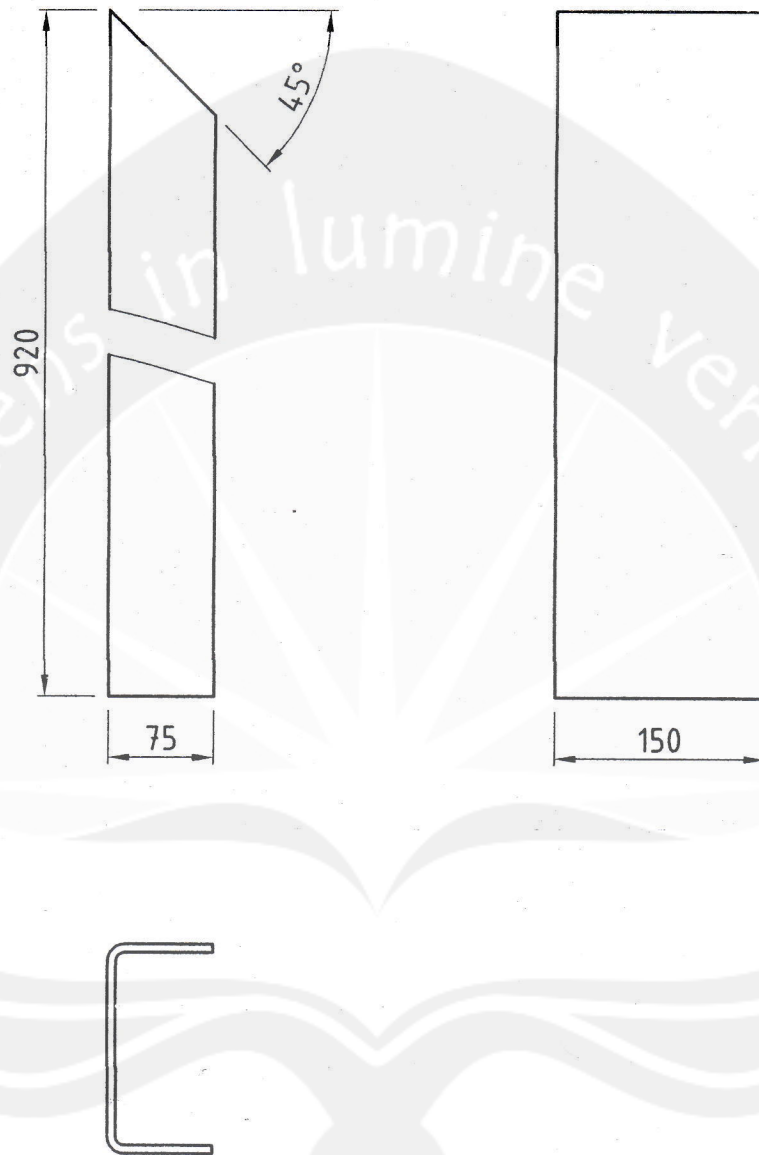

1		Stand Motor					1.13	C profile 150x75		-	
Qty		Description					Item	Material			
Nom.	0.5 6	>6 30	>30 120	>120 400	>400 1000	>1000 2000	Dwn. 28.05.15	Felix	Scale	Hard. HRc	Item
Tol. ±	0.1	0.2	0.3	0.5	0.8	1.2		1:5			1
Nom.	-10	>10 50	>50 120	>120 400			Title		Stand Motor		
Deg. ±	1°	30'	20'	10'			Detail of:		Mesin Penyaring Bubur Kedelai		
1/100 ±	1.7	0.9	0.6	0.3					Univ. ATMA JAYA YOGYAKARTA		

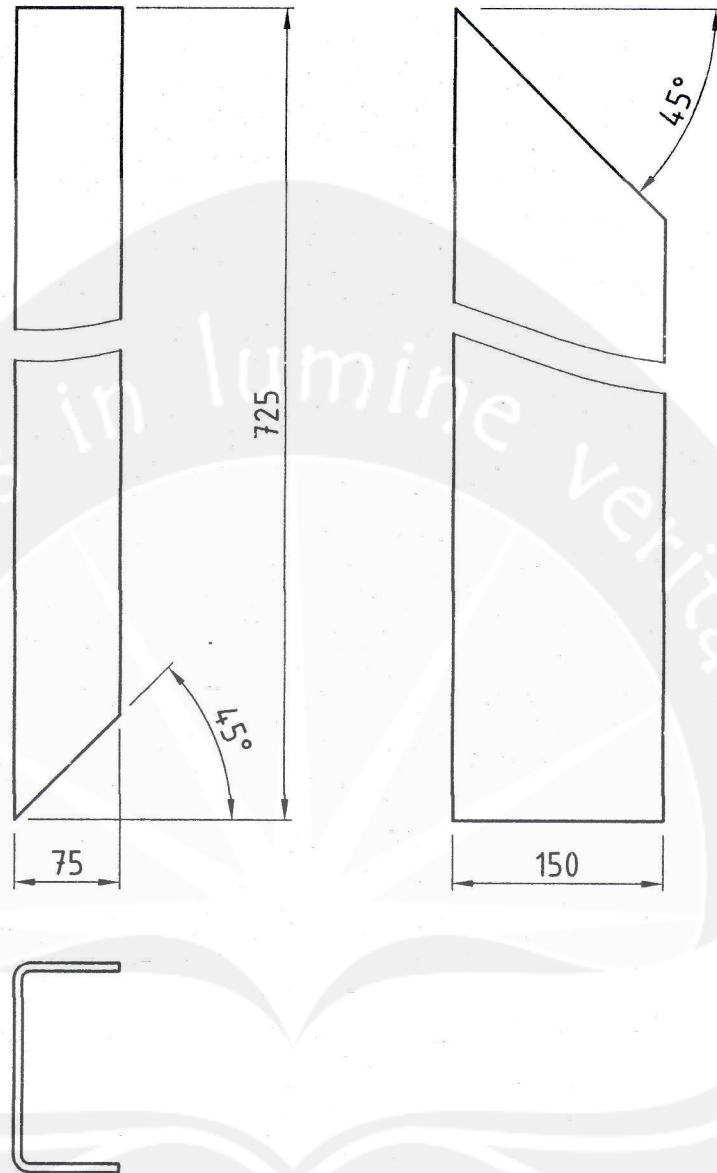

1		Base Motor 2					1.14	C profile 150x75		-	
Qty		Description					Item	Material			
Nom.	0.5 6	>6 30	>30 120	>120 400	>400 1000	>1000 2000	Dwn. 28.05.15	Felix	Scale	Hard. HRc	Item
Tol. ±	0.1	0.2	0.3	0.5	0.8	1.2			1:5		1
Nom.	<10	>10 50	>50 120	>120 400			Title		Base Motor 2		
Deg. ±	1°	30'	20'	10'			Detail of:		Mesin Penyaring Bubur Kedelai		
100 ±	1.7	0.9	0.6	0.3					Univ. ATMA JAYA YOGYAKARTA		

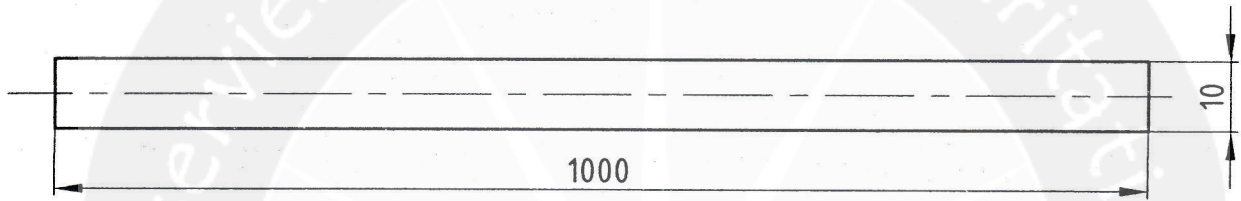

1		Guide Outlet 2					1.15	St.St. pipe ϕ 10	-		
Qty		Description					Item	Material			
Nom.	0.5 6	>6 30	>30 120	>120 400	>400 1000	>1000 2000	Dwn. 28.05.15	Felix	Scale	Hard. HRc	Item
Tol. \pm	0.1	0.2	0.3	0.5	0.8	1.2		1:1		1	
Nom.	-10	>10 50	>50 120	>120 400			Title Guide Outlet 2				
Deg. \pm 100 \pm	1° 1.7	30° 0.9	20° 0.6	10° 0.3							
							Detail of: Mesin Penyaring Bubur Kedelai				
							Univ. ATMA JAYA YOGYAKARTA				

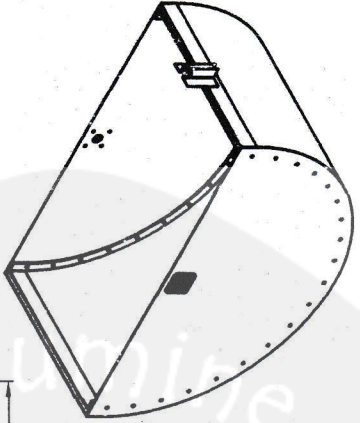
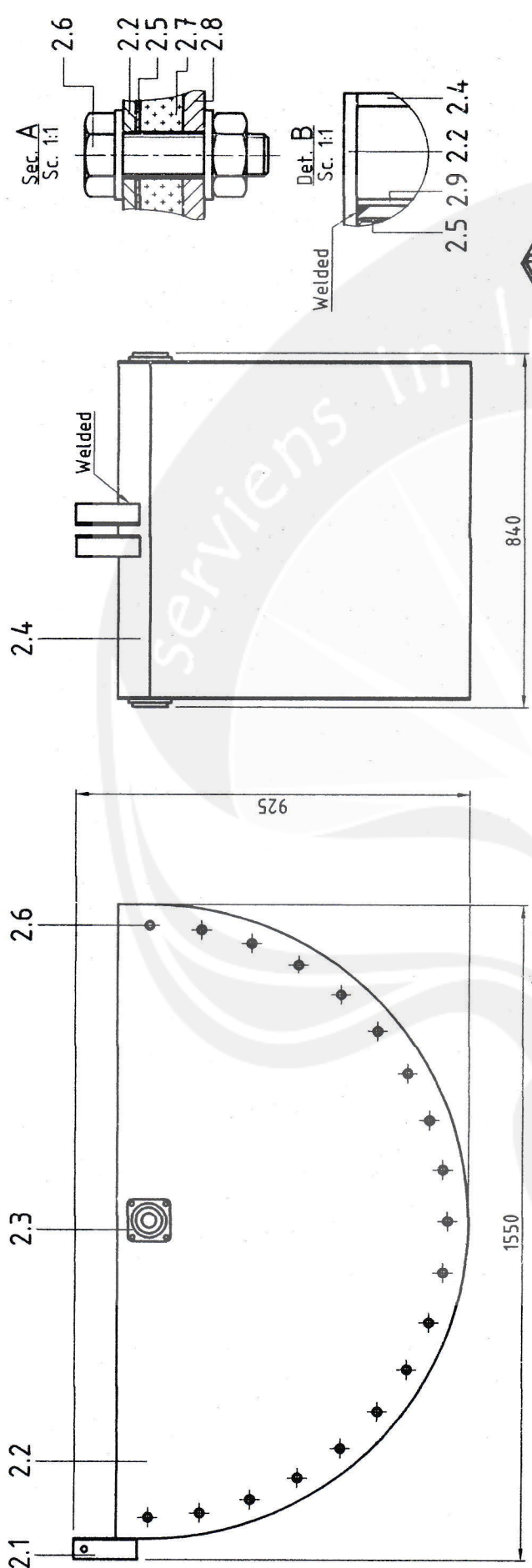

2	Housing With Bearing	2.3	-	Purchased	
2	Wall	2.2	St.St. sheet 3,0	-	
1L/1R	Guide	2.1	L profile	-	
Qty	Description	Item	Material		
Num.	+6	+30	+120	+400	+1000
6	30	120	400	1000	2000
Tol. ±	0.1	0.2	0.3	0.5	0.8
					1.2
Num.	+10	+50	+100	+200	400
10	50	100	200	400	800
Arg. ±	1°	30'	70'	90'	
	± 1.7	0.9	0.6	0.3	
		Dwn.	30.05.15	Felix	Scale
					1:10
		Title		Hard. Hrc	Item
		Bowl			2
Detail of: Mesin Penyaring Bubur Kedelai					

1	Mesh	2.9	St.St. Mesh	-
2	Clamp	2.8	St.St. sheet 3,0	-
2	Side Rubber	2.7	-	Purchased
38	Bolt+nut+ring M10	2.6	-	Purchased
1	Wire mesh	2.5	-	Purchased
1	Base	2.4	St.St. sheet 3,0	-

Univ. ATMA JAYA YOGYAKARTA

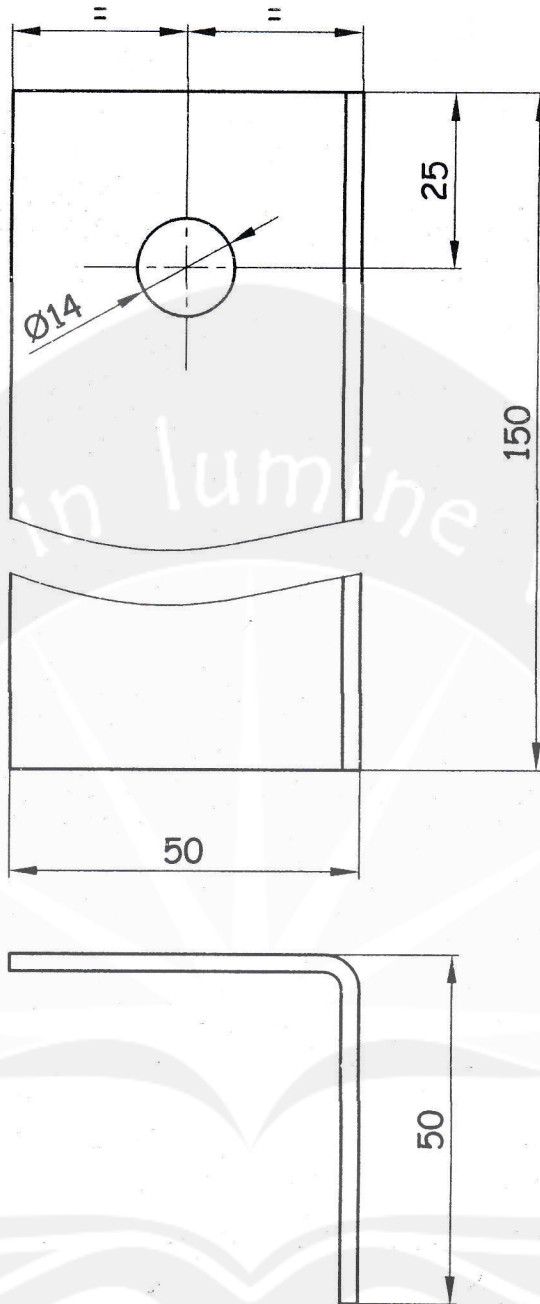

1L/1R	Guide						2.1	L Profile			
Qty	Description						Item	Material			
Nom.	0.5 6	>6 30	>30 120	>120 400	>400 1000	>1000 2000	Dwn. 30.05.15	Felix	Scale	Hard. HRc	Item
Tol. ±	0.1	0.2	0.3	0.5	0.8	1.2		1:1			2
Nom.	<10	>10 50	>50 120	>120 400							
Deg. ±	1°	30'	20'	10'							
100 ±	1.7	0.9	0.6	0.3							
							Title				
							Guide				
							Detail of: Mesin Penyaring Bubur Kedelai				
							Univ. ATMA JAYA YOGYAKARTA				

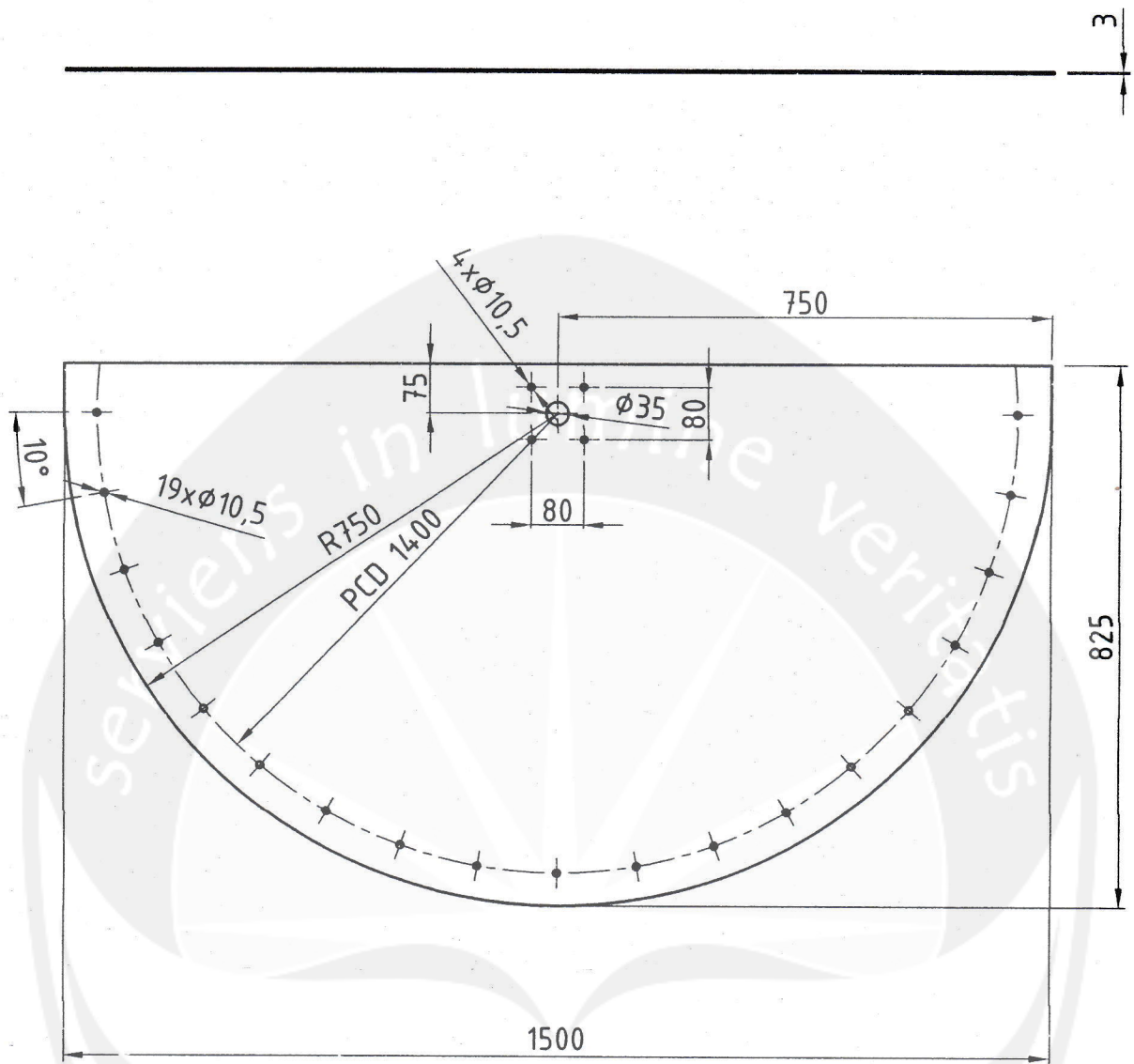

2		Wall					2.2	St.St. Sheet 3,0	-		
Qty		Description					Item	Material			
Nom.	0.5 6	>6 30	>30 120	>120 400	>400 1000	>1000 2000	Dwn. 30.05.15	Felix	Scale	Hard. HRc	Item
Tol. ±	0.1	0.2	0.3	0.5	0.8	1.2		1:10			2
Nom.	<10	>10 50	>50 120	>120 400			Title		Wall		
Dev. ±	1*	30'	20'	10'			Detail of: Mesin Penyaring Bubur Kedelai				
100 ±	1.7	0.9	0.6	0.3			Univ. ATMA JAYA YOGYAKARTA				

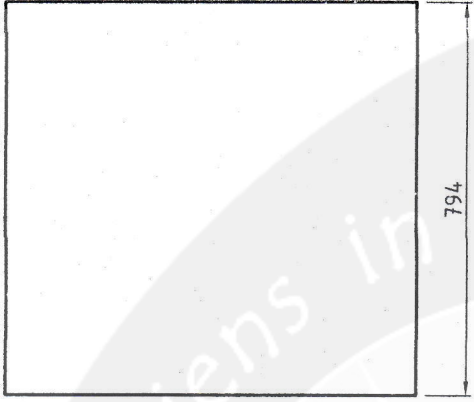
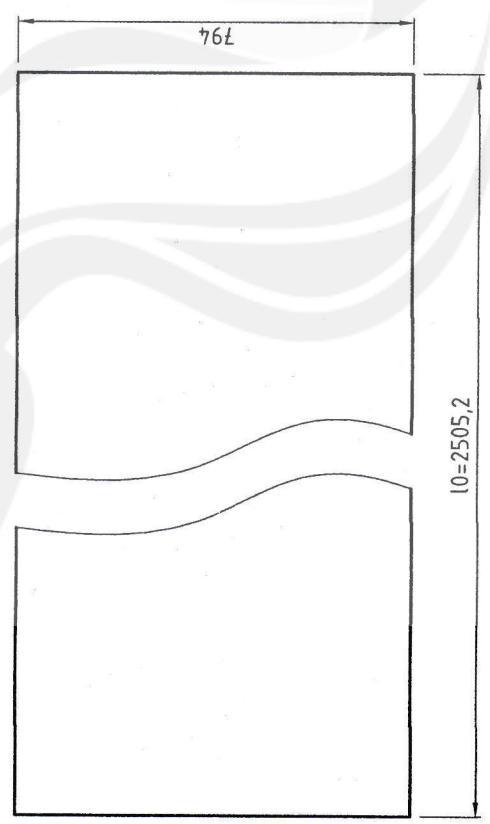
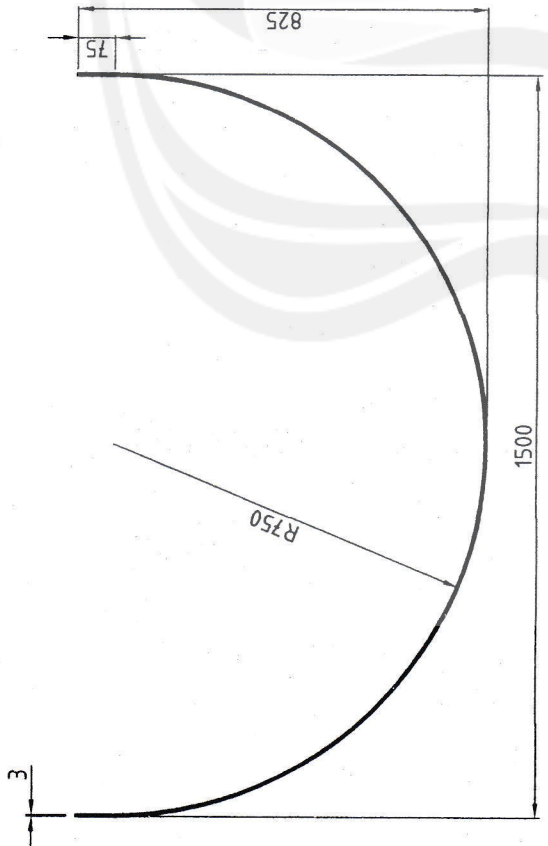

1	Qty	Base	2.4	St.St. Sheet 3,0	Material	Scale	Hard. HRC	Item
						1:10		2
Nom.		+6	+30	+100	+500			
Tol.		6	30	100	400			
Nom.		0.5	1.5	5	15			
Tol.		± 0.1	± 0.2	± 0.3	± 0.5			
Nom.		10	30	100	400			
Tol.		± 1*	± 3*	± 10*	± 30*			
Nom.		1.3	0.9	0.6	0.3			
Tol.								
Title: Base								
Detail of: Mesin Penyaring Bubur Kedelai								
Univ. ATMA JAYA YOGYAKARTA								

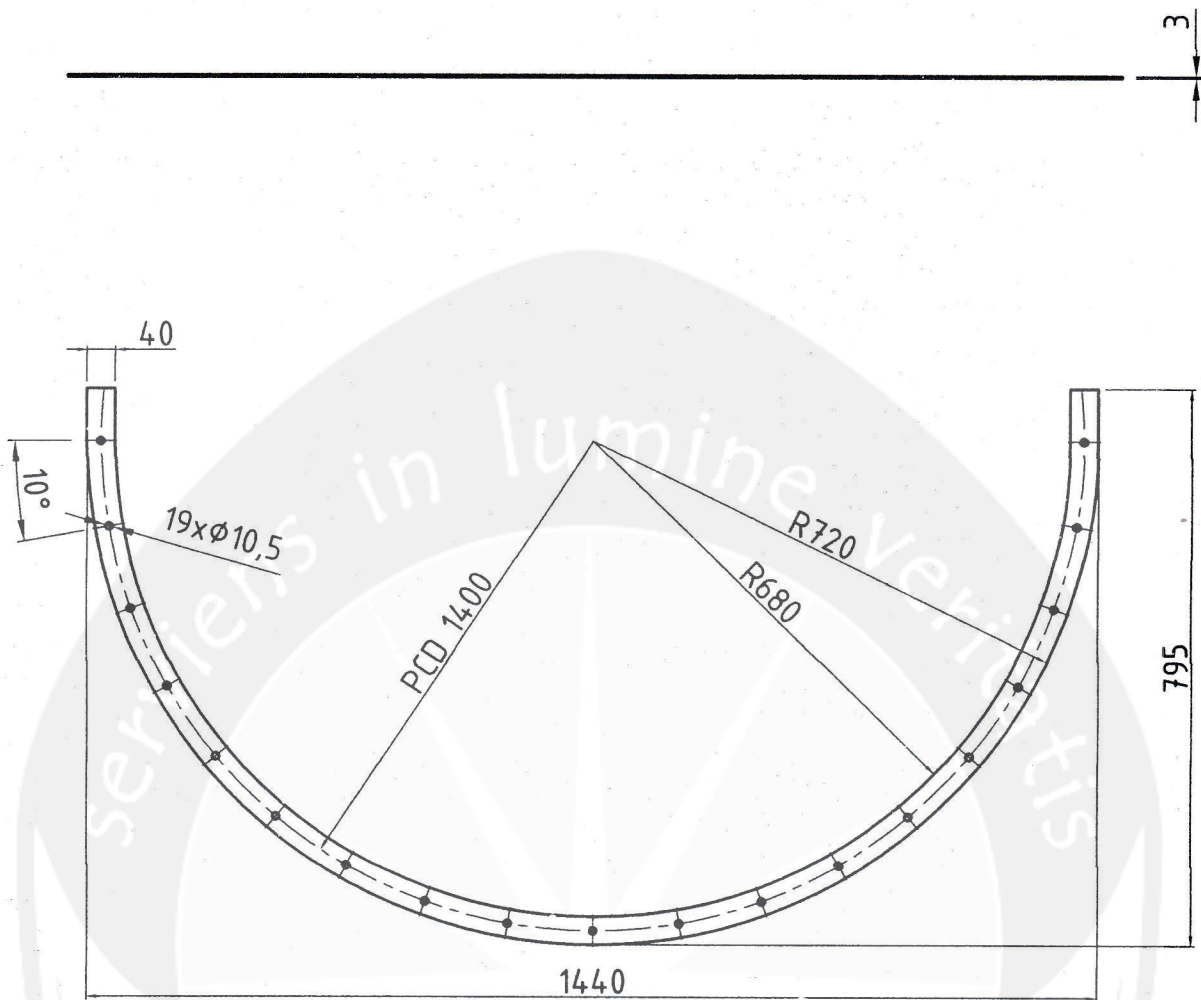

2		Clamp				2.8	St.St. Sheet 3,0	-	
Qty		Description				Item	Material		
Nom.	0.5 6	>6 30	>30 120	>120 400	>400 1000	>1000 2000	Dwn. 30.05.15	Felix	Scale
Tol. ±	0.1	0.2	0.3	0.5	0.8	1.2		1:10	Hard. HRc
Nom.	-10	>10 50	>50 120	>120 400					Item
Deg. ±	1'	30'	20'	10'					2
100 ±	1.7	0.9	0.6	0.3					
							Title		
							Clamp		
							Detail of: Mesin Penyaring Bubur Kedelai		
							Univ. ATMA JAYA YOGYAKARTA		

15

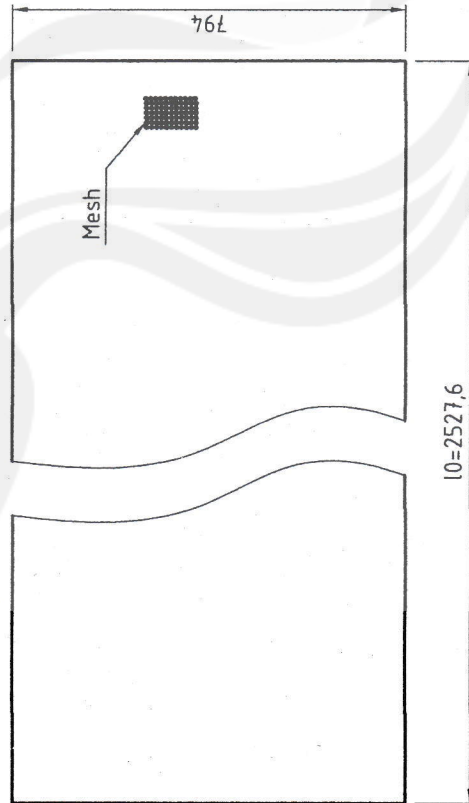
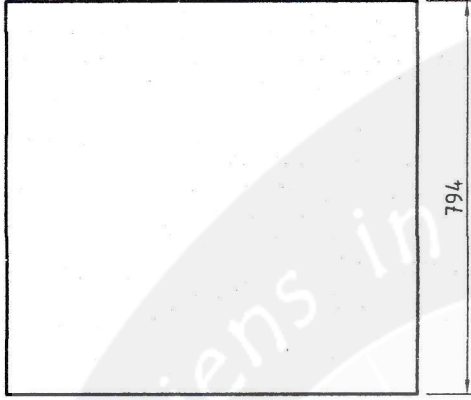
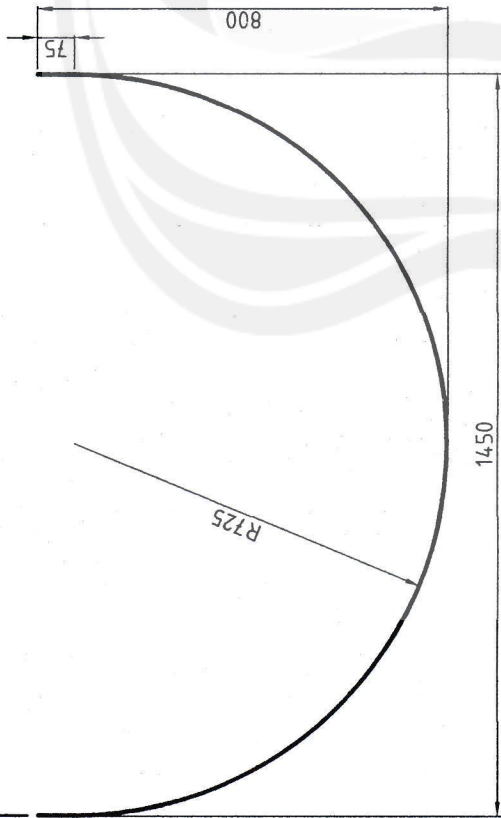

1		2.9		St.St. Mesh	
Qty	Description	Item	Material	Scale	Item
		Dwn.	Felix	1:10	2
Title					
Detail of: Mesin Penyaring Bubur Kedelai					
Univ. ATMA JAYA YOGYAKARTA					

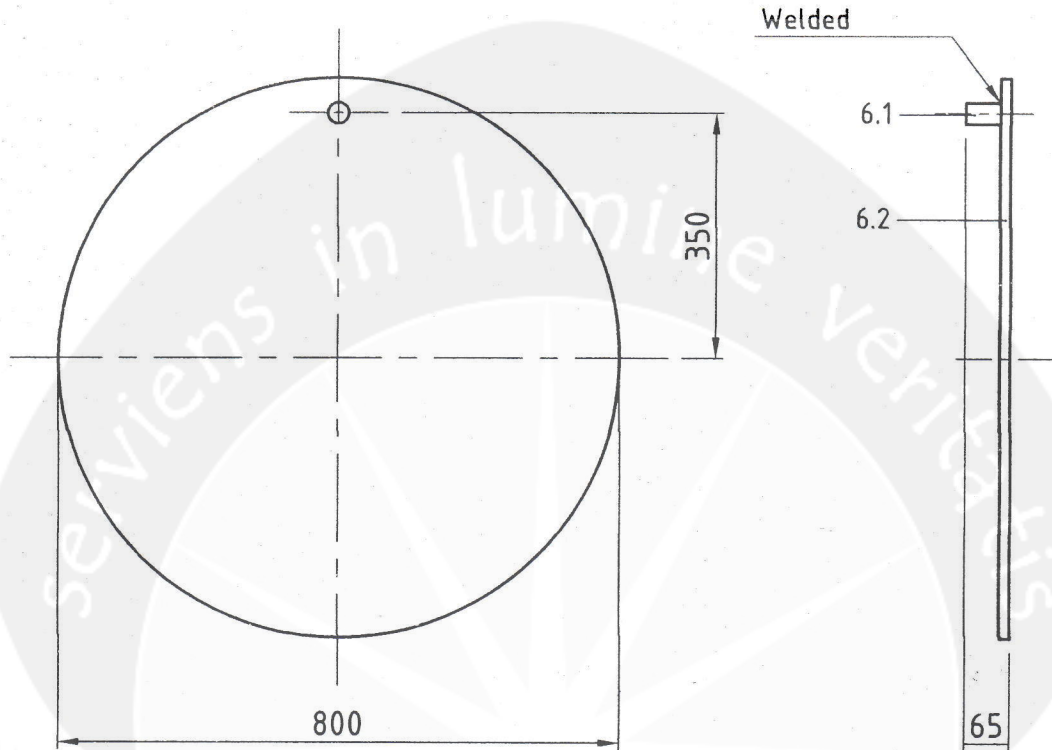

1	Disc	6.2	MS	-
1	Pinion	6.1	MS	-

Qty	Description	Item	Material	
-----	-------------	------	----------	--

Nom.	0.5 6	>6 30	>30 120	>120 400	>400 1000	>1000 2000	Dwn. 30.05.15 Felix	Scale	Hard. HRc	Item
Tol. ±	0.1	0.2	0.3	0.5	0.8	1.2		1:10		6
Nom.	<10	>10 50	>50 120	>120 400			Title Disc			
Deg. ±	1°	30'	20'	10'	Detail of: Mesin Penyaring Bubur Kedelai					
100 ±	1.7	0.9	0.6	0.3	Univ. ATMA JAYA YOGYAKARTA					

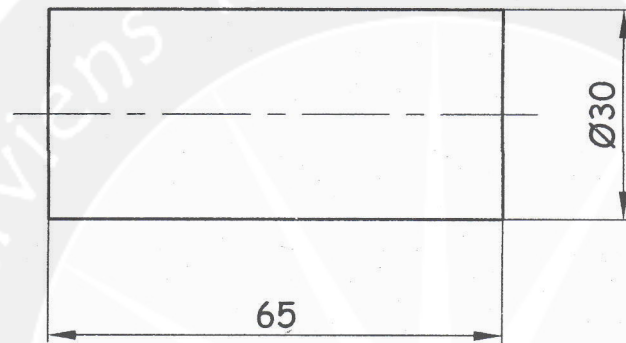
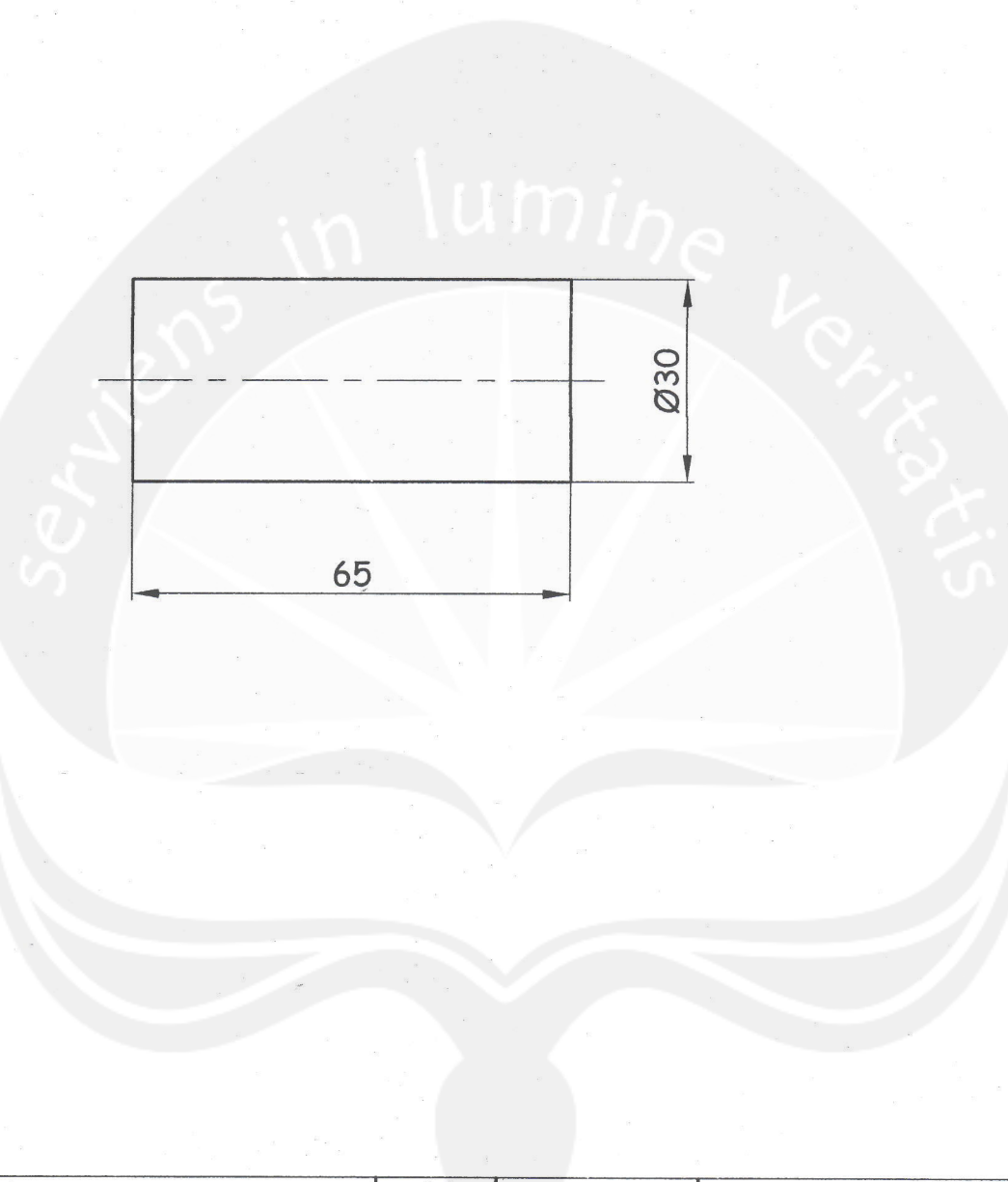

1	Pinion						6.1	MS		
Qty	Description						Item	Material		
Nom.	0.5 6	>6 30	>30 120	>120 400	>400 1000	>1000 2000	Dwn. 30.05.15 Felix	Scale	Hard. HRc	Item
Tol. ±	0.1	0.2	0.3	0.5	0.8	1.2		1:1		6
Nom.	-10	>10 50	>50 120	>120 400			Title Pinion			
Deg. ±	±	30'	20'	10'						
100 ±	1.7	0.9	0.6	0.3	Detail of: Mesin Penyaring Bubur Kedelai					
Univ. ATMA JAYA YOGYAKARTA										

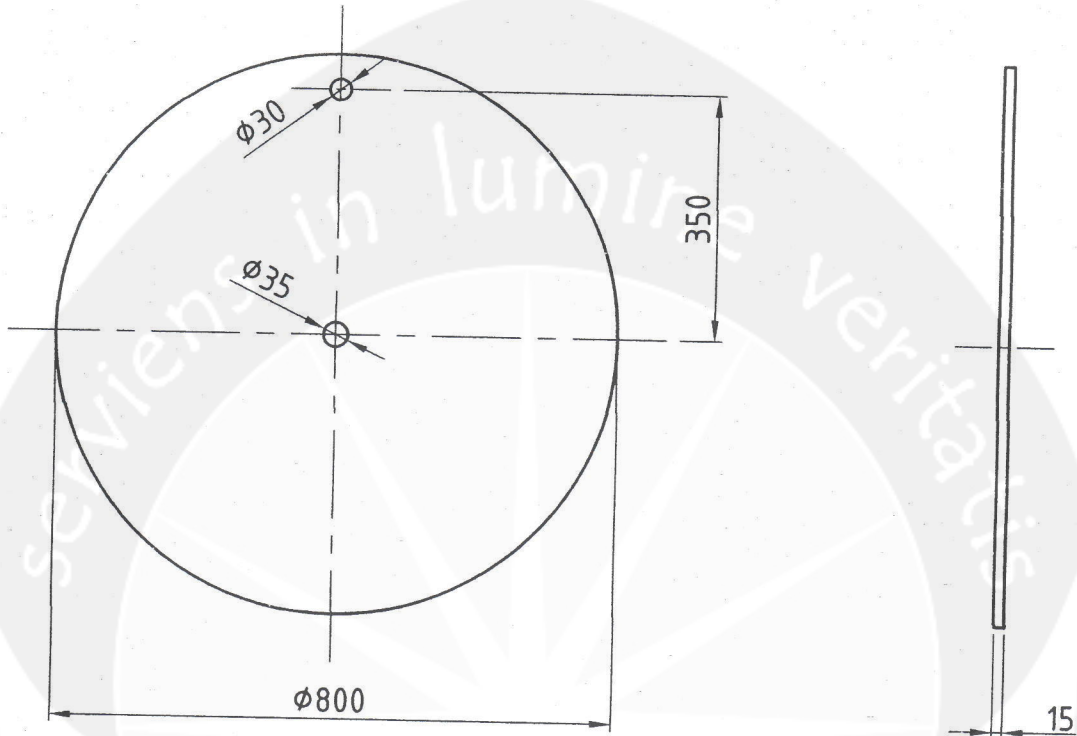

1		Disc					6.2	MS		
Qty		Description					Item	Material		
Nom.	0.5 6	>6 30	>30 120	>120 400	>400 1000	>1000 2000	Dwn. 30.05.15 Felix	Scale	Hard. HRc	Item
Tol. ±	0.1	0.2	0.3	0.5	0.8	1.2		1:10		6
Nom.	<10	>10 50	>50 120	>120 400			Title Disc			
Deg. ±	1°	30'	20'	10'						
1/100 ±	1.7	0.9	0.6	0.3			Detail of: Mesin Penyaring Bubur Kedelai			
							Univ. ATMA JAYA YOGYAKARTA			

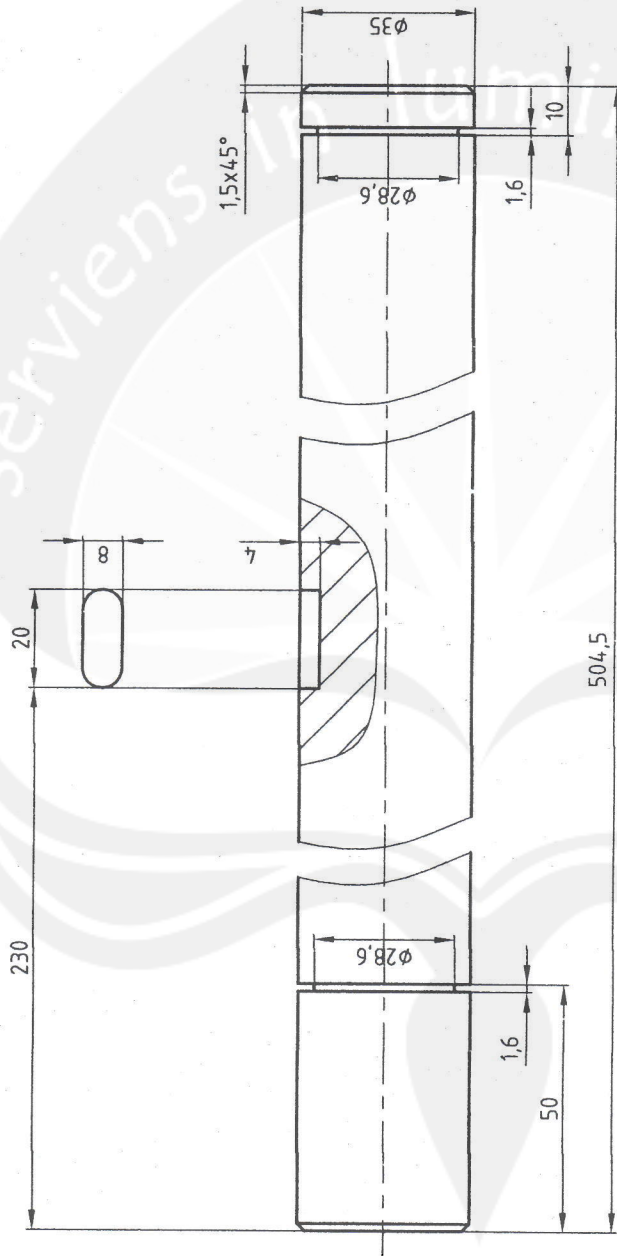

1	Qty	Shaft for Disc		7	MS		
		Description		Item	Material		
		Dwn. 30.05.15		Felix	Scale		
					1:1		
					Hard. HRC	7	
					Title		
					Shaft for Disc		
					Detail of: Mesin Penyaring Bubur Kedelai		
					Univ. ATMA JAYA YOGYAKARTA		

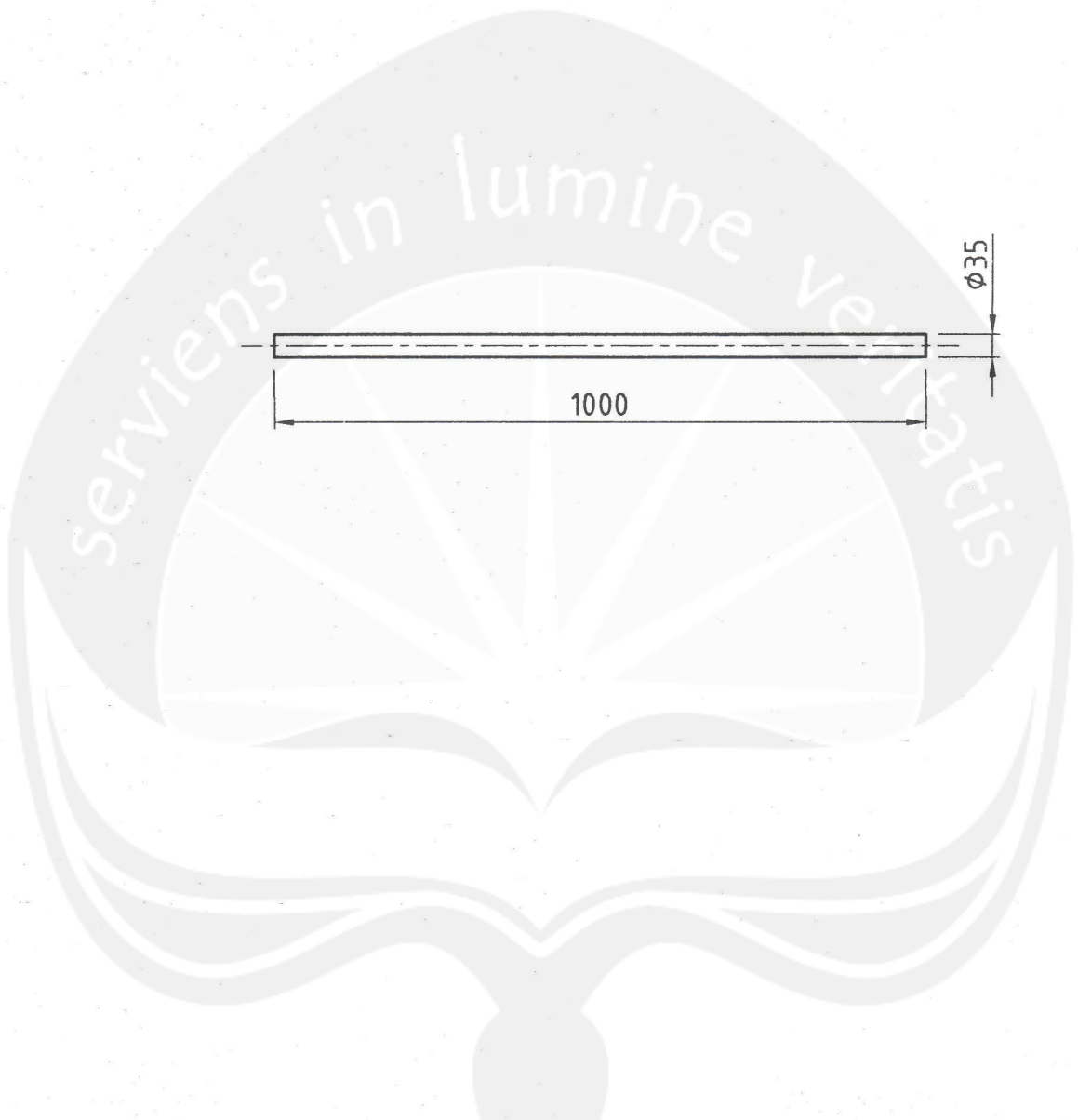

1		Main Shaft					8	MS	-		
Qty		Description					Item	Material			
Nom.	0.5 6	>6 30	>30 120	>120 400	>400 1000	>1000 2000	Dwn. 30.05.15	Felix	Scale	Hard. HRc	Item
Tol. ±	0.1	0.2	0.3	0.5	0.8	1.2		1:10		8	
Nom.	<10	>10 50	>50 120	>120 400			Title Main Shaft				
Deg. ±	1°	30'	20'	10'							
100 ±	1.7	0.9	0.6	0.3	Detail of: Mesin Penyaring Bubur Kedelai						
							Univ. ATMA JAYA YOGYAKARTA				